

Ordinance amending the Unified Development Code (“UDC”), upon initiation by the City of Corpus Christi, Texas, by changing the UDC Zoning Map in reference an approximately 82-acre tract of land out of Lots 3 and 4, Section 12, and Lot 1, Section 18, Bohemian Colony Lands, from the “RS-6” Single-Family 6 District to the “CC” Commercial Compatible District; amending the Comprehensive Plan to account for any deviations; and providing for a repealer clause and publication.

WHEREAS, the Planning Commission has forwarded to the City Council its final report and recommendation regarding an amendment to the City of Corpus Christi’s Unified Development Code (“UDC”) and corresponding UDC Zoning Map;

WHEREAS, with proper notice to the public, public hearings were held on Wednesday, September 25, 2013, during a meeting of the Planning Commission, and on Tuesday, November 12, 2013, during a meeting of the City Council, during which all interested persons were allowed to appear and be heard; and

WHEREAS, the City Council has determined that this amendment would best serve the public health, necessity, convenience and general welfare of the City of Corpus Christi and its citizens.

BE IT ORDAINED BY THE CITY COUNCIL OF THE CITY OF CORPUS CHRISTI, TEXAS:

SECTION 1. Upon initiation by the City of Corpus Christi, Texas (“City”), the Unified Development Code (“UDC”) of the City, is amended by changing the zoning on an approximately 82-acre tract of land out of Lots 3 and 4, Section 12, and Lot 1, Section 18, Bohemian Colony Lands (the “Property”), located on the south side of Weber Road and on the east and west sides of Yorktown Boulevard, from the “RS-6” Single-Family 6 District to the “CC” Commercial Compatible District (Zoning Map Nos. 047034, 048034, 047033), as shown in Exhibit “A.” Exhibit A, which is a location map pertaining to the Property, is attached to and incorporated in this ordinance by reference as if fully set out herein in its entirety.

SECTION 2. The official UDC Zoning Map of the City is amended to reflect changes made to the UDC by Section 1 of this ordinance.

SECTION 3. The UDC and corresponding UDC Zoning Map of the City, made effective July 1, 2011, and as amended from time to time, except as changed by this ordinance, both remain in full force and effect.

SECTION 4. To the extent this amendment to the UDC represents a deviation from the City’s Comprehensive Plan, the Comprehensive Plan is amended to conform to the UDC, as it is amended by this ordinance.

SECTION 5. All ordinances or parts of ordinances specifically pertaining to the zoning of the Property and that are in conflict with this ordinance are hereby expressly repealed.

SECTION 6. Publication shall be made in the official publication of the City as required by the City Charter of the City.

The foregoing ordinance was read for the first time and passed to its second reading on this the _____ day of _____, 20____, by the following vote:

Nelda Martinez	_____	Chad Magill	_____
Kelley Allen	_____	Colleen McIntyre	_____
Rudy Garza	_____	Lillian Riojas	_____
Priscilla Leal	_____	Mark Scott	_____
David Loeb	_____		

The foregoing ordinance was read for the second time and passed finally on this the _____ day of _____, 20____, by the following vote:

Nelda Martinez	_____	Chad Magill	_____
Kelley Allen	_____	Colleen McIntyre	_____
Rudy Garza	_____	Lillian Riojas	_____
Priscilla Leal	_____	Mark Scott	_____
David Loeb	_____		

PASSED AND APPROVED this the _____ day of _____, 20____

ATTEST:

City Secretary

Nelda Martinez
Mayor

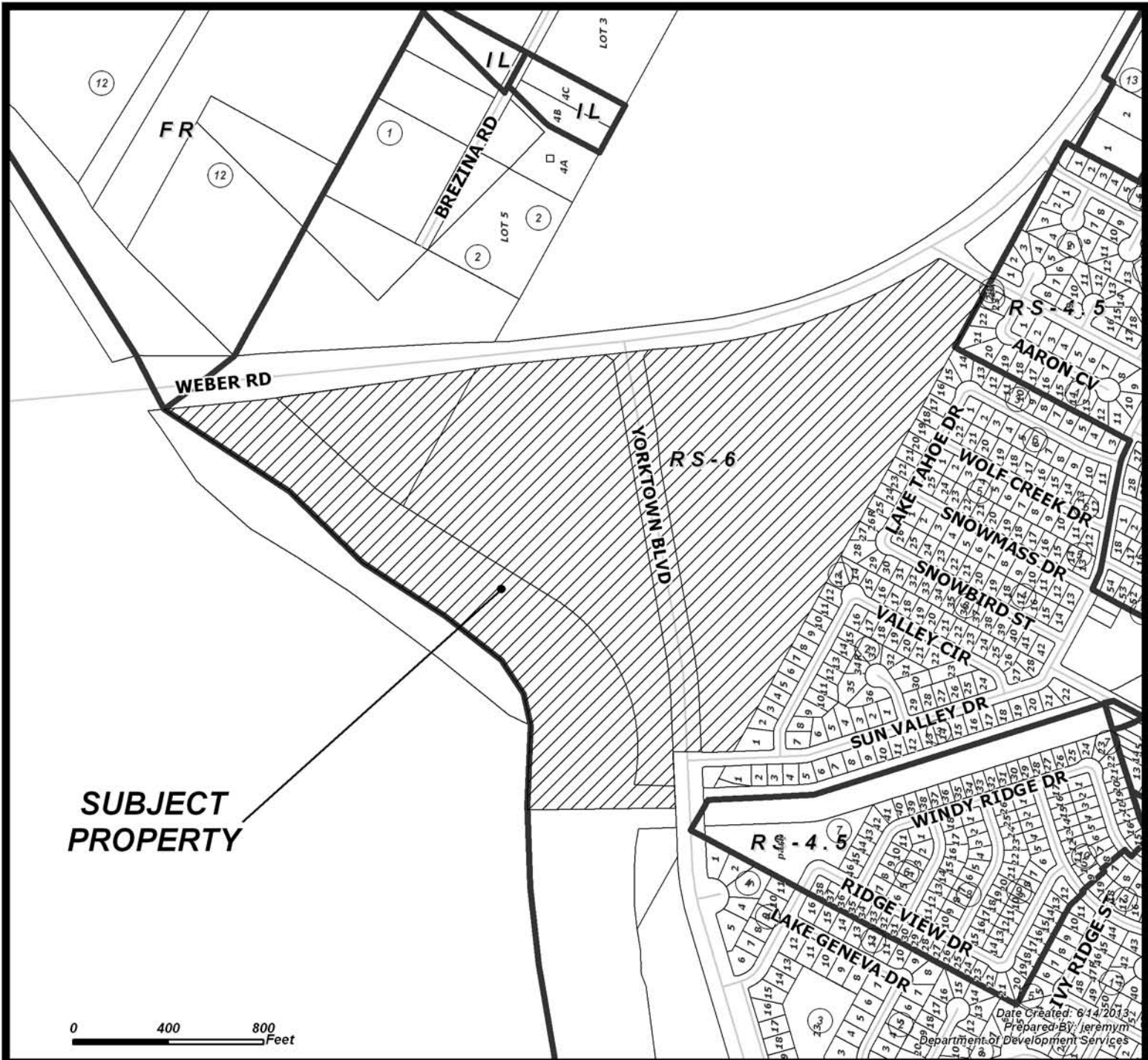

**SUBJECT
PROPERTY**

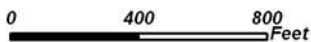

Date Created: 6/14/2013
Prepared By: Jeremym
Department of Development Services

CASE: 0713-02
SUBJECT PROPERTY WITH ZONING

 Subject Property

RM-1 Multifamily 1	IL Light Industrial
RM-2 Multifamily 2	IH Heavy Industrial
RM-3 Multifamily 3	PUD Planned Unit Dev. Overlay
ON Professional Office	RS-10 Single-Family 10
RM-AT Multifamily AT	RS-6 Single-Family 6
CN-1 Neighborhood Commercial	RS-4.5 Single-Family 4.5
CN-2 Neighborhood Commercial	RS-TF Two-Family
CR-1 Resort Commercial	RS-15 Single-Family 15
CR-2 Resort Commercial	RE Residential Estate
CG-1 General Commercial	RS-TH Townhouse
CG-2 General Commercial	SP Special Permit
CI Intensive Commercial	RV Recreational Vehicle Park
CBD Downtown Commercial	RMH Manufactured Home
CR-3 Resort Commercial	
FR Farm Rural	
H Historic Overlay	
BP Business Park	

