

STATE OF TEXAS §
 COUNTY OF NUECES §
 WE, ENVIROTECH CARRIERS INC., LP. HEREBY CERTIFY THAT WE ARE THE OWNERS OF THE LAND EMBRACED WITHIN THE BOUNDARIES OF THE FOREGOING PLAT, SUBJECT TO A LIEN IN FAVOR OF _____ THAT WE HAVE HAD SAID LAND SURVEYED AND SUBDIVIDED AS SHOWN, THAT STREETS AND EASEMENTS AS SHOWN HAVE BEEN HERETOFORE DEDICATED, OR IF NOT PREVIOUSLY DEDICATED, ARE HEREBY DEDICATED TO THE PUBLIC USE FOREVER, AND THAT THIS PLAT WAS MADE FOR THE PURPOSES OF DESCRIPTION AND DEDICATION.

THIS THE _____ DAY OF _____, 20____.
 BY: _____
 TITLE: _____

STATE OF TEXAS §
 COUNTY OF NUECES §
 THIS INSTRUMENT WAS ACKNOWLEDGED BEFORE ME _____
 THIS THE _____ DAY OF _____, 20____.

NOTARY PUBLIC, IN AND FOR THE STATE OF TEXAS

- NOTES:
1. THE SUBJECT SITE IS IN ZONE "C", AREA OF MINIMAL FLOODING, ACCORDING TO FEMA MAP, COMMUNITY PANEL 485464 0165 C, REVISED JULY 18, 1985.
 2. THE RECEIVING WATER FOR THE STORM WATER RUNOFF FROM THIS PROPERTY IS THE OSO CREEK. THE TCEQ HAS NOT CLASSIFIED THE AQUATIC LIFE USE FOR THE OSO CREEK, BUT IT IS RECOGNIZED AS AN ENVIRONMENTALLY SENSITIVE AREA. THE OSO CREEK FLOWS DIRECTLY INTO THE OSO BAY. THE TCEQ HAS CLASSIFIED THE AQUATIC LIFE USE FOR THE OSO BAY AS "EXCEPTIONAL" AND "OYSTER WATERS" AND CATEGORIZED THE RECEIVING WATER AS "CONTACT RECREATION USE".
 3. THE BASIS OF BEARINGS IS THE EAST BOUNDARY LINE OF THE SUBJECT SITE, S1° 31' 23"E, AS SHOWN, FROM DOC# 2007011296, O.P.R.
 4. THE YARD REQUIREMENT, AS DEPICTED, IS A REQUIREMENT OF THE NEW (UDC) UNIFIED DEVELOPMENT CODE AND IS SUBJECT TO CHANGE AS THE ZONING MAY CHANGE.
 5. IF ANY LOT IS DEVELOPED WITH RESIDENTIAL USES, COMPLIANCE WITH THE PUBLIC OPEN SPACE REGULATIONS WILL BE REQUIRED DURING THE BUILDING PERMIT PHASE.
 6. SET 5/8" IRON RODS AT ALL CORNERS.
 7. ACCESS ONTO STATE HIGHWAY 44 MUST COMPLY WITH TXDOT'S TRAFFIC ACCESS MANAGEMENT PLAN REGULATIONS.
 8. MAINTENANCE OF THE PRIVATE DETENTION POND WILL BE THE RESPONSABILITY OF THE PROPERTY OWNER.

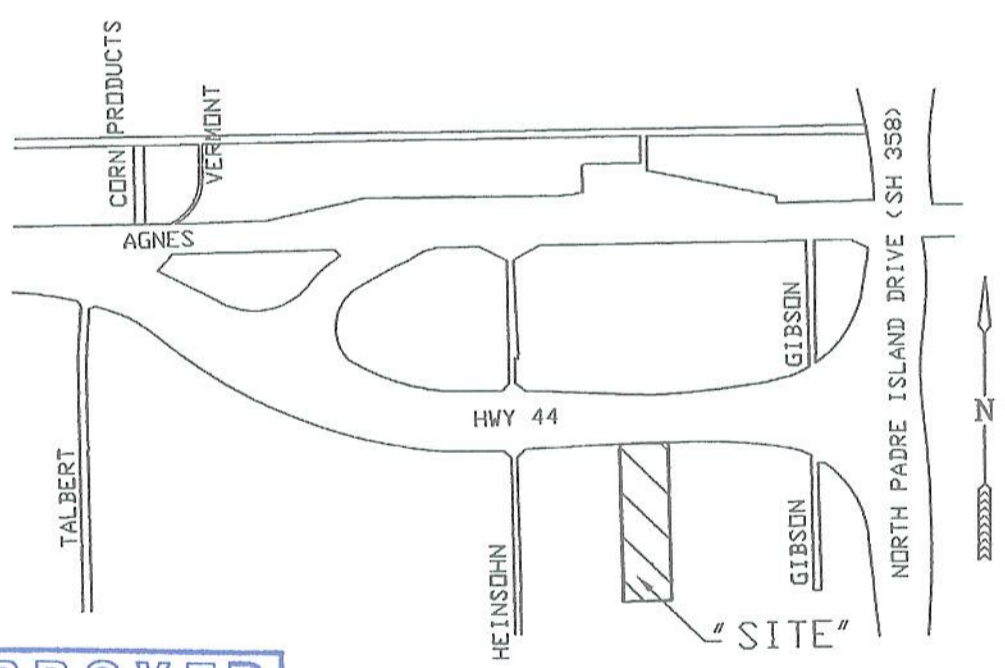

**PLAT OF
 AIRPORT INDUSTRIAL SUBDIVISION,
 BLOCK 13, LOT 2**

CORPUS CHRISTI, NUECES COUNTY, TEXAS

AN 8.354 ACRE TRACT OF LAND, MORE OR LESS, BEING A PORTION OF THE WEST ONE-HALF OF BLOCK 6, J.C. RUSSELL FARM BLOCKS, A MAP OF WHICH IS RECORDED IN VOLUME 3, PAGES 53, MAP RECORDS, NUECES COUNTY, TEXAS

BASS & WELSH ENGINEERING
 FIRM NO. F-52, 3054 S. ALAMEDA ST.
 CORPUS CHRISTI, TEXAS 78404

DATE PLOTTED: 07/19/12
 COMP. NO.: PLAT.DWG
 JOB NO.: 12048
 SCALE: 1" = 100'
 PLOT SCALE: SAME
 SHEET 1 OF 1

STATE OF TEXAS §
 COUNTY OF NUECES §
 I, NIXON M. WELSH, REGISTERED PROFESSIONAL LAND SURVEYOR OF BASS & WELSH ENGINEERING, HEREBY CERTIFY THAT THE FOREGOING PLAT WAS PREPARED FROM A SURVEY MADE ON THE GROUND UNDER MY DIRECTION, IS TRUE AND CORRECT.

NIXON M. WELSH
 REGISTERED PROFESSIONAL
 LAND SURVEYOR,
 TEXAS NUMBER 2211

STATE OF TEXAS §
 COUNTY OF NUECES §
 WE, _____ (NAME), HEREBY CERTIFY THAT WE ARE THE HOLDERS OF A LIEN ON THE LAND EMBRACED WITHIN THE BOUNDARIES OF THE FOREGOING MAP AND THAT WE APPROVE THE SUBDIVISION AND DEDICATION FOR THE PURPOSES AND CONSIDERATIONS THEREIN EXPRESSED.

BY: _____
 TITLE: _____

STATE OF TEXAS §
 COUNTY OF NUECES §
 THIS INSTRUMENT WAS ACKNOWLEDGED BEFORE ME _____
 THIS THE _____ DAY OF _____, 20____.

NOTARY PUBLIC, IN AND FOR THE STATE OF TEXAS

STATE OF TEXAS §
 COUNTY OF NUECES §
 THE FINAL PLAT OF THE HEREIN DESCRIBED PROPERTY WAS APPROVED BY THE DEPARTMENT OF DEVELOPMENT SERVICES OF THE CITY OF CORPUS CHRISTI, TEXAS

DEVELOPMENT SERVICES ENGINEER
 DATE

STATE OF TEXAS §
 COUNTY OF NUECES §
 THE FINAL PLAT OF THE HEREIN DESCRIBED PROPERTY WAS APPROVED ON BEHALF OF THE CITY OF CORPUS CHRISTI, TEXAS BY PLANNING COMMISSION.

THIS THE _____ DAY OF _____, 20____.

CHAIRMAN: RUDY GARZA
 SECRETARY: MARK E. VAN VLECK, P.E.

STATE OF TEXAS §
 COUNTY OF NUECES §

I, DIANA T. BARRERA, CLERK OF THE COUNTY COURT IN AND FOR SAID COUNTY, DO HEREBY CERTIFY THAT THE FOREGOING INSTRUMENT DATED THE _____ DAY OF _____, 20____ WITH ITS CERTIFICATE OF AUTHENTICATION, WAS FILED FOR RECORD IN MY OFFICE THE _____ DAY OF _____, 20____ AT _____ O'CLOCK _____ M., AND DULY RECORDED THE _____ DAY OF _____, 20____ AT _____ O'CLOCK _____ M. IN THE MAP RECORDS OF SAID COUNTY IN VOLUME _____, PAGE _____, INSTRUMENT NUMBER _____.

WITNESS MY HAND AND SEAL OF THE COUNTY COURT IN AND FOR SAID COUNTY AT OFFICE IN CORPUS CHRISTI, NUECES COUNTY, TEXAS, THE DAY AND YEAR LAST WRITTEN.

BY: _____ DEPUTY
 DIANA T. BARRERA, CLERK COUNTY COURT NUECES COUNTY, TEXAS

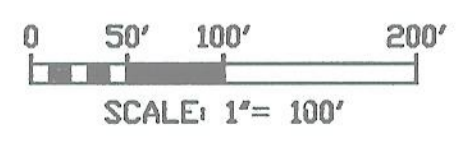

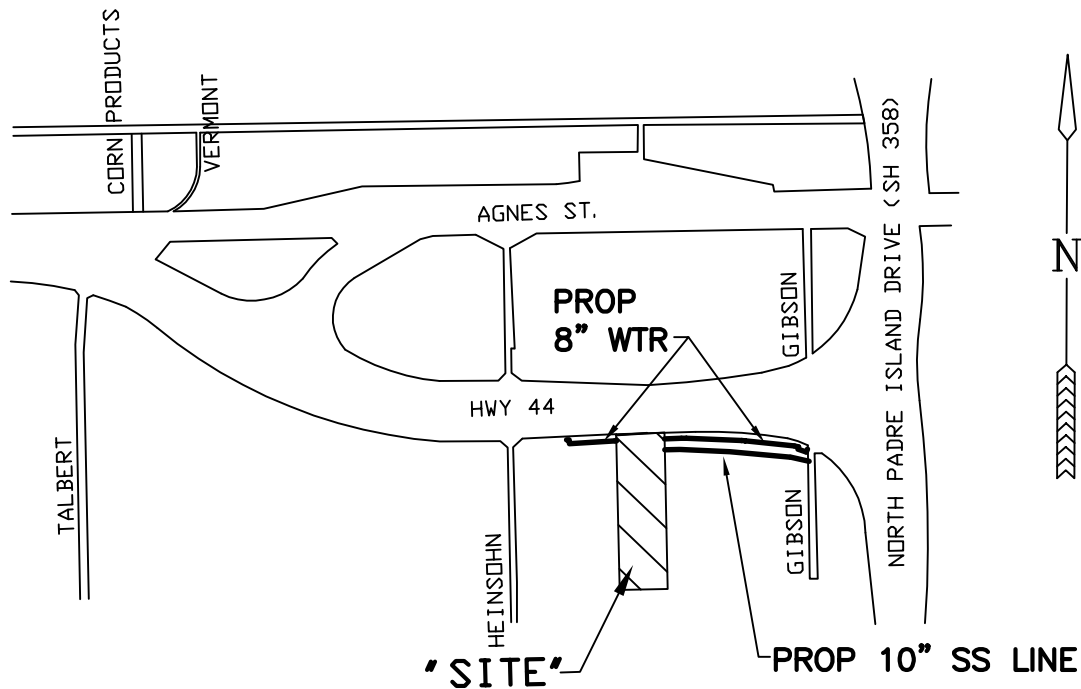

EXHIBIT SHOWING OFFSITE SANITARY SEWER
 AND WATER IMPROVEMENTS, AIRPORT
 INDUSTRIAL SUBDIVISION, BLK 13, LOT 2
 1" = 800'

BASS AND WELSH ENGINEERING
 CORPUS CHRISTI, TX
 SURVEY REG. NO. 100027-00,
 TX ENGINEERING REG. NO. F-52,
 FILE: EXB-1, JOB NO. 12048,
 SCALE: 1" = 60'
 PLOT SCALE: SAME, PLOT DATE:
 10/10/12, SHEET 1 OF 1

Exhibit C

APPLICATION FOR WASTE WATER CREDIT

We, I5T Investments, LLC, P.O. Box 261037, Corpus Christi, TX 78426, owners and developers of proposed AIRPORT INDUSTRIAL SUBDIVISION, BLOCK 13, LOT 2, hereby apply for \$12,758.80 credit towards the waste water acreage fee for the collection line Extension in conjunction with said subdivision as provided for by City Ordinance No. 17092. \$95,899.56 is the construction cost, including 11% Engineering and Surveying, as shown by the cost supporting documents attached herewith.

By: _____ Steven Jipps

Title: President

Date: January 21, 2013

THE STATE OF TEXAS §
COUNTY OF NUECES §

This instrument was acknowledged before me on January 21, 2013, by
STEVEN JIPPS (Name), President (Title), of
I5T Investments, LLC, a Texas Corporation, on behalf of the said corporation.



Katrina Marie Williams
Notary Public in and for the State of Texas

APPLICATION FOR WASTE WATER REIMBURSEMENT

We, I5T Investments, LLC, P.O. Box 261037, Corpus Christi, TX 78426, owner and developer of proposed AIRPORT INDUSTRIAL SUBDIVISION, BLOCK 13, LOT 2, hereby request reimbursement of \$63,794.00 for the installation of the waste water collection line in conjunction with said lot, as provided for by City Ordinance No. 17092. \$95,899.56 the construction cost, including 11% Engineering and Surveying, as shown by the cost supporting documents attached herewith.

By: _____ *Steven Tipps*
Title: President
Date: February 4, 2013

THE STATE OF TEXAS §
COUNTY OF NUECES §

This instrument was acknowledged before me on February 4, 2013, 2013, by
Steven Tipps (Name), President (Title), of
I5T Investments, LLC, a Texas Corporation, on behalf of the said corporation.



Katrina Marie Williams

Notary Public in and for Nueces County, Texas

CERTIFICATION

The information submitted with this application for reimbursement has been reviewed and determined to be correct. Reimbursement is subject to:

- (a) Sufficiency of funds in the Collection Line Trust Fund, and
- (b) Appropriation and approval by the City Council.

Development Services Engineer (Date)

**AIRPORT INDUSTRIAL SUBDIVISION
BLOCK 13, LOT 2
OFFSITE WASTE WATER REIMBURSEMENT**

ITEM NO.	ITEM	QTY.	UNIT	UNIT PRICE	AMOUNT
1	10" PVC PIPE	1196	LF	\$50.00	\$59,800.00
2	4' DIA. MANHOLE	4	EA	\$6,350.00	\$25,400.00
3	TRENCH SAFETY	1,196	LF	\$1.00	\$1,196.00
SUBTOTAL					\$86,396.00
Engineering and Surveying 11%					\$9,503.56
SUBTOTAL					\$95,899.56
Less Fee Value of Property*					-\$12,758.80
TOTAL					\$83,140.76

*FEE VALUE = 8.35 AC X \$1,528/AC = \$12,758.80

MAXIMUM AMOUNT REIMBURSEABLE

ITEM	AMOUNT
50% x FEE VALUE OF PROP x AVERAGE PIPE DIAM.	0.5 x 12,758.80 x 10=
	\$63,794.00