



**CITY OF CORPUS CHRISTI  
ENGINEERING SERVICES  
CHANGE ORDER**

---

**PROJECT:** Packery Channel Dredging & Beach Nourishment  
**CONTRACTOR:** Callan Marine, Ltd.  
**ENGINEER:** HDR Engineering  
**PROJECT MANAGER:** Edwin Santillan  
**OPERATING DEPT.:** Parks & Recreation  
Management and Budget Designee

**VENDOR ID NO.:** 150980  
**CONTRACT NO.:** 4640  
**PROJECT NUMBER:** 19046A  
**CHANGE ORDER NO.:** 1  
**CHANGE ORDER DATE:** date of finalized draft

(≥ \$100,000.00 or ≥ 25%) City Secretary

**PROJECT CHANGE ORDERS TRACKER**

**VENDOR ID NO.:** 150980  
**CONTRACT NO.:** 4640  
**PROJECT NO.:** 19046A  
**PROJECT NAME:** Packery Channel Dredging & Beach Nourishment  
**CONTRACTOR:** Callan Marine, Ltd.  
**ENGINEER:** HDR Engineering  
**CONSTR. INSPECTOR:** John Webster  
**CITY PROJ. MANAGER:** Edwin Santillian  
**CONTRACTOR SIGNEE:** Micah Morris  
**SIGNEE TITLE:** Operations Manager  
**NOTICE TO PROCEED DATE:** 10/16/2023  
**OPERATING DEPT.:** Parks & Recreation

<b>ORIGINAL CONTRACT INFORMATION</b>	<b>CONTRACT AMOUNT:</b>	\$3,531,549.00
	<b>CONTINGENCY (25%):</b>	\$882,887.25
		<b>CD'S                      DATE</b>
	<b>CONTRACT SUBSTANTIAL:</b>	120                      2/13/2024
	<b>CONTRACT FINAL:</b>	150                      3/14/2024
<b>REVISED CONTRACT INFORMATION</b>	<b>CONTRACT AMOUNT:</b>	\$3,723,051.00
		<b>CD'S                      DATE</b>
	<b>CONTRACT SUBSTANTIAL:</b>	125                      2/18/2024
	<b>CONTRACT FINAL:</b>	155                      3/19/2024

Construction Engineer	Brett Van Hazel, P.E.
Assistant City Attorney	Janet Whitehead
Management and Budget Designee	Kamil Taras
Director of Engineering Services	Jeff H. Edmonds, P.E.
Assistant City Manager	Neiman Young
City Secretary	Rebecca Huerta
Eng. Proj. Specialist	Brianna Cabrera
Construction Supervisor	Amie Wojtaszczyk
Constr. Inspector	John Webster
Constr. Sr. Project Mgr.	Victor Vargas

CHANGE ORDER NO.	CHANGE ORDER DATE	ADDITIONS	DEDUCTIONS	TOTAL CHANGE ORDER AMOUNT	%	TIME	%	EMAILED DATE (thru DocuSign)	EXECUTED DATE
1		\$191,502.00	#REF!	\$191,502.00	5.42%	5	4.17%	date	date
2					5.42%	none	4.17%	date	date
3					5.42%	none	4.17%	date	date
4					5.42%	none	4.17%	date	date
5					5.42%	none	4.17%	date	date
6					5.42%	none	4.17%	date	date
7					5.42%	none	4.17%	date	date
8					5.42%	none	4.17%	date	date
9					5.42%	none	4.17%	date	date
10					5.42%	none	4.17%	date	date
<b>TOTAL CHANGE ORDERS:</b>		<b>\$191,502.00</b>	<b>#REF!</b>	<b>\$191,502.00</b>	<b>5.42%</b>	<b>5</b>	<b>4.17%</b>		
<b>REMAINING AVAILABLE:</b>				<b>\$691,385.25</b>	<b>19.58%</b>				

↑ enter date change order is sent via DocuSign  
 ↑ enter date of last signature

	NOTES
Additions	reason
Deletions	#REF!
Additions	reason
Deletions	reason
Additions	reason
Deletions	reason
Additions	reason
Deletions	reason
Additions	reason
Deletions	reason
Additions	reason
Deletions	reason
Additions	reason
Deletions	reason
Additions	reason
Deletions	reason
Additions	reason
Deletions	reason
Additions	reason
Deletions	reason
Additions	reason
Deletions	reason

↓ reference bid tab & estimate template for bid parts.

		Additions	Deletions	Total
Section	Part A	\$ -	\$ -	\$ -
Section	Part B	\$ -	\$ -	\$ -
Section	Part C	\$ -	\$ -	\$ -
Section	Part D	\$ -	\$ -	\$ -
Section	Part E	\$ -	\$ -	\$ -
Section	Part F	\$ -	\$ -	\$ -
Section	Part G	\$ -	\$ -	\$ -
Section	Part H	\$ -	\$ -	\$ -
Section	Part I	\$ -	\$ -	\$ -
Section	Part J	\$ -	\$ -	\$ -
Section	Part K	\$ -	\$ -	\$ -
		\$ -	\$ -	\$ -



**BID TOTALS**

<b>BASE BID</b>	Total
Base Bid	\$3,531,549.00
Total	\$3,531,549.00

<b>ALTERNATE 1</b>	Total
Part B - Additive Alternate No. 1: Dredging Reach 2	\$100,500.00
Total	\$100,500.00

<b>ALTERNATE 2</b>	Total
Part C - Additive Alternate No. 2	\$70,000.00
Total	\$70,000.00

<b>ALTERNATE 3</b>	Total
Part D - Additive Alternate No. 3	\$191,502.00
Total	\$191,502.00

<b>Base Bid</b>					
No.	Description	Unit	Qty	Unit Price	Ext Price
A1	Mobilization (Max. 15%)	LS	1	\$570,000.00	\$570,000.00
A2	Bonds & Insurance	LS	1	\$20,449.00	\$20,449.00
A3	Construction Surveys	LS	1	\$100,000.00	\$100,000.00
A4	Pre-Dredge Hazard Survey	LS	1	\$35,000.00	\$35,000.00
A5	Aerial Photography	LS	1	\$20,000.00	\$20,000.00
A6	Storm Water Pollution Prevention	LS	1	\$13,000.00	\$13,000.00
A7	Debris Removal from Dredging Template	TON	20	\$1,500.00	\$30,000.00
A8	Pipeline Management	LS	1	\$475,000.00	\$475,000.00
A9	Pipeline Dredging (Reach 1)	CY	270000	\$8.03	\$2,168,100.00
A10	Allowance for Additional Work	AL	1	\$100,000.00	\$100,000.00
Subtotal:					\$3,531,549.00

**Part B - Additive Alternate No. 1: Dredging Reach 2**

No.	Description	Unit	Qty	Unit Price	Ext Price
B1	Construction Surveys	LS	1	\$12,000.00	\$12,000.00
B2	Pre-Dredge Hazard Survey	LS	1	\$5,000.00	\$5,000.00
B3	Debris Removal from Dredging Template	TON	1	\$1,500.00	\$1,500.00
B4	Pipeline Management	LS	1	\$30,000.00	\$30,000.00
B5	Pipeline Dredging (Reach 2)	CY	2000	\$26.00	\$52,000.00
Subtotal:					\$100,500.00

**Part C - Additive Alternate No. 2**

No.	Description	Unit	Qty	Unit Price	Ext Price
C1	Environmental Monitoring During Construction	LS	1	\$70,000.00	\$70,000.00
Subtotal:					\$70,000.00

**Part D - Additive Alternate No. 3**

No.	Description	Unit	Qty	Unit Price	Ext Price
D1	Construction Surveys	LS	1	\$1.00	\$1.00
D2	Pre-Dredge Hazard Survey	LS	1	\$1.00	\$1.00
D3	Debris Removal from Dredging Template	TON	1	\$1,500.00	\$1,500.00
D4	Pipeline Dredging (Reach 1)	CY	10000	\$19.00	\$190,000.00
Subtotal:					\$191,502.00

GENERAL NOTES:

- EXCEPT WHERE OTHERWISE NOTED, ALL BATHYMETRIC SURVEYING WITHIN PACKERY CHANNEL AND GULF OF MEXICO WAS PERFORMED BY NAISMITH MARINE SERVICES, INC. BATHYMETRIC SURVEY BETWEEN STATIONS 110+70 AND 136+50 WAS PERFORMED DURING NOVEMBER 11, 2019. THE REMAINDER OF THE CHANNEL (STATIONS 137+00 TO 198+10) WAS SURVEYED DURING APRIL 7, 2020. ALL TOPOGRAPHIC SURVEYING ALONG SEAWALL WAS PERFORMED BY NAISMITH MARINE SERVICES, INC. ON NOVEMBER 19, 2019. THESE DRAWINGS REPRESENT THE CONDITIONS THAT EXISTED AT THE TIMES OF THE SURVEYS.
- COORDINATES SHOWN ARE IN U.S. FEET AND REFERENCED TO STATE PLANE, TEXAS SOUTH ZONE, NAD '83 (1993).
- ELEVATIONS SHOWN ARE IN FEET AND REFERENCED TO NAVD '88.
- THE FOLLOWING SHALL BE APPLIED AS SURVEY CONTROL FOR THE REQUIRED WORK UNDER THIS PROJECT (SEE SHEET 3 FOR LOCATIONS):

IDENTIFICATION	NORTHING	EASTING	ELEVATION (NAVD '88)	LOCATION
SJ173+17	17,114,481	1,403,568	+5.2	SOUTH JETTY
CITY OF CORPUS MARKER	17,115,551	1,401,239	+5.6	BOAT RAMP

SURVEY CONTROL EMPLOYED DURING CONSTRUCTION SHALL MATCH CONTROL PUBLISHED IN THESE CONTRACT DOCUMENTS. NO OTHER SURVEY CONTROL SHALL BE CONSIDERED OR APPLIED WITHOUT ENGINEER'S CONCURRENCE. TO MAINTAIN CONSISTENCY BETWEEN PROJECT DESIGN AND CONSTRUCTED WORK, UPDATES, CORRECTIONS, OR OTHER CHANGES PUBLISHED BY NGS AND/OR OTHER ENTITIES FOR THESE CONTROL MONUMENTS SHALL NOT BE APPLIED WITHOUT WRITTEN CONCURRENCE FROM ENGINEER.

- CONTRACTOR SHALL VERIFY ACCURACY OF SURVEY CONTROL MONUMENTS PRIOR TO CONSTRUCTION. IMMEDIATELY REPORT ANY DISCREPANCIES TO ENGINEER.
- EXCEPT WHERE OTHERWISE NOTED, AERIAL PHOTOGRAPHY SHOWN ON THESE DRAWINGS WAS OBTAINED BY ARC GIS MAP SERVICE, WORLD IMAGERY (CLARITY) LAST UPDATED 02/20/2020.
- U.S. ARMY CORPS OF ENGINEERS PERMIT FOR THIS PROJECT IS INCLUDED IN APPENDIX 1 OF THE SPECIFICATIONS. CONTRACTOR SHALL BE FAMILIAR WITH THE REQUIREMENTS OF THIS PERMIT.
- GEOTECHNICAL INVESTIGATION FOR PACKERY CHANNEL WAS PERFORMED DURING AUGUST, 2019 BY BENCHMARK ECOLOGICAL SERVICES, INC. GEOTECHNICAL INVESTIGATION FOR THE BEACH NOURISHMENT AREA WAS PERFORMED DURING APRIL, 2011 BY ROSENGARTEN, SMITH, AND ASSOCIATES, INC. REFER TO APPENDIX 2 IN THE SPECIFICATIONS FOR GEOTECHNICAL INFORMATION.
- NOT ALL EXISTING UTILITIES, PIPELINES, STRUCTURES, AND OTHER OBSTRUCTIONS ARE SHOWN. CONTRACTOR SHALL VERIFY ALL EXISTING CONDITIONS PRIOR TO COMMENCING CONSTRUCTION ACTIVITIES.
- CONTRACTOR SHALL BE AWARE THAT SHORELINE AND BEACH PROFILE ARE EXTREMELY DYNAMIC AND SUBJECT TO SIGNIFICANT CHANGE OVER SHORT PERIODS OF TIME.
- CONTRACTOR SHALL TAKE MEASURES TO PROTECT EXISTING IMPROVEMENTS ADJACENT TO AND WITHIN THE WORK AREA, INCLUDING CONSTRUCTION ACCESS POINTS. ANY DAMAGE CAUSED BY CONTRACTOR'S ACTIVITIES SHALL BE REPAIRED AT THE EXPENSE OF CONTRACTOR TO THE SATISFACTION OF OWNER. CONTRACTOR SHALL REPAIR AND REPLACE PAVEMENT SECTIONS, STREET SECTIONS, SIDEWALK, SEAWALL, POST AND CABLE FENCES, AND ANY OTHER EXISTING FEATURES DAMAGED DURING CONSTRUCTION.
- ALL WORK AREAS SHALL BE SECURED AND SURROUNDED BY CONSTRUCTION BARRICADES, SAFETY FENCE, AND OTHER MEASURES SELECTED BY CONTRACTOR AS NECESSARY TO PROTECT THE PUBLIC. FLAGMEN SHALL DIRECT TRAFFIC AT LOCATIONS WHERE TRUCKS ENTER AND EXIT PUBLIC STREETS.
- CONTRACTOR SHALL TAKE PRECAUTIONS AND SECURE EQUIPMENT AGAINST ADVERSE WEATHER AND MARINE CONDITIONS. CONTRACTOR SHALL BE RESPONSIBLE FOR SECURING PIPELINE PRIOR TO ROUGH MARINE CONDITIONS AND RETRIEVAL/REPAIR OF DISLODGED/DISPERSED PIPE.
- CONSTRUCTION EQUIPMENT SHALL NOT OPERATE ON PRIVATE PROPERTY OR OUTSIDE DESIGNATED WORK LIMITS.
- INGRESS AND EGRESS OF CONTRACTOR'S VEHICLES SHALL BE KEPT TO A MINIMUM. ALL VEHICLES SHALL USE COMMON PATHWAYS WHENEVER POSSIBLE. ALL CONSTRUCTION ACCESS POINTS SHALL BE MARKED WITH WARNING SIGNS TO WATCH FOR AND AVOID SEA TURTLES AND PIPING PLOVERS (SEE SHEET 15).
- CONTRACTOR MAY USE AREAS AS STATED ON SHEETS 10 AND 13 FOR STAGING EQUIPMENT. PROPOSED LIMITS OF STAGING AREAS SHALL BE STAKED BY CONTRACTOR FOR REVIEW BY OWNER PRIOR TO USE OF STAGING AREA. STAGING AREA(S) SHALL BE DELINEATED BY SILT FENCE AS MAY BE REQUIRED BY STORM WATER POLLUTION PREVENTION PLAN. CONTRACTOR SHALL PROVIDE A CHAIN LINK FENCE TO PROMOTE ADDED SECURITY AND/OR PUBLIC SAFETY. ANY SILT FENCE AND/OR CHAIN LINK FENCE THAT IS CONSTRUCTED SHALL BE PROVIDED AT NO ADDITIONAL COST TO OWNER. UPON COMPLETION OF CONSTRUCTION, STAGING AREA(S) SHALL BE LEFT IN EQUAL OR BETTER CONDITION THAN EXISTED PRIOR TO WORK.
- THE NATIONAL OCEANIC AND ATMOSPHERIC ADMINISTRATION (NOAA) PROVIDES THE FOLLOWING TIDAL STATISTICS FOR THE PROJECT REGION. CONTRACTOR SHALL BE AWARE THAT ACTUAL DAILY TIDES MAY VARY BY SEVERAL FEET FROM THESE STATISTICAL TIDES DUE TO METEOROLOGICAL FORCES SUCH AS WIND. THE ELEVATION DATUM RELATIONSHIPS AT BOB HALL PIER (NOAA STATION 8775870) SHALL BE APPLIED FOR REACH 1 DREDGING AND THE BEACH MAINTENANCE AREA. THE ELEVATION DATUM RELATIONSHIPS AT PACKERY CHANNEL (NOAA STATION 8775792) SHALL BE APPLIED FOR REACH 2 DREDGING.

DATUM	ELEVATION, FT. (NAVD)	
	NOAA 8775870 BOB HALL PIER	NOAA 8775792 PACKERY CHANNEL
MHHW	+1.18	+0.79
MHW	+1.09	+0.79
MSL	+0.48	+0.59
MLLW	-0.45	+0.37

BEACH NOURISHMENT NOTES:

- ALL BEACH FILL MATERIAL SHALL BE EXTRACTED FROM THE DREDGING AREAS SHOWN ON SHEETS 9 THROUGH 12. ALL BEACH FILL MATERIAL SHALL BE PLACED WITHIN THE LINES AND GRADES SHOWN FOR THE BEACH NOURISHMENT AREA AS SHOWN ON SHEET 13.
- BEACH FILL MATERIAL SHALL BE PLACED CONTINUOUSLY, TO THE FULL BERM WIDTH SHOWN, AND GENERALLY IN THE PLACEMENT DIRECTION SHOWN STARTING AT STATION B103+00.
- ALL BEACH FILL MATERIAL SHALL BE TRANSPORTED FROM DREDGING AREAS TO BEACH NOURISHMENT AREA VIA DREDGING PIPELINE. TRANSPORTATION OF DREDGED MATERIAL VIA TRUCKING IS NOT PERMITTED.
- THE FINISHED BEACH SURFACE SHALL BE SMOOTHLY AND UNIFORMLY GRADED AND DRESSED TO ELIMINATE HUMPS AND DEPRESSIONS. DRESSING THE FILL BELOW THE WATER LINE IS NOT REQUIRED. REFER TO SPECIFICATION SECTION 35 24 00 (DREDGING) FOR REQUIREMENTS FOR SMOOTHING SCARPS ALONG THE SHORELINE.
- PLACEMENT OF BEACH FILL MATERIAL SHALL NOT OBSTRUCT OR IMPEDE SURFACE RUNOFF FROM ADJACENT UPLAND AREAS. TEMPORARY DRAINAGE, SUCH AS SWALES, DITCHES, ETC., SHALL BE INCORPORATED INTO THE WORK TO PREVENT PONDING WATER. NOTIFY ENGINEER PRIOR TO IMPLEMENTATION OF TEMPORARY DRAINAGE MEASURES.
- ANY TRASH BARRELS AND SIGNS WITHIN THE BEACH NOURISHMENT AREA FOOTPRINT WILL BE SALVAGED BY OWNER PRIOR TO THE START OF WORK UNDER THIS CONTRACT. REMAINING OBSTRUCTIONS THAT INTERFERE WITH THE WORK SHALL BE REMOVED BY CONTRACTOR. TIMBER BOLLARDS SHALL BE SALVAGED AND REINSTALLED BY CONTRACTOR.
- CONTRACTOR SHALL NOT STAGE UNUSED EQUIPMENT AND/OR EXCESS DREDGING PIPELINE ON BEACH.

- ONLY APPROVED DREDGE DISCHARGE PIPELINE AND CONSTRUCTION ROUTES SHALL BE UTILIZED. CONTRACTOR SHALL SUBMIT TO ENGINEER FOR APPROVAL A PIPELINE MAP AS PART OF THE CONSTRUCTION PLAN (SEE SPECIFICATION 35 24 00 "DREDGING"). PIPELINE SHALL BE LOCATED ON THE PUBLIC BEACH AS FAR LANDWARD AS PRACTICABLE BUT SEAWARD OF THE DUNE LINE. PIPELINE SHALL NOT BE LOCATED IN A MANNER THAT IMPEDES BEACH ACCESS.
- PROVIDE CLEAR RIGHT-OF-WAY ON BEACH ALONG PIPELINE CORRIDOR FOR PUBLIC AT ALL TIMES DURING CONSTRUCTION. TRENCHING OF DREDGING PIPELINE AND/OR SAND RAMP-OVERS SHALL BE PROVIDED EVERY 500' (MAX) AND AT DESIGNATED VEHICLE AND PEDESTRIAN ACCESS POINTS. BEACH ACCESS TO EMERGENCY VEHICLES SHALL BE MAINTAINED AT ALL TIMES. AFTER DREDGE PIPELINE HAS BEEN REMOVED, BEACH SHALL BE RESTORED TO NATURAL GRADE.
- CONTRACTOR SHALL BE AWARE OF AND FAMILIARIZE HIMSELF WITH OWNER'S BEACH MAINTENANCE ACTIVITIES. OWNER WILL CONTINUE BEACH MAINTENANCE DURING CONSTRUCTION AND MAY PLACE SAND OVER CONTRACTOR'S DREDGE PIPELINE. CONTRACTOR SHALL BE RESPONSIBLE FOR ANY EXCAVATION REQUIRED TO REMOVE DREDGE PIPELINE AT COMPLETION OF WORK. UPON COMPLETION OF PIPELINE REMOVAL, GRADES SHALL BE RESTORED TO PRE-EXCAVATION CONDITIONS. ALL EXCAVATION PERFORMED TO REMOVE DREDGE PIPELINE SHALL BE COORDINATED WITH THE CITY OF CORPUS CHRISTI PARKS AND RECREATION DEPARTMENT (CONTACT DARRIN GURLEY, 361-826-1634).
- NOISE ON BEACH SHALL BE MINIMIZED FROM 7:00 PM THROUGH 7:00 AM. IF BOOSTER PUMPS ARE EMPLOYED ON BEACH, CONTRACTOR SHALL INSTALL A SOUND DAMPENING BARRIER AROUND EACH PUMP TO REDUCE DECIBEL OUTPUT TO LESS THAN 85 DECIBELS AT 100 FT FROM THE PUMPS. WORK BEFORE 7:00 AM AND AFTER 7:00 PM SHALL BE PLANNED TO MINIMIZE NOISE FROM BACKUP ALARMS, PROLONGED IDLING OF EQUIPMENT, AND OTHER EQUIPMENT THAT MAY DISTURB THE PUBLIC. LIGHTING SHALL BE KEPT TO A MINIMUM AND SHALL NOT BE DIRECTED TOWARDS ADJACENT BUILDINGS.
- REFER TO SHEET 14 FOR BEACH NOURISHMENT CONSTRUCTION TEMPLATE.

DREDGING NOTES:

- PRIOR TO COMMENCING DREDGING, CONTRACTOR SHALL PERFORM A PRE-DREDGING HAZARD (MAGNETOMETER) SURVEY OVER THE WORK AREA TO LOCATE ANY BURIED OBSTRUCTIONS OR UNCHARTED PIPELINES THAT MAY BE PRESENT. REFER TO SPECIFICATION SECTION 35 00 01, "CONSTRUCTION SURVEYING," FOR REQUIREMENTS.
- ALL DREDGED MATERIAL SHALL BE PLACED WITHIN THE DESIGNATED BEACH NOURISHMENT AREA AS BEACH FILL.
- ANY AND ALL DEBRIS ENCOUNTERED DURING DREDGING SHALL BECOME THE PROPERTY OF CONTRACTOR. SUCH DEBRIS SHALL BE REMOVED BY CONTRACTOR AND DISPOSED IN ACCORDANCE WITH APPLICABLE LAWS AND ORDINANCES.
- ANY UNAUTHORIZED EXTRACTION OR DEPOSITION OF DREDGED MATERIAL SHALL BE CORRECTED BY CONTRACTOR TO THE SATISFACTION OF OWNER AND/OR REGULATORY AGENCIES.
- REFER TO SHEETS 16 THROUGH 25 FOR DREDGING SECTIONS.
- CONTRACTOR SHALL BE AWARE OF NAVIGATIONAL REQUIREMENTS OF OTHER CHANNEL USERS. DREDGING OPERATIONS, EQUIPMENT, AND PERSONNEL SHALL NOT RESTRICT NAVIGATION IN THE CHANNEL. CONTRACTOR SHALL KEEP AHEAD OF THE NAVIGATION REQUIREMENTS OF OTHER VESSELS' INGRESS AND EGRESS AND PROVIDE APPROPRIATE ACCOMMODATIONS TO MOVE DREDGING PLANT AND OTHER EQUIPMENT SO AS TO NOT INTERFERE WITH NAVIGATION. DELAYS CAUSED BY OTHER CHANNEL USERS SHALL NOT BE GROUNDS FOR CLAIMS, CHANGED CONDITIONS, OR TIME EXTENSIONS TO THE CONTRACT.
- CONTRACTOR SHALL ANTICIPATE ACTIVE RECREATION BY THE PUBLIC AROUND DREDGING AND STAGING AREAS. MAINTAIN PUBLIC ACCESS TO THE BEACH, JETTIES, AND CHANNEL AT ALL TIMES, AS PRACTICABLE AND SAFE.
- ALL CHANNEL END SLOPES SHALL BE EQUAL TO CHANNEL SIDE SLOPES AT THE SAME STATION, UNLESS OTHERWISE SPECIFIED.
- DREDGING SECTIONS SHALL BE DEFINED AS FOLLOWS:

CHANNEL REACH	DREDGING SECTION	FROM STATION	TO STATION	DISTANCE BETWEEN STATIONS, FT.	COMMENT
1	1	198+10	154+60	4,350	BASE WORK
	2	154+60	140+50	1,410	BASE WORK AND ADDITIVE ALTERNATE NO. 3
2	3	136+50	130+00	650	ADDITIVE ALTERNATE NO. 1

- NO DREDGING OR EXCAVATION SHALL OCCUR WITHIN 20' OF EXISTING CHANNEL MARKERS.
- ALL DREDGING FROM STATION 198+10 TO 188+00 SHALL BE COMPLETED PRIOR TO COMMENCEMENT OF DREDGING AT ANY OTHER LOCATIONS. DREDGING MAY BE PERFORMED IN AN ADJACENT SECTION OF CHANNEL WHEN ROUGH SEA CONDITIONS PREVENT DREDGING BETWEEN STATION 198+10 AND 188+00. HOWEVER, CONTRACTOR SHALL IMMEDIATELY RESUME DREDGING BETWEEN STATION 198+10 AND 188+00 ONCE ROUGH SEA CONDITIONS HAVE PASSED.

REMOVAL AND DISPOSAL OF SUBMERGED ITEMS FROM CHANNEL:

- LOCATIONS OF KNOWN DEBRIS WITHIN THE DREDGING TEMPLATE ARE SHOWN ON THESE DRAWINGS. CONTRACTOR SHALL ANTICIPATE ADDITIONAL DEBRIS SUCH AS LARGE ROCKS, RIPRAP, ROPE, TIRES, AND OTHER MISCELLANEOUS DEBRIS IN THE CHANNEL. THIS DEBRIS SHALL BE REMOVED IN ACCORDANCE WITH THE SPECIFICATIONS.
- CONTRACTOR SHALL PERFORM A SIDE SCAN SONAR (SSS) SURVEY AND PERFORM SURFACE PROBING WITH A PVC PIPE, TIMBER STAKE, OR OTHER SIMILAR MANUAL METHOD AS NEEDED TO HELP DETECT PRESENCE OF SUBMERGED ITEMS IN CHANNEL AT LOCATIONS SPECIFIED ON SHEETS 4-7.
- REFER TO SPECIFICATION 35 00 01, "CONSTRUCTION SURVEYING," FOR SSS SURVEY REQUIREMENTS.
- CONTRACTOR SHALL BE RESPONSIBLE FOR DISPOSAL OF ITEMS REMOVED FROM CHANNEL. ITEMS SHALL BE DISPOSED OFFSITE AND IN ACCORDANCE WITH APPLICABLE LAWS AND ORDINANCES.
- REMOVAL OF DEBRIS SHALL BE DOCUMENTED IN CONTRACTOR'S DAILY REPORTS THROUGH WRITTEN DESCRIPTION AND DIGITAL PHOTOGRAPHY.

LEGEND:

- SURVEY CONTROL POINT
- EXISTING SPOT ELEVATION, FT.
- CHANNEL MARKERS
- UNIDENTIFIABLE DEBRIS
- SOIL SAMPLE LOCATION
- APPROXIMATE EXISTING GRADE
- EXISTING WATER LINE
- EXISTING GAS LINE
- EXISTING TELEPHONE LINE
- EXISTING SANITARY SEWER LINE
- EXISTING OVERHEAD ELECTRICAL LINE
- DREDGE DISCHARGE PIPELINE
- DREDGING BASELINE "A"
- BEACH NOURISHMENT BASELINE "B"
- ELEVATION CONTOURS

- REQUIRED DREDGING AREA
- DREDGING AREA (ALLOWABLE OVERDEPTH)
- BEACH NOURISHMENT PLACEMENT AREA
- STAGING AREA
- REQUIRED DREDGING AREA (ADDITIVE ALTERNATE NO. 3)

SUMMARY OF ESTIMATED BID QUANTITIES		
BID ITEM	QTY & UNIT	DESCRIPTION
BASE BID		
A-1	1 LS	MOBILIZATION (MAX. 15%)
A-2	1 LS	BONDS & INSURANCE
A-3	1 LS	CONSTRUCTION SURVEYS
A-4	1 LS	PRE-DREDGE HAZARD SURVEY
A-5	1 LS	AERIAL PHOTOGRAPHY
A-6	1 LS	STORM WATER POLLUTION PREVENTION
A-7	20 TON	DEBRIS REMOVAL FROM DREDGING TEMPLATE
A-8	1 LS	PIPELINE MANAGEMENT
A-9	270,000 CY	PIPELINE DREDGING (REACH 1)
A-10	\$100,000	ALLOWANCE FOR ADDITIONAL WORK
ADDITIVE ALTERNATIVE NO. 1		
B-1	1 LS	CONSTRUCTION SURVEYS
B-2	1 LS	PRE-DREDGE HAZARD SURVEY
B-3	1 TON	DEBRIS REMOVAL FROM DREDGING TEMPLATE
B-4	1 LS	PIPELINE MANAGEMENT
B-5	2,000 CY	PIPELINE DREDGING (REACH 2)
ADDITIVE ALTERNATIVE NO. 2		
C-1	1 LS	ENVIRONMENTAL MONITORING DURING CONSTRUCTION
ADDITIVE ALTERNATIVE NO. 3		
D-1	1 LS	CONSTRUCTION SURVEYS
D-2	1 LS	PRE-DREDGE HAZARD SURVEYS
D-3	1 TON	DEBRIS REMOVAL FROM DREDGING TEMPLATE
D-4	10,000 CY	PIPELINE DREDGING

CONSULTANT'S SHEET NO.

00G-02



CITY of CORPUS CHRISTI  
TEXAS  
Department of Engineering Services

PACKERY CHANNEL MAINTENANCE  
AND BEACH NOURISHMENT

GENERAL NOTES AND LEGEND

SHEET 2 of 25

RECORD DRAWING NO.

CP-188

CITY PROJECT #19046A

PRINTED HALF-SIZE

NOTES:

1. REFER TO GENERAL AND DREDGING NOTES ON SHEET 2.
2. LOCATIONS OF EXISTING UTILITIES SHOWN ON THIS SHEET ARE APPROXIMATE. REFER TO DREDGING NOTE 1 ON SHEET 2 REGARDING REQUIRED PRE-DREDGE HAZARD SURVEY.
3. CONTRACTOR MAY USE SPACE SHOWN WITHIN EXISTING PUBLIC PARKING AREA FOR TEMPORARY ASSEMBLY, LAUNCHING, AND RETRIEVAL OF DREDGE PIPELINE. IF CONTRACTOR DESIRES LONGER-TERM USE OF THIS AREA, CONSTRUCTION PLAN (REFERENCE SPECIFICATION SECTION 35 24 00, "DREDGING") SHALL PROVIDE PROPOSED TIMING AND DURATION FOR REVIEW AND APPROVAL BY OWNER.
4. REFER TO SHEETS 20 THROUGH 23 FOR DREDGING SECTIONS.
5. NO DIRECT DREDGING SHALL OCCUR WITHIN 20 FT OF EXISTING DOCKS.
6. THE CITY OF CORPUS CHRISTI HAS REPORTED A 6" GAS LINE UNDER PACKERY CHANNEL NEAR STA 141+00. THE DEPTH AND ALIGNMENT OF THIS PIPELINE WAS NOT AVAILABLE AT THE TIME OF PREPARATION OF THIS DRAWING. CONTRACTOR SHALL NOT PROCEED WITH DREDGING BETWEEN STA 140+50 AND 141+50 UNTIL OWNER HAS DETERMINED THE DEPTH AND ALIGNMENT OF THIS GAS LINE AND APPROVED DREDGING IN THIS AREA.

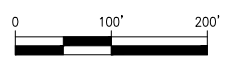
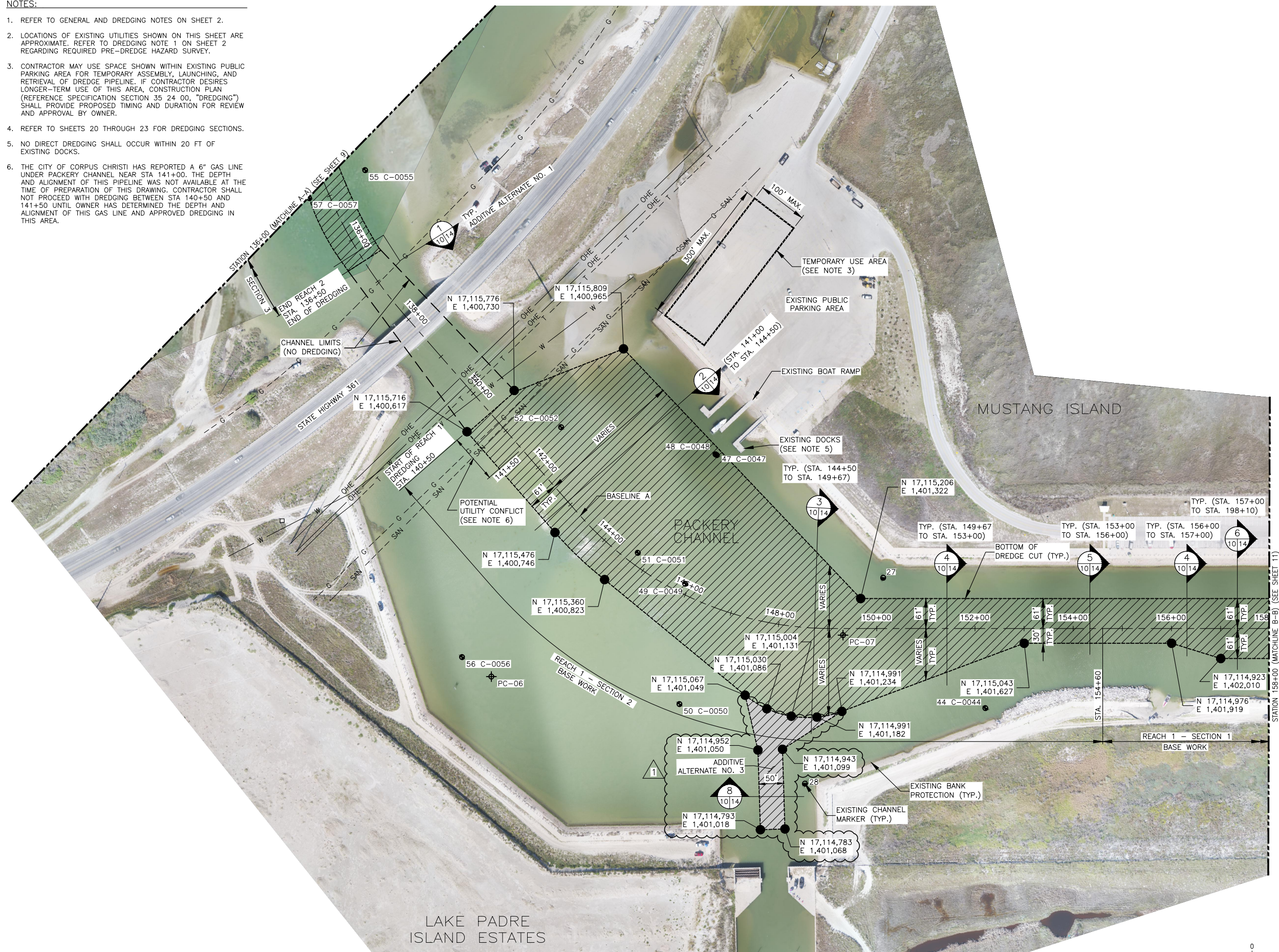

**1**  
**3/10** DREDGING PLAN 2  
SCALE: 1" = 100'

**PRINTED HALF-SIZE**

UPDATED: 3/8/2023

CONSULTANT'S SHEET NO.

00C-08

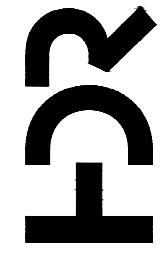

TBPELS Firm  
Registration No. F-754  
Project No. 10212723

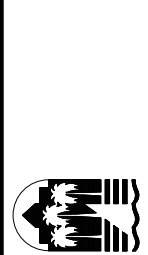

**CITY OF CORPUS CHRISTI TEXAS**  
Department of Engineering Services

REVISION NO.	DATE	BY	DESCRIPTION
1	03-08-2023	DJH	ADDITION NO. 2

PACKERY CHANNEL MAINTENANCE AND BEACH NOURISHMENT

DREDGING PLAN 2

SHEET 10 of 25  
RECORD DRAWING NO.

CP-188

CITY PROJECT #19046A



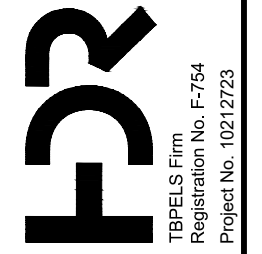

**CITY of CORPUS CHRISTI TEXAS**  
Department of Engineering Services

PACKERY CHANNEL MAINTENANCE AND BEACH NOURISHMENT

TYPICAL SECTIONS AND DETAILS 1

REVISION NO.	DATE	DESCRIPTION
1	03-08-2023	ADDITION NO. 2

BY: DJH  
DATE: 03-08-2023  
SHEET 14 of 25  
RECORD DRAWING NO. CP-188  
CITY PROJECT # 19046A

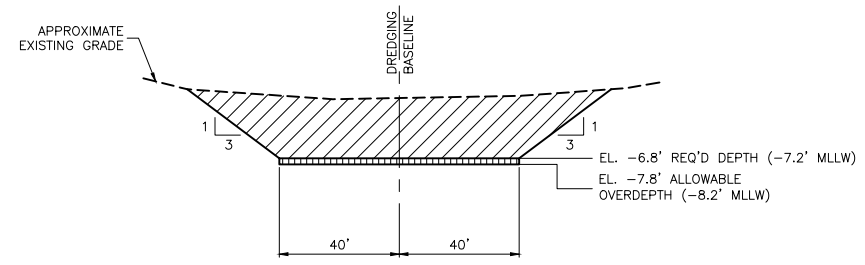

1  
9/14 SCALE: N.T.S.  
TYPICAL SECTION - DREDGING TEMPLATE (REACH 2)  
(STA. 130+00 TO STA. 136+50)(ADDITIVE ALTERNATE NO. 1)

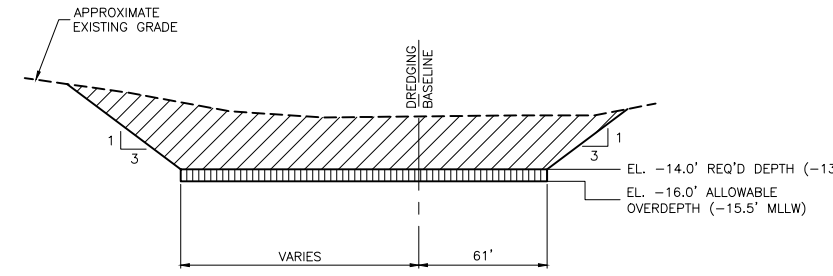

2  
10/14 SCALE: N.T.S.  
TYPICAL SECTION - DREDGING TEMPLATE (REACH 1)  
(STA. 140+50 TO STA. 144+50)

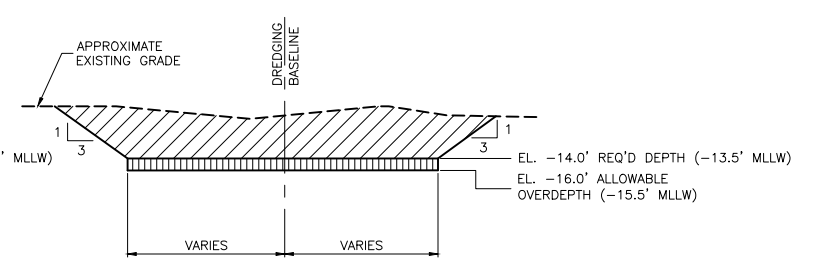

3  
10/14 SCALE: N.T.S.  
TYPICAL SECTION - DREDGING TEMPLATE (REACH 1)  
(STA. 144+50 TO STA. 149+67)

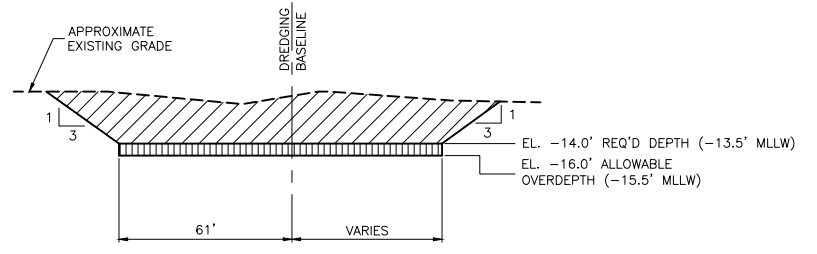

4  
10/14 SCALE: N.T.S.  
TYPICAL SECTION - DREDGING TEMPLATE (REACH 1)  
(STA. 149+67 TO STA. 153+00 AND STA. 156+00 TO 157+00)

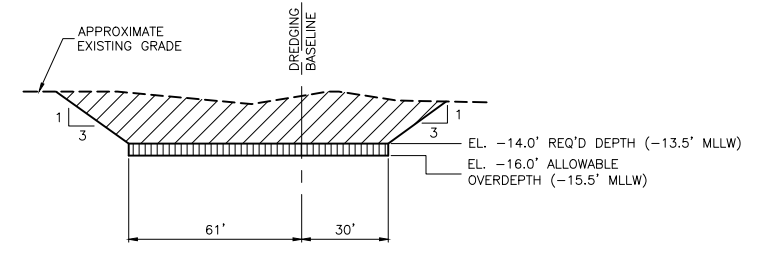

5  
10/14 SCALE: N.T.S.  
TYPICAL SECTION - DREDGING TEMPLATE (REACH 1)  
(STA. 153+00 TO STA. 156+00)

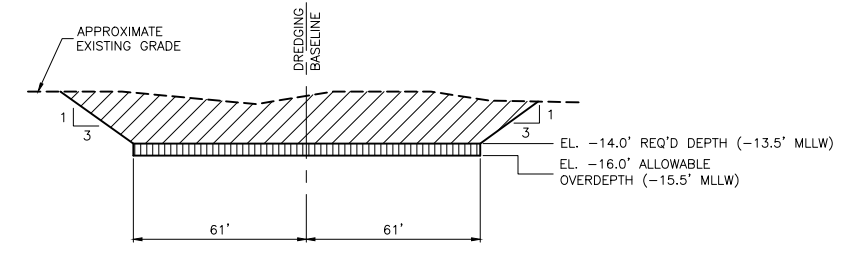

6  
10/14 SCALE: N.T.S.  
TYPICAL SECTION - DREDGING TEMPLATE (REACH 1)  
(STA. 157+00 TO 198+10)

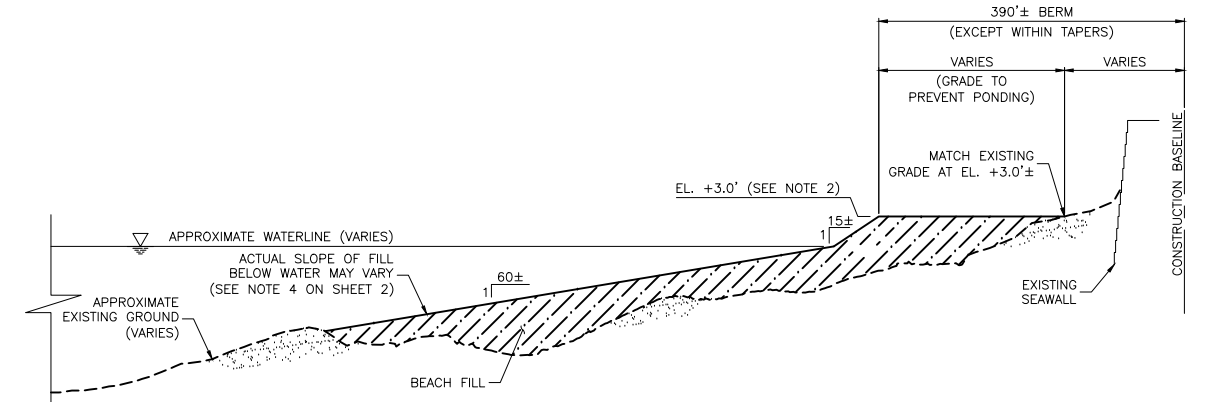

7  
13/14 SCALE: N.T.S.  
TYPICAL SECTION - BEACH NOURISHMENT CONSTRUCTION TEMPLATE

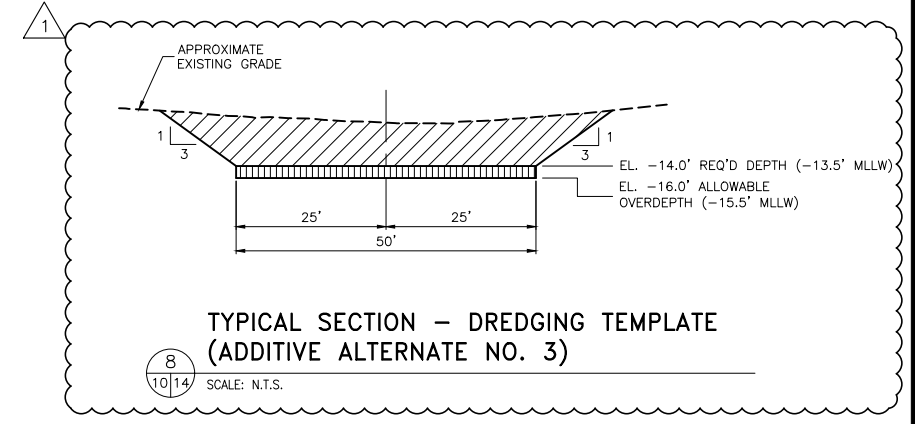

8  
10/14 SCALE: N.T.S.  
TYPICAL SECTION - DREDGING TEMPLATE  
(ADDITIVE ALTERNATE NO. 3)

- NOTES:
- REFER TO NOTES ON SHEET 2.
  - PLACEMENT/GRADING TOLERANCE FOR FINISHED BEACH NOURISHMENT BERM ELEVATION IS PLUS OR MINUS 0.3'. REFER TO ADDITIONAL GRADING/DRESSING REQUIREMENTS IN SPECIFICATION SECTION 35 33 00, "BEACH NOURISHMENT."

PRINTED HALF-SIZE