



## STREET, ALLEY, OR OTHER PUBLIC WAY CLOSURE APPLICATION

MUST COMPLY WITH CITY CODE OF ORDINANCES Chapter 49-12.

### SECTION A. SUBMITTAL REQUIREMENTS

**PLEASE INCLUDE ALL OF THE FOLLOWING (CHECK-OFF).** The applicant is responsible for submitting a formal application, applicable fees, stamped drawings and other required materials to initiate the process. Incomplete packages or inaccurate information will delay processing and review. All the following (check off) information is required for the submittal to be considered for the official review:

\_\_\_\_ **Application fee of \$1,000.00 (Nonrefundable).** This fee is charged to cover all administrative costs associated with processing the request. A cashier's or certified check shall be made payable to the City of Corpus Christi.

\_\_\_\_ **Metes & Bounds.** The applicant shall obtain a legal description of the proposed street, alley or public way requested for closure. The metes and bounds shall be prepared by a Licensed Surveyor in the State of Texas.

\_\_\_\_ **Location Map.** The petitioner shall obtain a map of the proposed street, alley or public way requested for closure. The map shall contain a north arrow, the location of the request with reference made to nearby roads and/or recognizable landmarks, and labels of property owners abutting and within proximity of the closure. This map shall be prepared by a Licensed Surveyor Engineer in the State of Texas.

\_\_\_\_ **Deed Records.** The applicant shall provide contact information and Deed Records for all abutting property owners.

\_\_\_\_ **Abutting Property Owners.** Signatures from property owners who will be deeded street segments are required. Required signatures may vary depending on the type/location of closure requested.

\_\_\_\_ **Appraisal Fee.** The applicant shall agree to obtain an appraisal, completed by a MAI certified appraiser who is pre-approved by the City, and pay the City the Fair Market Value (FMV) for the street, alley, or public way. The appraisal must be conducted no more than six (6) months prior to the request.

### SECTION B. APPLICANT & SUMMARY INFORMATION

**BOTH THE PROPERTY OWNER (APPLICANT/PETITIONER) AND AGENT (IF APPLICABLE) MUST SIGN WHERE INDICATED. A SIGNED ORIGINAL AUTHORIZED LETTER MAY BE SUBSTITUTED FOR THE *PROPERTY OWNER'S (APPLICANT'S)* SIGNATURE.**

1. APPLICANT/PETITIONER INFORMATION:

Name: Port of Corpus Christi Authority of Nueces County, Texas

Mailing Address: P O Box 1541

City: Corpus Christi

State: Texas

Zip: 78403

Daytime Telephone: (361) 885-6140

Email Address: sam@pocca.com

2. AGENT INFORMATION (IF APPLICABLE):

Name: \_\_\_\_\_

Mailing Address: \_\_\_\_\_

City: \_\_\_\_\_

State: Texas

Zip: \_\_\_\_\_

Daytime Telephone: \_\_\_\_\_

Email Address: \_\_\_\_\_

Return To: Traffic Engineering Department • PO Box 9277 • Corpus Christi, TX 78469-9277  
Physical Address: Traffic Engineering Department • 1201 Leopard Street (City Hall, 3<sup>rd</sup> Floor) • Corpus Christi, TX 78401  
Email: [TrafficEngineering@cctexas.com](mailto:TrafficEngineering@cctexas.com) • Phone (361)826-3547



## STREET, ALLEY, OR OTHER PUBLIC WAY CLOSURE APPLICATION

MUST COMPLY WITH CITY CODE OF ORDINANCES Chapter 49-12.

### 3. PETITION REQUEST

Close, Vacate, Abandon, or Alter Street

Improved: ☒ Yes ☐ No

Name: Washington St. and Williams Ave

Length(ft): \_\_\_\_\_ Width(ft): \_\_\_\_\_ Area (ft): 17,496

\_\_\_\_\_ Close, Vacate, Abandon, or Alter Alley

Improved: \_\_\_\_\_ Yes ☐ No ☐

Name: \_\_\_\_\_

Length(ft): \_\_\_\_\_ Width(ft): \_\_\_\_\_ Area (ft): \_\_\_\_\_

\_\_\_\_\_ Close, Vacate, Abandon, or Alter Public Access Easement/Public Way

Improved: \_\_\_\_\_ Yes ☐ No ☐

Name: \_\_\_\_\_

Length(ft): \_\_\_\_\_ Width(ft): \_\_\_\_\_ Area (ft): \_\_\_\_\_

### 4. STATEMENT OF INTENDED USE OF STREET, ALLEY, OR PUBLIC ACCESS EASEMENT/PUBLIC WAY TO BE CLOSED:

Per the Four Party Agreement effective November 25, 2014 by and between the Texas Department of Transportation ("TxDOT"), the Port of Corpus Christi Authority of Nueces County, Texas ("Port"), the City of Corpus Christi, Texas ("City"), and the Corpus Christi Housing Authority are each referred to as a "Party." and collectively as the "Parties." The City acknowledges and agrees that where streets, alleys or other public ways abut Acquired Property, in order to facilitate the Port's use of the Acquired Property for Port Purposes, the closures or alteration of those streets, alleys, or ways may become necessary.

### 5. SUBDIVISION INFORMATION:

Subdivision Name: John G Hatch Addition and E Villareal Survey, A-1

Affected Block & Lot Numbers: Block 1, Lots 5, 6

0.6553 ac, Tract V, E Villareal Survey, A-1, Doc# 2024034769

20.58 ac, Tract IV, E Villareal Survey, A-1, Doc# 2023020607

### 6. ACKNOWLEDGEMENT:

Pre-Application Meeting Date: Thursday, September 19, 2024 11:30 AM-1:00 PM Port Office

Applicant/Agent (If Applicable) Signature: Sam Esquivel

Digitally signed by Sam Esquivel  
Date: 2024.12.20 15:32:36 -0600'

*Note: No action will be taken without payment of the nonrefundable processing fee and necessary documents. The application and fee in no way obligates the City to approve the petition request. Incorrect signatures and information will void the application request and may cause delay in processing. The process for right-of-way closure can be found in Section 49-12 of the City Code of Ordinances. If you have any questions, please contact the Department of Public Works (Traffic Engineering Division) at 361-826-3547.*

Return To: Traffic Engineering Department • PO Box 9277 • Corpus Christi, TX 78469-9277

Physical Address: Traffic Engineering Department • 1201 Leopard Street (City Hall, 3<sup>rd</sup> Floor) • Corpus Christi, TX 78401

Email: [TrafficEngineering@cctexas.com](mailto:TrafficEngineering@cctexas.com) • Phone (361)826-3547



## STREET, ALLEY, OR OTHER PUBLIC WAY CLOSURE APPLICATION

MUST COMPLY WITH CITY CODE OF ORDINANCES Chapter 49-12.

### SECTION C. ABUTTING PROPERTY OWNERS

**SUBMIT ORIGINAL SIGNATURES ONLY. A SIGNED ORIGINAL AUTHORIZED LETTER MAY BE SUBSTITUTED FOR THE *PROPERTY OWNER'S* SIGNATURE. COPIES WILL NOT BE ACCEPTED.**

Address: 2501-2503 N Port Ave

Subdivision Name: John G Hatch Addition Blk: 1 Lot: 5 & 6

Owner(s): Port of Corpus Christi Authority of Nueces County, Texas

Print Name: Sam Esquivel, Director of Real Estate Services

Signatures: \_\_\_\_\_

*By signing this petition, the above signed abutting property owner agrees to the closure, vacation, and abandonment of certain Public Right of Way as requested by the petitioner. However, this agreement is not a quitclaim of any entitlement that the abutting property owner may have in the Public Right of Way.*

Address: 2501-2503 N Port Ave

Subdivision Name: E Villareal Survey, A-1 Blk: 0.6553 ac, Tr IV Lot: Doc# 2024034769

Owner(s): Port of Corpus Christi Authority of Nueces County, Texas

Print Name: Sam Esquivel, Director of Real Estate Services

Signatures: \_\_\_\_\_

*By signing this petition, the above signed abutting property owner agrees to the closure, vacation, and abandonment of certain Public Right of Way as requested by the petitioner. However, this agreement is not a quitclaim of any entitlement that the abutting property owner may have in the Public Right of Way.*

Address: 2101 W Broadway St

Subdivision Name: E Villareal Survey, A-1 Blk: 20.58 ac, Tract 1 Lot: Doc# 2023020607

Owner(s): Port of Corpus Christi Authority of Nueces County, Texas

Print Name: Sam Esquivel, Director of Real Estate Services, acknowledges all of the above submittals

Signatures:  Digitally signed by Sam Esquivel  
Date: 2024.12.20 15:33:15 -06'00'

*By signing this petition, the above signed abutting property owner agrees to the closure, vacation, and abandonment of certain Public Right of Way as requested by the petitioner. However, this agreement is not a quitclaim of any entitlement that the abutting property owner may have in the Public Right of Way.*

Address: \_\_\_\_\_

Subdivision Name: \_\_\_\_\_ Blk: \_\_\_\_\_ Lot: \_\_\_\_\_

Owner(s): \_\_\_\_\_

Print Name: \_\_\_\_\_

Signatures: \_\_\_\_\_

*By signing this petition, the above signed abutting property owner agrees to the closure, vacation, and abandonment of certain Public Right of Way as requested by the petitioner. However, this agreement is not a quitclaim of any entitlement that the abutting property owner may have in the Public Right of Way.*

Return To: Traffic Engineering Department • PO Box 9277 • Corpus Christi, TX 78469-9277  
Physical Address: Traffic Engineering Department • 1201 Leopard Street (City Hall, 3<sup>rd</sup> Floor) • Corpus Christi, TX 78401  
Email: [TrafficEngineering@cctexas.com](mailto:TrafficEngineering@cctexas.com) • Phone (361)826-3547

0.533 ACRES  
PORT OF CORPUS  
CHRISTI AUTHORITY  
DOC. NO. 2023006094  
O.P.R.N.C.TX.

W. BROADWAY ST.  
(50' R.O.W.)

P.O.B.

N88°32'29"E  
44.44'

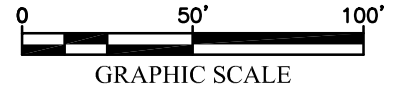

NUECES COUNTY  
ENRIQUEZ VILLAREAL SURVEY  
ABSTRACT NO. 1

LEGEND

---	ADJOINER LINE
---	ORIGINAL PLAT LINE
---	PROPERTY LINE
⊙	5/8" REBAR FOUND
⊗	REBAR SET
AC.	ACRES
P.O.B.	POINT OF BEGINNING
S.F.	SQUARE FEET
D.R.N.C.TX.	DEED RECORDS OF NUECES COUNTY, TEXAS
O.P.R.N.C.TX.	OFFICIAL PUBLIC RECORDS OF NUECES COUNTY, TEXAS
P.R.N.C.TX.	PLAT RECORDS OF NUECES COUNTY, TEXAS
R.P.R.N.C.TX.	REAL PROPERTY RECORDS OF NUECES COUNTY, TEXAS
( )	RECORD INFORMATION

E. VILLAREAL SURVEY  
ABSTRACT NO. 1

VICINITY MAP

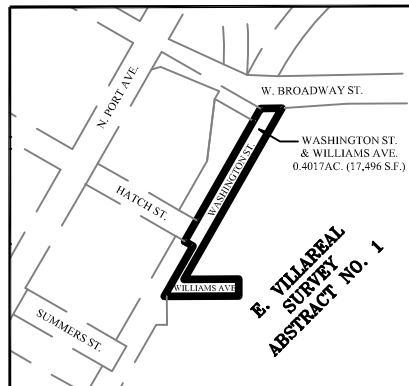

LINE TABLE		
NUMBER	DIRECTION	LENGTH
L1	S00°24'38"E	35.04'
L2	N60°04'52"W	20.18'

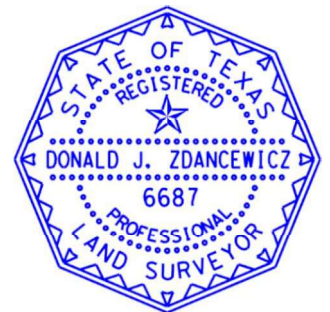

SURVEYORS CERTIFICATE

*Donald J. Zdanciewicz*  
DONALD J. ZDANCEWICZ  
REGISTERED PROFESSIONAL LAND SURVEYOR  
NO. 6687 - STATE OF TEXAS  
DATE  
12-6-2024

JOB NUMBER: 1022069506C  
DATE: SEPTEMBER 9, 2024  
SCALE: 1"=50'  
SURVEYOR: D. ZDANCEWICZ  
TECHNICIAN: J. BRADSHAW  
DRAWING: WASHINGTON & WILLIAMS STREET.dwg  
TRACT ID: N/A  
PARTY CHIEF: C. HERNANDEZ  
FIELDBOOKS: 42786



4801 Southwest Parkway  
Building Two, Suite 100  
Austin, Texas 78735  
Ofc: 512.447.0575  
Fax: 512.326.3029  
email: info@sam.biz

Texas Firm Registration No. 10064300

PROJECT: PORT OF CORPUS CHRISTI  
STREET CLOSURES

SHEET 1  
OF 1

Being a portion of Williams Avenue lying between Lots 1 through 7, Block 3, and Lot 1, Block 1, Primrose Heights, and a portion of Washington Street lying between Lots 1 through 16, Block 1, Primrose Heights and the West line of Primrose Heights, according to the map or plat thereof recorded in Volume 4, Page 41, Map and Plat Records of Nueces County, Texas, said portion of Williams Avenue and Washington Street being more particularly described by metes and bounds as follows:

BEGINNING at a 5/8" Rebar with plastic cap stamped "SAM" previously set at the intersection of the east line of Washington Street and the south line of W. Broadway Street, for the northwest corner of a called 20.58 acre tract of land listed as Tract 4 and described in Document No. 2023020607, Official Public Records of Nueces County, Texas, (said point being formerly the northwest corner of Lot 16, Block 1, Primrose Heights), for the northeast corner of the tract described herein;

THENCE S 29°46'46" W, a distance of 410.92 feet, along the West lines of said called 20.58 acre tract of land, (said line being formerly the West lines of Lots 1 through 16, Block 1, Primrose Heights), to a 5/8" Rebar found at the intersection of said East line of Washington Street and the North line of Williams Avenue, for a corner of said called 20.58 acre tract of land, (said point being formerly the Southwest corner of Lot 11, Block 1, Primrose Heights), and an interior corner of the tract described herein;

THENCE N 89°44'04" E, a distance of 114.14 feet, along said North line of Williams Avenue, to a 5/8" Rebar found for a northeast corner of the tract described herein;

THENCE S 00°24'38" E, a distance of 35.04 feet, through Williams Avenue to a 5/8" Rebar found in the South line of Williams Avenue, for a corner of said called 20.58 acre tract of land, and the southeast corner of the tract described herein;

THENCE S 89°42'05" W, at a distance of 150.00 feet passing a 5/8" Rebar found at a corner of said called 20.58 acre tract of land, (said point being formerly the northeast corner of Lot 1, block 3, Primrose Heights), for a total distance of 155.31 feet to a 5/8" Rebar with plastic cap stamped "SAM" previously set for the Southwest corner of the tract described herein;

THENCE through Washington Street, with the West lines of the tract described herein, the following two (2) courses and distances:

- 1) N 29°48'02" E, a distance of 120.96 feet, through Washington Street to a 5/8" Rebar with plastic cap stamped "SAM" previously set for an interior corner of the tract described herein, and
- 2) N 60°04'52" W, a distance of 20.18 feet, through Washington Street to a 5/8" Rebar with plastic cap stamped "SAM" previously set in the West line of Washington Street for the Northeast corner of Lot 5, Block 2, John G. Hatch Addition, and for a West corner of the tract described herein;

THENCE N 29°48'02" E, at a distance of 49.93 feet passing a 5/8" Rebar with plastic cap stamped "SAM" previously set at the Southeast corner of Lot 6, Block 1, John G. Hatch Addition, at a distance of 287.85 feet passing a 5/8" Rebar with plastic cap stamped "SAM" previously set at the southeast corner of a portion of Lot 5, Block 1, John G. Hatch Addition, previously dedicated for

Street Purposes, for a total distance of 317.85 feet to a 5/8" Rebar with plastic cap stamped "SAM" set for the Northeast corner of Lot 5, Block 1, John G. Hatch Addition, and the Northwest corner of the tract described herein;

THENCE N 84°32'29" E, a distance of 44.44 feet, to the POINT OF BEGINNING and CONTAINING 0.4356 of one acre (18,974 square feet) of land, more or less.



SAM, LLC  
4801 Southwest Pkwy  
Building Two, Suite 100  
Austin, Texas 78735  
TX Firm No. 10064300

 12-6-2024  
Donald J. Zdancewicz Date  
Registered Professional Land Surveyor  
No. 6687 - State of Texas

2101 W Broadway

**DEED WITHOUT WARRANTY**

**Date:**

June 7, 2023

**GRANTOR:**

GREENFIELD ENVIRONMENTAL MULTISTATE TRUST LLC, not individually but solely in its representative capacity as TRUSTEE OF THE MULTISTATE ENVIRONMENTAL RESPONSE TRUST

**Grantor's Mailing**

**Address:**

11 Flagg St., Unit No. 1, Cambridge, Middlesex County, MA 02138

**GRANTEE:**

PORT OF CORPUS CHRISTI AUTHORITY OF NUECES COUNTY, TEXAS

**Grantee's Mailing**

**Address:**

P. O. Box 1541  
Corpus Christi, Texas 78403

**CONSIDERATION:** Ten Dollars (\$10.00) and other good and valuable consideration

**PROPERTY:**

Eight (8) tracts of land more particularly described on Exhibit A attached hereto and made a part hereof (hereinafter referred to as the "Property")

**RESERVATIONS FROM AND EXCEPTIONS TO CONVEYANCE AND WARRANTY:**

This conveyance is made and accepted subject to any and all restrictions, covenants, exceptions, reservations, easements, rights-of-way, conflicts, encroachments, area and boundary discrepancies, taxes, liens, assessments, charges, claims and encumbrances affecting the property hereby conveyed on the ground or as reflected in the Public Records or otherwise. As evidenced by the acceptance of the delivery of this Deed Without Warranty and the recordation of same in the Real Property Records of Nueces County, Texas, Grantee accepts the conveyance of the Property in its "As-Is", "Where Is" and "With All Faults" condition, and subject to the terms and conditions contained in the Transfer Agreement by and between Grantor and Grantee recorded concurrently herewith.

Grantor, for the consideration herein expressed and other good and valuable consideration, the receipt and sufficiency of which is hereby acknowledged by Grantor, has granted, sold and conveyed, and by these presents does grant, sell and convey unto Grantee, the Property, together with all and singular the rights and appurtenances thereto in anywise belonging, subject to the reservations and exceptions and the Property condition hereinabove set forth.

TO HAVE AND TO HOLD the Property and premises unto Grantee and Grantee's successors and assigns forever. This conveyance is made without warranty, express or implied.

Ad valorem taxes for the current year having been prorated as of the date of this conveyance, payment thereof is expressly assumed by Grantee, as evidenced by Grantee's

acceptance of the delivery hereof and the recordation hereof in the Real Property records of Nueces County, Texas.

EXECUTED as of the date and year first above written.

Greenfield Environmental Multistate Trust LLC,  
not individually but solely in its representative capacity as  
Trustee of the Multistate Environmental Response Trust

By: Greenfield Environmental Trust Group, Inc., Member

By:   
Name: Cynthia Brooks  
Title: President

State of Massachusetts §  
§  
County of Middlesex §

On this 7<sup>th</sup> day of June, 2023, before me, the undersigned notary public, personally appeared Cynthia Brooks, proved to me through satisfactory evidence of identification, which were Mass Drivers License, to be the person whose name is signed on the preceding document, and acknowledged to me that she signed it voluntarily for its stated purpose as President of Greenfield Environmental Trust Group, Inc., Member of Greenfield Environmental Multistate Trust LLC, Trustee of the Multistate Environmental Response Trust.

Notary Public   
Name: \_\_\_\_\_  
My commission expires: 9-20-2024

Upon Recording Return to:  
Sam Esquivel  
Director of Real Estate Services  
Port of Corpus Christi Authority of Nueces County, Texas  
400 Harbor Drive  
Corpus Christi, Texas 78401

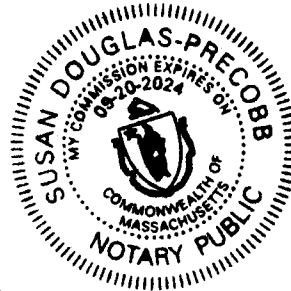



**EXHIBIT "A"**

**TRACT 1:    0.739-Acre Tract (East of Port Avenue, South of Summers Street)**

Being a tract containing 0.739 acres of land, more or less, being the north 68.75' and east 45' of Lot 1, Block 3, the north 68.75' of Lots 2-4, Block 3, the north 68.5' and west 19.5' of Lot 5, Block 3 of the John G. Hatch Subdivision recorded in Volume A, Page 4 and Lot 5A, Block 3, John G. Hatch Subdivision recorded in Volume 37, Page 152, Map Records of Nueces County Texas and this 0.739-acre tract being more particularly described by metes and bounds as follows:

BEGINNING at a set 5/8 iron rod for the Northwest corner of this tract, said point being at the intersection of the present east right of way line of Port Avenue with the south right of way line of Summers Street and said corner having a State Plane Grid Coordinate of N:17,182,628.98', E:1,336,524.20', NAD'83, Texas South Zone in U. S. feet and bearing S 60-12-41 E, 5.00 feet, from the northwest corner of said Lot 1;

THENCE S 60-12-41 E with the north boundary of this tract, same being the south right of way line of Summers St., 214.50 feet, to a set 5/8 iron rod for the Northeast corner of this tract;

THENCE S 29-47-19 W the East boundary of this tract, at 68.75 feet pass the northeast corner of said Lot 5A, in all 150.00 feet, to a set 5/8 iron rod for the Southeast corner of this tract, same being the southeast corner of said Lot 5A and the northeast corner of Lot 10A recorded Volume 26, Page 80, M.R.N.C.T.;

THENCE N 60-12-41 W with the south boundary of this tract, same being the north boundary of said Lot 10A, 214.50 feet, to a set 5/8 iron rod for the southwest corner of this tract, same being the northwest corner of said Lot 10A, and being on the present east right of way line of said Port Avenue;

THENCE N 29-47-19 E with the west boundary of this tract, the same being the present east right of way line of Port Avenue, at 81.25 feet pass the northwest corner of said Lot 5A, in all, 150.00 feet, to the POINT OF BEGINNING and containing 0.739 acres of land, more or less.

**TRACT 2:    1.271-Acre Tract (East of Port Avenue, North of Summers Street)**

Being a tract containing 1.271 acres of land, more or less, being east 45.00 feet of Lots 1 and 10, all of Lots 2-4, and 7-9 and west 26.5' of Lots 5&6, Block 2, John G. Hatch Subdivision recorded Volume A, Page 4, Map Records of Nueces County, and this 1.271-acre tract being more particularly described by metes and bounds as follows:

BEGINNING at a set 5/8 iron rod for the northwest corner of this tract, said corner being at the intersection of the present east right of way line of Port Avenue with the south right of way line of Hatch Street, said corner bearing S 60-12-41 E, 5.00 feet, from the northwest corner of said Lot 1 and having a State Plane Grid Coordinate of N:17,182,898.03', E:1,336,678.21', NAD'83, Texas South Zone in U. S. feet;

THENCE S 60-12-41 E with the north boundary of this tract, same being the south right of way of Hatch Street, 221.50 feet, to a set 5/8 iron rod for the Northeast corner of this tract;

THENCE, S 29-47-19 W with the east boundary of this tract, at 125.00 feet pass the south boundary of said Lot 5, the same being the north boundary of said Lot 6, in all 250.00 feet to a set 5/8 iron rod for the southeast corner of this tract, said corner being on the north right of way line of Summers Street;

THENCE N 60-12-41 W with the south boundary of this tract, same being the north right of way of Summers St., 221.50 feet, to a set "x" scribe in concrete for the southwest corner of this tract, said corner being at the intersection of the north right of way line of Summers Street with the present east right of way line of said Port Avenue;

THENCE N 29-47-19 E with the west boundary of this tract, same being present east right of way lien of said Port Avenue, at 125.00 feet pass the north boundary of Lot 10, the same being the present south boundary of said Lot 1, in all 250.00 feet, to the POINT OF BEGINNING and containing 1.271 acres of land, more or less.

**TRACT 3: 2.55-Acre Tract (East of Union Pacific Railroad Right-of-Way, North of W. Broadway Street)**

Being a tract containing 2.55 acres of land, more or less, out of a 2.98-acre Parcel One recorded in Document No. 2011006797, Official Public Records Nueces County, Texas and being out of the allotted John Priour 7-acre tract in the partition of the J.M. Priour 115-acre tract and this 2.55-acre tract being more particularly described by metes and bounds as follows:

BEGINNING at a found 2 inch iron pipe for the west corner of this tract and said 2.98 acre tract, said corner having a State Plane Grid Coordinate of N:17,183,120.43', E:1,337,078.33', NAD'83, Texas South Zone in U. S. feet and being at the intersection of the east right of way line of a fifty foot wide Union Pacific Railroad right of way with the north right of way line of West Broadway Street, said railroad right of way granted to S.A.U & G. Railway by deed recorded in Volume 186, Page 119, Deed Records of Nueces County, Texas;

THENCE with the north boundary of this tract and the south right of way line of said railroad R.O.W. along a curve to the right having a central angle of 45-40-14, a radius of 612.28 feet, a curve length of 488.05 feet, and long chord bearing of N 50-50-26 E, 475.23 feet, to a found 2 inch iron pipe for the North corner of this tract;

THENCE with the north boundary of this tract, S 76-04-27 E, 212.62 feet, to a found 1 inch iron pipe for the East corner of this tract;

THENCE with the east boundary of this tract, S 24-07-19 W, 261.43 feet, to a found 5/8 iron rod, with plastic cap stamped "C.S. Muery", for the Southeast corner of this tract, said corner being on the north right of way line of West Broadway Street;

THENCE with the south boundary of this tract and the north right of way line of West

Broadway Street, S 87-57-51 W, 34.34 feet, to a found 2-inch iron pipe for a corner of this tract;

THENCE continuing with the south boundary of this tract and said north right of way of West Broadway Street, S 88-50-21 W, 298.64 feet, to a found 5/8 iron rod with a plastic cap stamped "C.S. Muery", for a corner of this tract;

THENCE continuing with the south boundary of this tract and said north right of way line of West Broadway Street, S 88-42-10 W, 135.16 feet, to the POINT OF BEGINNING, containing 2.55 acres of land, more or less.

**TRACT 4: 20.58-Acre Tract (East of Union Pacific Railroad Right-of-Way, South of W. Broadway Street)**

Being a tract containing 20.58 acres of land, more or less, being all of Parcel Two and portion of Parcel Three conveyed by Quitclaim Deed from Tronox Worldwide LLC to the Greenfield Environmental Multistate Trust LLC, recorded under Document #2011006797 of the Official Public Records of Nueces County, Texas and this 20.58-acre tract being more particularly described by metes and bounds as follows:

BEGINNING at a set 5/8-inch iron rod for the northeast corner of this tract, said corner being on the north boundary of said Parcel 3, the same being the south right of way line of West Broadway Street and said corner having a State Plane Grid Coordinate of N:17,183,087.81', E:1,337,664.74', NAD'83, Texas South Zone in U. S. feet and bearing N 81-20-08 E, 144.51 feet from the northeast corner of said Parcel 1, the same being the northwest corner of said Parcel Three;

THENCE S 22-47-23 W with the southeast boundary of this tract, same being the northwest boundary of Texas Department of Transportation (TxDOT) Harbor Bridge Project Parcel No. 325 containing 4.274 acres, as recorded in Document #2018048814, O.P.R.N.C.T., 1188.30 feet, to a found 5/8 iron rod with a 3 inch diameter aluminum TxDOT cap for a corner of this tract, said corner being on the northeast boundary of a TxDOT 14.43 acre tract recorded in Document No. 2017040523, O.P.R.N.C.T. and being the west corner of said TxDOT 4.274 acre tract;

THENCE N 89-56-35 W with the southeast boundary of this tract, same being a northwest boundary of said TxDOT 14.43-acre tract, 76.46 feet, to a found 5/8-inch iron rod for an interior corner of this tract;

THENCE S 43-58-33 W with the east boundary of this tract, and the west boundary of said TxDOT 14.43-acre tract, 88.52 feet, to a found concrete monument for an interior corner of this tract;

THENCE S 41-43-17 W and continuing with the east boundary of this tract and the west boundary of said TxDOT 14.43-acre tract, at a distance of 37.10 feet passing a found 5/8-inch iron rod, in all 42.10 feet to a point in a chain link fence on a 3-foot-tall concrete wall for an interior corner of this tract;

THENCE S 04-20-53 E and continuing along the east boundary of this tract and the west boundary of said TxDOT 14.43-acre tract, 85.52 feet, to a point in a chain link fence on a 3-foot-tall concrete wall for a corner of this tract;

THENCE S 24-23-37 W and continuing with the east boundary of this tract and the west boundary of said TxDOT 14.43-acre tract, at a distance of 17.21 feet pass a found 5/8-inch iron rod with a plastic cap stamped "CDS/MUERY S.A. TX", in all 131.04 feet to a found concrete monument for a corner of this tract;

THENCE S 29-27-07 W and continuing with the east boundary of this tract and the west boundary of said TxDOT 14.43-acre tract, 157.25 feet, to a set 5/8-inch iron rod for the southeast corner of this tract;

THENCE N 60-10-33 W with the south boundary of this tract, 101.83 feet, to a found 5/8-inch iron rod for a corner of this tract;

THENCE N 60-10-33 W and continuing with the south boundary of this tract, 248.38 feet, to a set 5/8-inch iron rod for a corner of this tract;

THENCE S 29-49-27 W, 124.71 feet, continuing along the South boundary of this tract, to a found 1 inch iron pipe for a corner of this tract;

THENCE N 60-10-33 W, 50.03 feet, continuing along the South boundary of this tract, to a set 5/8-inch iron rod for a corner of this tract;

THENCE N 29-49-27 E, 124.71 feet, continuing along the South boundary of this tract, to a found 1 inch iron pipe for an interior corner of this tract;

THENCE N 60-10-33 W, 99.53 feet, continuing along the South boundary of this tract, to a found 1 inch iron pipe for an interior corner of this tract;

THENCE N 29-49-27 E, 14.22 feet, continuing along the South boundary of this tract, to a set 5/8-inch iron rod for a corner of this tract;

THENCE S 89-33-25 W, 130.64 feet, continuing along the South boundary of this tract, to a set 5/8-inch iron rod in the East boundary line of the right of way of the San Antonio, Uvalde and Gulf Railroad for the Southwest corner of this tract;

THENCE, N 29-47-18 E, 534.68 feet, along the West boundary of this tract, same being the East boundary of said railroad R.O.W., to a set 5/8-inch iron rod for a corner of this tract;

THENCE, S 60-12-41 E, 16.00 feet, continuing along the West boundary of this tract, to a set 5/8-inch iron rod for an interior corner of this tract;

THENCE, N 29-47-18 E, 380.11 feet, continuing along the West boundary of this tract, same being the East boundary of said railroad R.O.W., to a set 5/8-inch iron rod for a corner of this tract;

THENCE, S 89-33-41 E, 22.10 feet, continuing along the West boundary of this tract, to a set 5/8-inch iron rod for an interior corner of this tract;

THENCE, N 00-16-41 W, 59.13 feet, continuing along the West boundary of this tract, to a set 5/8-inch iron rod for a corner of this tract;

THENCE, N 89-43-27 E, 150.00 feet, continuing along the West boundary of this tract, to a set 5/8-inch iron rod for an interior corner of this tract;

THENCE, N 00-16-41 W, 35.00 feet, continuing along the West boundary of this tract, to a set 5/8-inch iron rod for an interior corner of this tract;

THENCE, S 89-45-19 W, 118.90 feet, continuing along the West boundary of this tract, to a set 5/8-inch iron rod for a corner of this tract;

THENCE, N 29-47-18 E, 410.92 feet, continuing along the West boundary of this tract to a set 5/8-inch iron rod for the northwest corner of this tract, said corner being on the south right of way line of West Broadway Avenue;

THENCE, N 86-27-50 E, 131.98 feet, along the North boundary of this tract, same being the South boundary of West Broadway Street, to a set 5/8-inch iron rod for a corner of this tract;

THENCE, N 89-52-56 E, 306.83 feet, continuing along the North boundary, same being South right of way line of West Broadway Street, to a set 5/8-inch iron rod for a corner of this tract;

THENCE, N 81-20-08 E, 144.51 feet, continuing along the North boundary, same being the south right of way line of West Broadway Street to the point of beginning and containing 20.58 acres of land, more or less.

Said tract of land, also being described as follows: all of Parcel Two (18.34 acres) and a Portion of a 10.453 acre tract of land described as Parcel three in a Quitclaim Deed dated to be effective as of February 14, 2011 from Tronox Worldwide LLC (f/k/a Kerr-McGee Chemical Worldwide LLC, f/k/a Kerr-McGee Operating Corporation, f/k/a Kerr-McGee Corporation), a Delaware limited liability Company as Grantor to the Greenfield Environmental Multistate Trust LLC, a Delaware limited liability company, not individually, but solely in its representative capacity as trustee of the Multistate Environmental Response Trust, a New York Environmental Response Trust (hereinafter referred to as the "Multistate Trust"), as Grantee and recorded under clerk's Doc# 2011006797 of the Official Public Records of Nueces County, Texas. SAVE AND EXCEPT, from said 10.453-acre tract (Parcel three) the following two tracts of land:

- (i) 4.274 acres of land, more or less, more particularly described in that certain Deed Without Warranty dated September 20, 2018 from the Multistate

Trust to The State of Texas and recorded under clerk's Doc# 2018048814 of the Official Public Records of Nueces County, Texas; and

- (ii) 3.858 acres of land, more or less, more particularly described in that certain Deed Without Warranty dated June 15, 2018 from the Multistate Trust to The State of Texas and recorded under clerk's Doc# 2018026618 of the Official Public Records of Nueces County, Texas.

**TRACT 5:**    0.28-Acre Tract out of Craven Heights Addition (North of Nueces St):

0.28 acres of land, more or less, being all of Lots 13 and 14, Block 16, Craven Heights Addition, an Addition to the City of Corpus Christi, Nueces County, Texas, as shown by the map or plat thereof recorded in Volume A, Page 7 of the Map Records, Nueces County, Texas.

**TRACT 6:**    0.36-Acre Tract out of Craven Heights Addition (Winnebago St):

0.36 acres of land, more or less, being the East Twenty feet (E. 20') of Lot One (1), all of Lot Two (2), the East Twenty-four feet (E. 24') of Lot Three (3) and all of Lot Four (4), Block Six (6), Craven Heights Addition, an Addition to the City of Corpus Christi, Nueces County, Texas, as shown by the map or plat thereof recorded in Volume A, Page 7 of the Map Records, Nueces County, Texas, bearing the common address of Winnebago Street, Corpus Christi, Texas.

**TRACT 7:**    0.14-Acre Tract out of Craven Heights Addition (1925 Nueces St):

0.14 acres of land, more or less, being all of Lot 1, Block 15, Craven Heights Addition, an Addition to the City of Corpus Christi, Nueces County, Texas, as shown by the map or plat thereof recorded in Volume A, Page 7 of the Map Records, Nueces County, Texas, bearing the common address of 1925 Nueces Street, Corpus Christi, Texas.

**TRACT 8:**    0.14-Acre Tract out of Craven Heights Addition (1905 Nueces St):

0.14 acres of land, more or less, being all of Lot 5, Block 15, Craven Heights Addition, an Addition to the City of Corpus Christi, Nueces County, Texas, as shown by the map or plat thereof recorded in Volume A, Page 7 of the Map Records, Nueces County, Texas, bearing the common address of 1905 Nueces Street, Corpus Christi, Texas.

**Nueces County  
Kara Sands  
Nueces County  
Clerk**

---

**Instrument Number:** 2023020607

eRecording - Real Property

DEED

Recorded On: June 09, 2023 09:07 AM

Number of Pages: 9

---

**" Examined and Charged as Follows: "**

Total Recording: \$49.00

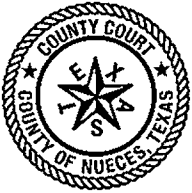

**STATE OF TEXAS  
NUECES COUNTY**

**I hereby certify that this Instrument was FILED In the File Number sequence on the date/time printed hereon, and was duly RECORDED in the Official Records of Nueces County, Texas.**

Kara Sands  
Nueces County Clerk  
Nueces County, TX

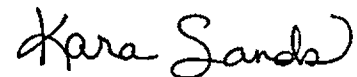

---

**\*\*\*\*\* THIS PAGE IS PART OF THE INSTRUMENT \*\*\*\*\***

Any provision herein which restricts the Sale, Rental or use of the described REAL PROPERTY because of color or race is invalid and unenforceable under federal law.

**File Information:**

Document Number: 2023020607  
Receipt Number: 20230609000016  
Recorded Date/Time: June 09, 2023 09:07 AM  
User: Lisa C  
Station: CLERK11

**Record and Return To:**

Simplifile  
484 North 300 West, Suite 202  
Provo UT

2501 - 2503 N Port

**RECORDING REQUESTED BY AND  
WHEN RECORDED, RETURN TO:**

Port of Corpus Christi Authority of Nueces County, Texas  
Attn: Kent Britton  
P.O. Box 1541  
Corpus Christi, Texas 78403

---

*(Space Above for Recorder's Use Only)*

**NOTICE OF CONFIDENTIALITY RIGHTS: IF YOU ARE A NATURAL PERSON, YOU MAY REMOVE OR STRIKE ANY OR ALL OF THE FOLLOWING INFORMATION FROM ANY INSTRUMENT THAT TRANSFERS AN INTEREST IN REAL PROPERTY BEFORE IT IS FILED FOR RECORDING IN THE PUBLIC RECORDS: YOUR SOCIAL SECURITY NUMBER OR YOUR DRIVER'S LICENSE NUMBER.**

2816-53

**DEED WITHOUT WARRANTY**

STATE OF TEXAS                    )  
                                              )     KNOW ALL MEN BY THESE PRESENTS:  
COUNTY OF NUECES            )

**UNION PACIFIC RAILROAD COMPANY**, a Delaware corporation (formerly known as Southern Pacific Transportation Company, a Delaware corporation, successor in interest through merger with Union Pacific Railroad Company, a Utah corporation, successor in interest through merger with Missouri Pacific Railroad Company, a Delaware corporation, successor in interest through merger with Missouri Pacific Railroad Company, a Missouri corporation, successor in interest through merger with San Antonio, Uvalde and Gulf Railroad Company, a Texas corporation) ("Grantor"), for and in consideration of Ten Dollars (\$10.00) and other good and valuable consideration, to it in hand paid by **PORT OF CORPUS CHRISTI AUTHORITY OF NUECES COUNTY, TEXAS** ("Grantee"), the receipt of which is hereby acknowledged, has granted, sold and conveyed, and by these presents does grant, sell and convey to Grantee, the strip or tract of land lying in Nueces County, State of Texas, described in **Exhibit A**, attached hereto and made a part hereof ("Property").

EXCEPTING from this conveyance and RESERVING unto Grantor, its successors and assigns, forever, the following:



(a) All minerals and all mineral rights of every kind and character now known to exist or hereafter discovered underlying the Property, including without limiting the generality of the foregoing, oil and gas and rights thereto, together with the sole, exclusive and perpetual rights to explore for, remove and dispose of said minerals by any means or methods suitable to Grantor, its successors and assigns, but without entering upon or using the surface of the Property, and in such manner as not to damage the surface of the Property, or to interfere with the use thereof by Grantee, its successors and assigns; PROVIDED, HOWEVER, that Grantor, its successors or assigns, without the prior written permission of Grantee, its successors or assigns, which permission may be withheld in Grantee's sole and absolute discretion, shall not conduct any mining activities of whatsoever nature above a plane five hundred feet (500') below the surface of the Property (the "500' Plane"); All rights of ingress and egress, and surface use above the 500' Plane for the exploration, production, and transportation of minerals underlying the Property are hereby waived;

(b) All existing pipeline and appurtenant facilities, whether owned by Grantor or any third party, and a PERPETUAL EASEMENT upon, over, along, under and across the portion of the Property that lies five feet (5') on each side of the centerline of such existing pipeline and appurtenant facilities (the "Easement Area"), for the purposes of constructing, maintaining, repairing, operating, renewing, replacing, using and/or removing pipeline and appurtenant facilities (whether now or hereafter installed, and including facilities which are the technological successor to any existing or hereafter installed facilities) together with: (i) the right of ingress and egress to and from the Easement Area, at those points where the Easement Area intersects with now existing public roads; and (ii) with respect to the easement rights herein reserved the right to collect rents, issues and profits therefrom, and from any now existing contracts. In addition to and not in limitation of Grantor's rights under the foregoing reservation of easement, Grantee, for itself, its successors and assigns, hereby covenants and agrees that Grantee shall not unreasonably interfere with the rights of Grantor's Licensee under that certain License Agreement between Missouri Pacific Railroad Company and Celanese Corporation of America dated March 17, 1966, identified in the records of Grantor as Audit Number CA60744 and granting certain rights to said Licensee to use the Property for two 4 inch in diameter longitudinal pipeline encroachment on railroad right of way (the "Celanese License"). Grantor hereby agrees that the Grantee has the right to construct roads and driveways (hereinafter "Crossings") across the Easement Area reserved by Grantor provided that such crossings are constructed in a manner to protect the two (2) pipelines within the Easement from damage caused by trucks, cars, and other vehicles crossing over the Easement; and

(c) One (1) signboard and appurtenances thereto (collectively, "Signboard"), including, without limitation, any and all wirelines for electrical service to the Signboard, now located upon, along, under and across the Property, and RESERVING unto Grantor, its successors and assigns, a PERPETUAL EASEMENT for the construction, maintenance, operation, repair, replacement, renewal and reconstruction of the Signboard (whether now or hereafter constructed) upon, along,

under and across the portion of the Property which is the current location of the Signboard and within a radius five feet (5') outside the perimeter of the land surface directly below the Signboard ("Sign Shadow") and any poles or footings if outside the Sign Shadow, together with (i) the right of unobstructed access, ingress and egress along that portion of the Property between said easement area and the right-of-way for Martin Luther King Dr. (a/ka/ Buffalo St.), for the purpose of exercising the rights herein reserved; and (ii) a right of ingress and egress along any existing roadway used for access to the Signboard; and (iii) a sight of line easement for unobstructed view from the I-37 Access Road to the Signboard now or hereafter on said easement area.

The Property is conveyed by Grantor subject to the following covenant, condition and restriction which Grantee, by the acceptance of this instrument, covenants for itself, its successors and assigns, faithfully to keep, observe and perform:

Restriction on Use. The Property must not be used for (i) residential, (ii) lodgings or accommodations (including, without limitation, hotels, motels, boarding houses, dormitories, hospitals, nursing homes, or retirement centers), or (iii) educational or child-care facilities (including, without limitation, schools, kindergartens or day-care centers).

The foregoing and following covenants, conditions, and restrictions shall run with the Property, the burdens of which will be binding on the successors and assigns of Grantee and the benefits of which will inure to the successors and assigns of Grantor. A breach of the foregoing and following covenants, conditions, and restrictions, or the continuance thereof, may, at the option of Grantor, its successors or assigns, be enjoined, abated, or remedied by appropriate proceedings.

**Environmental Covenants:**

(a) As Is Sale. Grantee acknowledges and agrees that the Property is conveyed by Grantor and accepted by Grantee in an "as is" condition with all faults. Grantee further acknowledges that the Property was used for railroad, commercial and industrial purposes. Grantor makes no representation or warranties of any kind whatsoever, either express or implied, with respect to the Property; in particular, but without limitation, Grantor makes no representations or warranties with respect to the use, condition, title, occupation or management of the Property, or compliance with applicable statutes, laws, codes, ordinances, regulations, requirements, covenants, conditions and restrictions (whether or not of record). Grantee acknowledges that it is executing this instrument on the basis of Grantee's own investigation of the physical and environmental conditions of the Property, including the subsurface conditions, and Grantee assumes the risk that adverse physical and environmental conditions may not have been revealed by its investigation.

(b) **FROM AND AFTER THE DATE OF THIS INSTRUMENT, GRANTEE WILL, TO THE MAXIMUM EXTENT PERMITTED BY LAW, RELEASE GRANTOR, AND, TO THE MAXIMUM EXTENT PERMITTED BY LAW, INDEMNIFY, DEFEND AND SAVE HARMLESS GRANTOR, ITS**

**AFFILIATES, THEIR EMPLOYEES, AGENTS, OFFICERS, SUCCESSORS AND ASSIGNS, FROM AND AGAINST ANY AND ALL SUITS, ACTIONS, CAUSES OF ACTION, LEGAL OR ADMINISTRATIVE PROCEEDINGS, CLAIMS, DEMANDS, FINES, PUNITIVE DAMAGES, LOSSES, COSTS, LIABILITIES AND EXPENSES, INCLUDING ATTORNEYS' FEES, IN ANY WAY ARISING OUT OF OR CONNECTED WITH THE KNOWN OR UNKNOWN CONDITION OF THE PROPERTY (INCLUDING, WITHOUT LIMITATION, ANY CONTAMINATION IN, ON, UNDER OR ADJACENT TO THE PROPERTY BY ANY HAZARDOUS OR TOXIC SUBSTANCE OR MATERIAL), OR ANY FEDERAL, STATE OR LOCAL LAW, ORDINANCE, RULE OR REGULATION APPLICABLE THERETO, INCLUDING, WITHOUT LIMITATION, THE TOXIC SUBSTANCES CONTROL ACT, THE COMPREHENSIVE ENVIRONMENTAL RESPONSE, COMPENSATION AND LIABILITY ACT, AND THE RESOURCE CONSERVATION AND RECOVERY ACT. THE FOREGOING WILL APPLY REGARDLESS OF ANY NEGLIGENCE OR STRICT LIABILITY OF GRANTOR, ITS AFFILIATES, OR THEIR EMPLOYEES, AGENTS OR OFFICERS.**

This conveyance is made without any warranty, express or implied, including, without limitation, any warranty or covenant implied under the provisions of Section 5.023 of the Texas Property Code, which provisions are hereby expressly waived by Grantee even as to the return of the purchase price.

*(Remainder of page intentionally left blank. Signatures on following pages.)*

IN WITNESS WHEREOF, Grantor has caused these presents to be signed by its duly authorized officers this 25<sup>th</sup> day of September, 2024.

Attest:

**UNION PACIFIC RAILROAD COMPANY,  
a Delaware corporation**

  
Assistant Secretary

By:   
Printed Name: Michael S. Wohlwend  
Title: Assistant Vice President – Real Estate

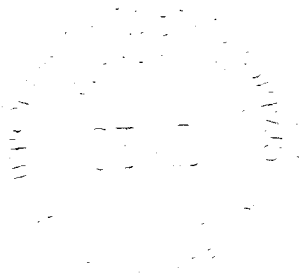

STATE OF NEBRASKA   )  
                                          ) ss.  
COUNTY OF DOUGLAS   )

This instrument was acknowledged before me this 25<sup>th</sup> day of September, 2024, by Michael S. Wohlwend and Mark Jensen, Assistant Vice President – Real Estate and Assistant Secretary of UNION PACIFIC RAILROAD COMPANY, a Delaware corporation, on behalf of the corporation.

WITNESS my hand and official seal.

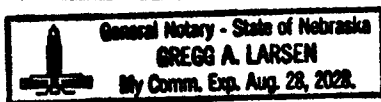

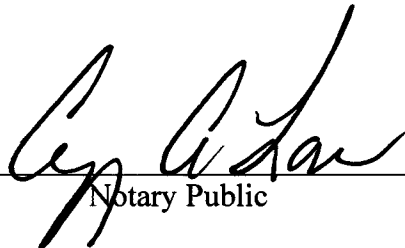
  
Notary Public

(Seal)

Grantee hereby accepts this instrument and agrees for itself, its successors and assigns, to be bound by the covenants set forth herein.

Dated this 7<sup>th</sup> day of October, 2024.

**PORT OF CORPUS CHRISTI AUTHORITY  
OF NUECES COUNTY, TEXAS**

By: [Signature]  
Printed Name: Kent Britton  
Title: CEO

STATE OF TEXAS       )  
                                  ) ss.  
COUNTY OF NUECES   )

This instrument was acknowledged before me on October 7, 2024,  
by Kent A Britton, Chief Executive Officer of PORT  
OF CORPUS CHRISTI AUTHORITY OF NUECES COUNTY, TEXAS, on behalf of said entity.

WITNESS my hand and official seal.

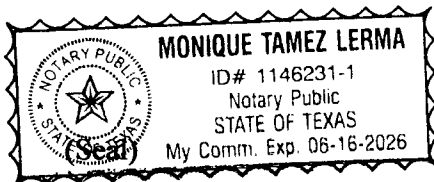

[Signature]  
Notary Public

**EXHIBIT A**

**LEGAL DESCRIPTION OF THE PROPERTY**

**METES & BOUNDS DESCRIPTION TRACT I:**

DESCRIPTION OF 0.5494 OF ONE ACRE (23,933 SQUARE FEET) OF LAND OUT OF THE ENRIQUEZ VILLAREAL SURVEY, ABSTRACT 1, NUECES COUNTY, TEXAS DESCRIBED AS FOURTH TRACT, 0.57 OF AN ACRE OF LAND, IN DEED TO SAN ANTONIO, UVALDE & GULF RAILROAD COMPANY, OF RECORD IN VOLUME 194, PAGE 77, DEED RECORDS OF NUECES COUNTY, TEXAS. SAID 0.5494 ACRE TRACT BEING MORE PARTICULARLY DESCRIBED AS FOLLOWS:

BEGINNING AT A 5/8" IRON ROD WITH PLASTIC CAP STAMPED "BRISTER SURVEYING" FOUND IN THE NORTHWEST RIGHT-OF-WAY LINE OF PORT AVENUE, FOR THE SOUTHEAST CORNER OF TRACT 1, SALT FLAT TRACTS, LOCATED IN CORPUS CHRISTI, NUECES COUNTY, TEXAS, ACCORDING TO THE MAP OR PLAT THEREOF RECORDED IN VOLUME 29, PAGE 34, MAP RECORDS OF NUECES COUNTY, TEXAS, AND FOR THE NORTH CORNER OF THE TRACT DESCRIBED HEREIN;

THENCE S 54°31'39" W, WITH SAID NORTHWEST LINE OF PORT AVENUE, A DISTANCE OF 45.88 FEET TO A 5/8" IRON ROD WITH PLASTIC CAP STAMPED "SAM" PREVIOUSLY SET FOR THE SOUTHEAST CORNER OF A CALLED 5.00 ACRES OF LAND, DESCRIBED IN SPECIAL WARRANTY DEED TO PORT OF CORPUS CHRISTI AUTHORITY IN DOCUMENT NO. 814472, OFFICIAL PUBLIC RECORDS OF NUECES COUNTY, TEXAS, FOR THE SOUTHWEST CORNER OF THE TRACT DESCRIBED HEREIN;

THENCE WITH THE EAST LINE OF SAID CALLED 5.00 ACRES OF LAND AND THE WEST LINE OF THE TRACT DESCRIBED HEREIN THE FOLLOWING SIX (6) COURSES AND DISTANCES:

1. NORTH 23°17'01" WEST, A DISTANCE OF 101.95 FEET TO A 5/8" IRON ROD WITH PLASTIC CAP STAMPED "BRISTER SURVEYING" FOUND FOR AN ANGLE POINT,
2. NORTH 31°09'51" WEST, A DISTANCE OF 99.73 FEET TO A 5/8" IRON ROD WITH PLASTIC CAP STAMPED "BRISTER SURVEYING" FOUND FOR AN ANGLE POINT,
3. NORTH 42°12'04" WEST, A DISTANCE OF 99.64 FEET TO A 5/8" IRON ROD WITH PLASTIC CAP STAMPED "BRISTER SURVEYING" FOUND FOR AN ANGLE POINT,
4. NORTH 43°32'48" WEST, A DISTANCE OF 100.00 FEET TO A 5/8" IRON ROD WITH PLASTIC CAP STAMPED "BRISTER SURVEYING" FOUND FOR AN ANGLE POINT,
5. NORTH 51°11'56" WEST, A DISTANCE OF 99.98 FEET TO A 5/8" IRON ROD WITH PLASTIC CAP STAMPED "SAM" SET FOR AN ANGLE POINT, AND

6. NORTH 57°59'31" WEST, A DISTANCE OF 77.96 FEET TO A 5/8" IRON ROD WITH PLASTIC CAP STAMPED "SAM" PREVIOUSLY SET IN THE SOUTH RIGHT-OF-WAY LINE OF UNION PACIFIC RAILROAD, FOR THE NORTHEAST CORNER OF SAID CALLED 5.00 ACRES OF LAND, AND THE NORTHWEST CORNER OF THE TRACT DESCRIBED HEREIN;

THENCE S 71°34'51" E, WITH SAID SOUTH LINE OF UNION PACIFIC RAILROAD AND THE NORTH LINE OF THE TRACT DESCRIBED HEREIN, A DISTANCE OF 160.94 FEET TO A 5/8" IRON ROD WITH PLASTIC CAP STAMPED "SAM" PREVIOUSLY SET FOR THE NORTHWEST CORNER OF TRACT 1, SALT FLAT TRACTS, LOCATED IN CORPUS CHRISTI, NUECES COUNTY, TEXAS, ACCORDING TO THE MAP OR PLAT THEREOF RECORDED IN VOLUME 29, PAGE 34, MAP RECORDS OF NUECES COUNTY, TEXAS, AND THE NORTHEAST CORNER OF THE TRACT DESCRIBED HEREIN, FROM WHICH A 5/8" IRON ROD WITH PLASTIC CAP STAMPED "BRISTER SURVEYING" FOUND BEARS WITH THE ARC OF A CURVE TO THE RIGHT, WHOSE RADIUS IS 5,779.70 FEET, WHOSE ARC DISTANCE IS 545.72 FEET AND WHOSE CHORD AND CHORD BEARING ARE S 72°32'15" E, A DISTANCE OF 545.52 FEET;

THENCE WITH THE ARC OF A CURVE TO THE RIGHT, HAVING A RADIUS OF 789.08 FEET, AN ARC DISTANCE OF 441.04 FEET, AND A CHORD WHICH BEARS S 36°05'22" E, A DISTANCE OF 435.32 FEET, WITH THE WEST LINE OF SAID TRACT 1, SALT FLAT TRACTS, AND THE EAST LINE OF THE TRACT DESCRIBED HEREIN, TO THE POINT OF BEGINNING AND CONTAINING 0.5494 ACRES OF LAND, MORE OR LESS.

#### METES & BOUNDS DESCRIPTION TRACT II:

DESCRIPTION OF 0.2764 OF ONE ACRE (12,041 SQUARE FEET) OF LAND OUT OF THE ENRIQUEZ VILLAREAL SURVEY, ABSTRACT 1, NUECES COUNTY, TEXAS DESCRIBED AS THIRD TRACT, 0.265 OF AN ACRE OF LAND, IN DEED TO SAN ANTONIO, UVALDE & GULF RAILROAD COMPANY, OF RECORD IN VOLUME 194, PAGE 77, DEED RECORDS OF NUECES COUNTY, TEXAS. SAID 0.2764 ACRE TRACT BEING MORE PARTICULARLY DESCRIBED AS FOLLOWS:

BEGINNING AT A 5/8" IRON ROD WITH PLASTIC CAP STAMPED "BRISTER SURVEYING" FOUND IN THE SOUTHEAST RIGHT-OF-WAY LINE OF PORT AVENUE, FOR THE NORTHWEST CORNER OF TRACT 2, SALT FLAT TRACTS, LOCATED IN CORPUS CHRISTI, NUECES COUNTY, TEXAS, ACCORDING TO THE MAP OR PLAT THEREOF RECORDED IN VOLUME 29, PAGE 34, MAP RECORDS OF NUECES COUNTY, TEXAS, AND FOR THE NORTH CORNER OF THE TRACT DESCRIBED HEREIN;

THENCE WITH THE ARC OF A CURVE TO THE RIGHT, HAVING A RADIUS OF 789.08 FEET, AN ARC DISTANCE OF 263.00 FEET, AND A CHORD WHICH BEARS S 05°11'39" E, A DISTANCE OF 261.78 FEET, WITH THE WEST LINE OF SAID TRACT 2, SALT FLAT TRACTS, AND THE EAST LINE OF THE TRACT DESCRIBED HEREIN, TO A 5/8" IRON

ROD WITH PLASTIC CAP STAMPED "BRISTER SURVEYING" FOUND IN THE NORTH LINE OF W. BROADWAY STREET FOR THE SOUTHWEST CORNER OF SAID TRACT 2; THENCE N 65°32'25" W, WITH SAID NORTH LINE OF W. BROADWAY STREET, A DISTANCE OF 53.63 FEET TO A 5/8" IRON ROD WITH PLASTIC CAP STAMPED "SAM" PREVIOUSLY SET FOR THE SOUTHEAST CORNER OF A 12,894.5 SQUARE FEET TRACT OF LAND DESCRIBED IN WARRANTY DEED TO AGUIRRE PROPERTIES, INC. RECORDED IN DOCUMENT NO. 2006030458, OFFICIAL PUBLIC RECORDS OF NUECES COUNTY, TEXAS, FOR THE SOUTHWEST CORNER OF THE TRACT DESCRIBED HEREIN; THENCE WITH THE ARC OF A CURVE TO THE LEFT, HAVING A RADIUS OF 739.08 FEET, AN ARC DISTANCE OF 207.88 FEET, AND A CHORD WHICH BEARS N 05°41'20" W, A DISTANCE OF 207.20 FEET, WITH THE EAST LINE OF SAID 12,894.5 SQUARE FEET TRACT OF LAND, TO A 5/8" IRON ROD WITH PLASTIC CAP STAMPED "SAM" PREVIOUSLY SET IN THE SOUTH RIGHT-OF-WAY LINE OF PORT AVENUE FOR THE NORTHEAST CORNER OF SAID 12,894.5 SQUARE FEET TRACT OF LAND AND THE NORTHWEST CORNER OF THE TRACT DESCRIBED HEREIN;

THENCE N 54°41'58" E, WITH SAID SOUTH LINE OF PORT AVENUE AND THE NORTH LINE OF THE TRACT DESCRIBED HEREIN, A DISTANCE OF 55.95 FEET TO THE POINT OF BEGINNING AND CONTAINING 0.2764 ACRES OF LAND, MORE OR LESS.

#### METES & BOUNDS DESCRIPTION TRACT III:

DESCRIPTION OF 0.8982 OF ONE ACRE (39,126 SQUARE FEET) OF LAND OUT OF THE ENRIQUEZ VILLAREAL SURVEY, ABSTRACT 1, NUECES COUNTY, TEXAS; BEIGN ALL OF THE LAND DESCRIBED AS FIRST TRACT, 0.30 OF AN ACRE OF LAND, AND AS SECOND TRACT, 0.27 OF AN ACRE OF LAND, IN DEED TO SAN ANTONIO, UVALDE & GULF RAILROAD COMPANY, OF RECORD IN VOLUME 194, PAGE 77, DEED RECORDS OF NUECES COUNTY, TEXAS, AND 0.4 OF AN ACRE OF LAND, IN DEED TO SAN ANTONIO, UVALDE & GULF RAILROAD COMPANY, OF RECORD IN VOLUME 186, PAGE 119, DEED RECORDS OF NUECES COUNTY, TEXAS. SAID 0.8982 ACRE TRACT BEING MORE PARTICULARLY DESCRIBED AS FOLLOWS:

BEGINNING AT A 5/8" IRON ROD WITH PLASTIC CAP STAMPED "BRISTER SURVEYING" FOUND IN THE SOUTH RIGHT-OF-WAY LINE OF UNION PACIFIC RAILROAD, FOR THE NORTHEAST CORNER OF TRACT 2, SALT FLAT TRACTS, LOCATED IN CORPUS CHRISTI, NUECES COUNTY, TEXAS, ACCORDING TO THE MAP OR PLAT THEREOF RECORDED IN VOLUME 29, PAGE 34, MAP RECORDS OF NUECES COUNTY, TEXAS, AND FOR THE NORTHWEST CORNER OF THE TRACT DESCRIBED HEREIN;

THENCE S 65°59'59" E, WITH SAID SOUTH LINE OF UNION PACIFIC RAILROAD, A DISTANCE OF 138.60 FEET TO A 5/8" IRON ROD WITH PLASTIC CAP STAMPED "SAM" PREVIOUSLY SET FOR THE NORTHWEST CORNER OF THE J H HARVEY PROPERTY DESCRIBED IN DEED TO J. H. HARVEY, RECORDED IN VOLUME 199, PAGE 580, DEED RECORDS OF NUECES COUNTY, TEXAS, FOR THE NORTHEAST CORNER OF THE TRACT DESCRIBED HEREIN;



THENCE WITH THE ARC OF A CURVE TO THE LEFT, HAVING A RADIUS OF 612.28 FEET, AN ARC DISTANCE OF 772.18 FEET, AND A CHORD WHICH BEARS S 64°07'38" W, A DISTANCE OF 722.01 FEET, WITH THE WEST LINE OF SAID J H HARVEY PROPERTY AND THE WEST LINE OF A 2.55 ACRE TRACT DESCRIBED IN QUITCLAIM DEED TO GREENFIELD ENVIRONMENTAL MULTISTATE TRUST LLC RECORDED IN DOCUMENT NO. 2011006797, OFFICIAL PUBLIC RECORDS OF NUECES COUNTY, TEXAS, TO A 5/8" IRON PIPE FOUND IN THE NORTH LINE OF W. BROADWAY STREET FOR THE SOUTHWEST CORNER OF SAID 2.55 ACRE TRACT;

THENCE N 87°39'01" W, WITH SAID NORTH LINE OF W. BROADWAY STREET, A DISTANCE OF 64.51 FEET TO A 5/8" IRON ROD WITH PLASTIC CAP STAMPED "BRISTER SURVEYING" FOUND FOR THE SOUTH CORNER OF SAID TRACT 2 AND THE SOUTHWEST CORNER OF THE TRACT DESCRIBED HEREIN;

THENCE WITH THE ARC OF A CURVE TO THE RIGHT, HAVING A RADIUS OF 662.28 FEET, AN ARC DISTANCE OF 730.06 FEET, AND A CHORD WHICH BEARS N 57°52'52" E, A DISTANCE OF 693.65 FEET, WITH THE EAST LINE OF SAID TRACT 2, AND THE WEST LINE OF THE TRACT DESCRIBED HEREIN, TO THE POINT OF BEGINNING AND CONTAINING 0.8982 ACRES OF LAND, MORE OR LESS.

#### METES & BOUNDS DESCRIPTION TRACT IV:

DESCRIPTION OF 0.2908 OF ONE ACRE (12,669 SQUARE FEET) OF LAND OUT OF THE ENRIQUEZ VILLAREAL SURVEY, ABSTRACT 1, NUECES COUNTY, TEXAS, BEING ALL OF LOTS 5 AND 6, BLOCK 1, AND PORTION OF LOT 4, BLOCK 1, JOHN G. HATCH ADDITION, CITY OF CORPUS CHRISTI, NUECES COUNTY, TEXAS, ACCORDING TO THE MAP OR PLAT THEREOF RECORDED IN VOLUME A, PAGE 4, MAP AND PLAT RECORDS OF NUECES COUNTY, TEXAS, EXCEPT OF PORTIONS CONVEYED FOR STREET PURPOSES, DESCRIBED AS PARCEL NO. 1 A PARCEL NO. 2 IN DEED TO SAN ANTONIO, UVALDE & GULF RAILROAD COMPANY, OF RECORD IN VOLUME 191, PAGE 210, DEED RECORDS OF NUECES COUNTY, TEXAS; AND A 16 FOOT WIDE STRIP OFF OF LOTS 5 AND 6, BLOCK 1, JOHN G. HATCH ADDITION, DESCRIBED IN DEED TO SAN ANTONIO, UVALDE & GULF RAILROAD COMPANY, OF RECORD IN VOLUME 187, PAGE 13, DEED RECORDS OF NUECES COUNTY, TEXAS. SAID 0.2908 ACRE TRACT BEING MORE PARTICULARLY DESCRIBED AS FOLLOWS:

BEGINNING AT A 5/8" IRON ROD FOUND IN THE NORTH RIGHT-OF-WAY LINE OF HATCH STREET, FOR THE SOUTHEAST CORNER OF LOT 7, BLOCK 1, JOHN G. HATCH ADDITION, CITY OF CORPUS CHRISTI, NUECES COUNTY, TEXAS, ACCORDING TO THE MAP OR PLAT THEREOF RECORDED IN VOLUME A, PAGE 4, MAP AND PLAT RECORDS OF NUECES COUNTY, TEXAS, AND FOR THE SOUTHWEST CORNER OF LOT 6, BLOCK 1, AND FOR THE SOUTHWEST CORNER OF THE TRACT DESCRIBED HEREIN;

THENCE N 29°54'09" E, WITH THE EAST LINE OF SAID LOT 7, BLOCK 1, THE WEST LINE OF SAID LOT 6, BLOCK 1 AND THE WEST LINE OF THE TRACT DESCRIBED HEREIN, A

DISTANCE OF 107.50 FEET TO A 5/8" IRON ROD WITH PLASTIC CAP STAMPED "SAM" SET FOR THE NORTHEAST CORNER OF SAID LOT 7, BLOCK 1 AND THE NORTHWEST CORNER OF SAID LOT 6, BLOCK 1;

THENCE N 07°16'57" E, THROUGH LOT 4, BLOCK 1, A DISTANCE OF 130.00 FEET TO A 5/8" IRON ROD WITH PLASTIC CAP STAMPED "SAM" SET IN THE SOUTH RIGHT-OF-WAY LINE OF W. BROADWAY STREET, FOR THE NORTHEAST CORNER OF LOT 3, BLOCK 1, THE NORTHWEST CORNER OF SAID LOT 4, BLOCK 1 AND THE NORTHWEST CORNER OF THE TRACT DESCRIBED HEREIN;

THENCE S 60°05'51" E, WITH SAID SOUTH LINE OF W. BROADWAY STREET, THE NORTH LINES OF SAID LOT 4 AND LOT 5, BLOCK 1, AND THE NORTH LINE OF THE TRACT DESCRIBED HEREIN, A DISTANCE OF 92.50 FEET TO A 5/8" IRON ROD WITH PLASTIC CAP STAMPED "SAM" SET AT THE INTERESECTION OF THE SOUTH LINE OF W. BROADWAY STREET AND THE WEST LINE OF WASHINGTON STREET, FOR THE NORTHEAST CORNER OF LOT 5, BLOCK 1, AND THE NORTHEAST CORNER OF THE TRACT DESCRIBED HEREIN;

THENCE S 29°54'09" W, WITH THE WEST LINE OF SAID WASHINGTON STREET, THE EAST LINE OF SAID LOT 5 AND LOT 6, BLOCK 1, AND THE EAST LINE OF THE TRACT DESCRIBED HEREIN, A DISTANCE OF 227.50 FEET TO A 5/8" IRON ROD WITH PLASTIC CAP STAMPED "SAM" SET IN THE NORTH LINE OF HATCH STREET, FOR THE SOUTHEAST CORNER OF SAID LOT 6, BLOCK 1 AND THE SOUTHEAST CORNER OF THE TRACT DESCRIBED HEREIN;

THENCE N 60°05'51" W, WITH SAID NORTH LINE OF HATCH STREET, THE SOUTH LINE OF SAID LOT 6, BLOCK 1, AND THE SOUTH LINE OF THE TRACT DESCRIBED HEREIN, A DISTANCE OF 42.50 FEET TO THE POINT OF BEGINNING AND CONTAINING 0.2908 ACRES OF LAND, MORE OR LESS.

**METES & BOUNDS DESCRIPTION TRACT V:**

DESCRIPTION OF 0.6553 OF ONE ACRE (28,547 SQUARE FEET) OF LAND OUT OF THE ENRIQUEZ VILLAREAL SURVEY, ABSTRACT 1, NUECES COUNTY, TEXAS, BEING A 16 FOOT STRIP OF LAND OFF OF THE WEST SIDE OF SUVEY NO. 469 OF THE J.M. PRIOUR TRACT, DESCRIBED IN DEED TO SAN ANTONIO, UVALDE & GULF RAILROAD COMPANY, OF RECORD IN VOLUME 183, PAGE 321, DEED RECORDS OF NUECES COUNTY, TEXAS; AND A 16 FOOT STRIP OFF OF THE SOUTHEASTERLY SIDE OF LOTS 5 AND 6, BLOCK 2 AND LOTS 5 AND 6, BLOCK 3, JOHN G. HATCH ADDITION, CITY OF CORPUS CHRISTI, NUECES COUNTY, TEXAS, ACCORDING TO THE MAP OR PLAT THEREOF RECORDED IN VOLUME A, PAGE 4, MAP AND PLAT RECORDS OF NUECES COUNTY, TEXAS, DESCRIBED IN DEED TO SAN ANTONIO, UVALDE & GULF RAILROAD COMPANY, OF RECORD IN VOLUME 187, PAGE 13, DEED RECORDS OF NUECES COUNTY, TEXAS; THE SOUTHEASTERLY 25 FEET OF LOTS 5 AND 6, BLOCK 2, AND THE SOUTHEASTERLY 23 FEET OF LOTS 5 AND 6, BLOCK 3, JOHN G. HATCH ADDITION, DESCRIBED IN DEED TO SAN ANTONIO, UVALDE & GULF RAILROAD

COMPANY, OF RECORD IN VOLUME 191, PAGE 210, DEED RECORDS OF NUECES COUNTY, TEXAS; AND ALL OF LOT 1, BLOCK 3, PRIMROSE HEIGHTS ADDITION, ACCORDING TO THE MAP OR PLAT THEREOF RECORDED IN VOLUME 4, PAGE 41, MAP AND PLAT RECORDS OF NUECES COUNTY, TEXAS, DESCRIBED IN DEED TO SAN ANTONIO, UVALDE & GULF RAILROAD COMPANY, OF RECORD IN VOLUME 186, PAGE 37, DEED RECORDS OF NUECES COUNTY, TEXAS. SAID 0.6553 ACRE TRACT BEING MORE PARTICULARLY DESCRIBED AS FOLLOWS:

BEGINNING AT A 5/8" IRON ROD FOUND IN THE NORTH RIGHT-OF-WAY LINE OF JOHN STREET, FOR A NORTHWEST CORNER OF A 20.58 ACRE TRACT OF LAND DESCRIBED AS PARCEL ONE AND PARCEL TWO IN QUITCLAIM DEED TO GREENFIELD ENVIRONMENTAL MULTISTATE TRUST LLC, RECORDED IN DOCUMENT NO. 2011006797, OFFICIAL PUBLIC RECORDS OF NUECES COUNTY, TEXAS;

THENCE N 59°35'37" W, WITH SAID NORTH LINE OF JOHN STREET, THE SOUTH LINE OF LOT 6, BLOCK 3, JOHN G. HATCH ADDITION, CITY OF CORPUS CHRISTI, NUECES COUNTY, TEXAS, ACCORDING TO THE MAP OR PLAT THEREOF RECORDED IN VOLUME A, PAGE 4, MAP AND PLAT RECORDS OF NUECES COUNTY, TEXAS, AND THE SOUTH LINE OF THE TRACT DESCRIBED HEREIN, A DISTANCE OF 39.64 FEET TO A 5/8" IRON ROD WITH PLASTIC CAP STAMPED "SAM" SET FOR THE SOUTHWEST CORNER OF THE TRACT DESCRIBED HEREIN;

THENCE N 29°54'09" E, THROUGH LOT 6 AND LOT 5, BLOCK 3, A DISTANCE OF 250.00 FEET TO A 5/8" IRON ROD WITH PLASTIC CAP STAMPED "SAM" SET IN THE SOUTH RIGHT-OF-WAY LINE OF SUMMERS STREET;

THENCE S 60°05'51" E, WITH SAID SOUTH LINE OF SUMMERS STREET, THE NORTH LINE OF SAID LOT 5, BLOCK 3, AND THE NORTH LINE OF THE TRACT DESCRIBED HEREIN, A DISTANCE OF 23.00 FEET TO A 5/8" IRON ROD WITH PLASTIC CAP STAMPED "SAM" SET FOR THE NORTHEAST CORNER OF LOT 5, BLOCK 3, AND AN INTERIOR CORNER OF THE TRACT DESCRIBED HEREIN;

THENCE N 29°54'09" E, CROSSING SAID SUMMERS STREET, A DISTANCE OF 60.00 FEET TO A 5/8" IRON ROD WITH PLASTIC CAP STAMPED "SAM" SET IN THE NORTH LINE OF SUMMERS STREET, FOR THE SOUTHEAST CORNER OF LOT 6, BLOCK 2 AND AN INTERIOR CORNER OF THE TRACT DESCRIBED HEREIN;

THENCE N 60°05'51" W, WITH SAID NORTH LINE OF SUMMERS STREET, THE SOUTH LINE OF SAID LOT 6, BLOCK 2, AND THE SOUTH LINE OF THE TRACT DESCRIBED HEREIN, A DISTANCE OF 25.00 FEET TO A 5/8" IRON ROD WITH PLASTIC CAP STAMPED "SAM" SET;

THENCE N 29°54'09" E, THROUGH LOT 6 AND LOT 5, BLOCK 2, A DISTANCE OF 250.00 FEET TO A 5/8" IRON ROD WITH PLASTIC CAP STAMPED "SAM" SET IN THE SOUTH RIGHT-OF-WAY LINE OF HATCH STREET FOR THE NORTHWEST CORNER OF THE TRACT DESCRIBED HEREIN;

THENCE S 60°05'51" E, WITH SAID SOUTH LINE OF HATCH STREET, THE NORTH LINE OF LOT 5, BLOCK 2, AND THE NORTH LINE OF THE TRACT DESCRIBED HEREIN, A DISTANCE OF 41.64 FEET TO A 5/8" IRON ROD WITH PLASTIC CAP STAMPED "SAM" SET FOR THE NORTHEAST CORNER OF THE TRACT DESCRIBED HEREIN;

THENCE S 29°54'09" W, A DISTANCE OF 120.95 FEET TO A 5/8" IRON ROD WITH PLASTIC CAP STAMPED "SAM" SET IN THE NORTH LINE OF LOT 1, BLOCK 3, PRIMROSE HEIGHTS ADDITION, ACCORDING TO THE MAP OR PLAT THEREOF RECORDED IN VOLUME 4, PAGE 41, MAP AND PLAT RECORDS OF NUECES COUNTY, TEXAS, FOR AN INTERIOR CORNER OF THE TRACT DESCRIBED HEREIN;

THENCE S 89°04'31" E, WITH SAID NORTH LINE OF LOT 1, BLOCK 3, A DISTANCE OF 5.47 FEET TO A 5/8" IRON ROD FOUND FOR A WEST CORNER OF SAID 20.58 ACRE TRACT, FOR AN INTERIOR CORNER OF THE TRACT DESCRIBED HEREIN;

THENCE WITH THE WEST LINE OF SAID 20.58 ACRE TRACT AND THE EAST LINE OF THE TRACT DESCRIBED HEREIN THE FOLLOWING FOUR (4) COURSES AND DISTANCES:

1. S 00°19'19" E, A DISTANCE OF 59.07 FEET TO A 5/8" IRON ROD FOUND,
2. N 89°41'31" W, A DISTANCE OF 22.13 FEET TO A 5/8" IRON ROD FOUND,
3. S 29°47'16" W, A DISTANCE OF 380.23 FEET TO A 5/8" IRON ROD FOUND, AND
4. N 59°35'37" W, A DISTANCE OF 16.04 FEET TO THE POINT OF BEGINNING AND CONTAINING 0.6553 ACRES OF LAND, MORE OR LESS.

#### METES & BOUNDS DESCRIPTION - TRACT VI

BEING A TRACT CONTAINING 0.1852 OF ONE ACRE (8,067 SQUARE FEET) OF LAND OUT OF THE ENRIQUEZ VILLAREA SURVEY, ABSTRACT 1, NUECES COUNTY, TEXAS; 16 FEET OFF OF THE SOUTHEASTERLY SIDE OF LOT 5 AND LOT 6, BLOCK 4, JOHN G. HATCH ADDITION, CITY OF CORPUS CHRISTI, NUECES COUNTY, TEXAS, ACCORDING TO THE MAP OR PLAT THEREOF RECORDED IN VOLUME A, PAGE 4, MAP AND PLAT RECORDS OF NUECES COUNTY, TEXAS, DESCRIBED IN DEED TO SAN ANTONIO, UVALDE & GULF RAILROAD COMPANY, OF RECORD IN VOLUME 182, PAGE 557, DEED RECORDS OF NUECES COUNTY, TEXAS; AND 16 FEET OFF OF THE NORTHWESTERLY SIDE OF LOTS 1 AND 20, BLOCK 17, STEWART & NEWMAN ADDITION NO. 2, ADDITION TO CITY OF CORPUS CHRISTI, NUECES COUNTY, TEXAS, ACCORDING TO THE MAP OR PLAT THEREOF RECORDED IN VOLUME 3, PAGE 9, MAP AND PLAT RECORDS OF NUECES COUNTY, TEXAS, DESCRIBED IN DEED TO SAN ANTONIO, UVALDE & GULF RAILROAD COMPANY, OF RECORD IN VOLUME 186, PAGE 67, DEED RECORDS OF NUECES COUNTY, TEXAS. 0.1852 ACRE TRACT BEING MORE PARTICULARLY DESCRIBED BY METES AND BOUNDS AS FOLLOWS:

BEGINNING AT A 5/8" IRON ROD WITH PLASTIC CAP STAMPED "SAM" SET IN THE NORTH RIGHT-OF-WAY LINE OF JOHN STREET, BEING THE NORTHEAST CORNER OF THE 16 FEET OFF OF THE SOUTHEASTERLY SIDE OF LOT 5, BLOCK 4, JOHN G. HATCH ADDITION, CITY OF CORPUS CHRISTI, NUECES COUNTY, TEXAS, ACCORDING TO THE MAP OR PLAT THEREOF RECORDED IN VOLUME A, PAGE 4, MAP AND PLAT RECORDS OF NUECES COUNTY, TEXAS AND THE NORTHEAST CORNER OF THE TRACT DESCRIBED HEREIN;

THENCE S 60°05'51" E, WITH SAID NORTH LINE OF JOHN STREET, THE NORTH LINE OF SAID LOT 5, BLOCK 4, AND THE NORTH LINE OF THE TRACT DESCRIBED HEREIN, A DISTANCE OF 32.00 FEET TO A 5/8" IRON ROD WITH PLASTIC CAP STAMPED "SAM" SET IN THE WEST LINE OF A 20.58 ACRE TRACT OF LAND DESCRIBED AS PARCEL ONE AND PARCEL TWO IN QUITCLAIM DEED TO GREENFIELD ENVIRONMENTAL MULTISTATE TRUST LLC, RECORDED IN DOCUMENT NO. 2011006797, OFFICIAL PUBLIC RECORDS OF NUECES COUNTY, TEXAS, FOR THE NORTHEAST CORNER OF THE TRACT DESCRIBED HEREIN;

THENCE S 29°46'46" W, WITH SAID WEST LINE OF A 20.58 ACRE TRACT, A DISTANCE OF 250.00 FEET TO A 5/8" IRON ROD WITH PLASTIC CAP STAMPED "SAM" SET IN THE NORTH LINE OF DEMPSEY STREET, FOR THE SOUTHEAST CORNER OF THE TRACT DESCRIBED HEREIN;

THENCE N 60°05'51" W, WITH SAID NORTH LINE OF DEMPSEY STREET, A DISTANCE OF 32.54 FEET TO A 5/8" IRON ROD WITH PLASTIC CAP STAMPED "SAM" SET FOR THE SOUTHWEST CORNER OF THE 16 FEET OFF OF THE SOUTHEASTERLY SIDE OF LOT 6, BLOCK 4 AND FOR THE SOUTHWEST CORNER OF THE TRACT DESCRIBED HEREON; THENCE N 29°54'09" E, THROUGH LOTS 6 & 5, BLOCK 4, A DISTANCE OF 250.00 FEET TO THE POINT OF BEGINNING AND CONTAINING 0.1852 OF ONE ACRE (8,067 SQUARE FEET) OF LAND, MORE OR LESS.

#### METES & BOUNDS DESCRIPTION - TRACT VII

BEING A TRACT CONTAINING 0.3243 OF ONE ACRE (14,125 SQUARE FEET) OF LAND OUT OF THE ENRIQUEZ VILLAREA SURVEY, ABSTRACT 1, NUECES COUNTY, TEXAS; BEING 16 FEET OFF OF THE SOUTHEASTERLY SIDE OF LOT 5 AND LOT 6, BLOCK 5, JOHN G. HATCH ADDITION, CITY OF CORPUS CHRISTI, NUECES COUNTY, TEXAS, ACCORDING TO THE MAP OR PLAT THEREOF RECORDED IN VOLUME A, PAGE 4, MAP AND PLAT RECORDS OF NUECES COUNTY, TEXAS, DESCRIBED IN DEED TO SAN ANTONIO, UVALDE & GULF RAILROAD COMPANY, OF RECORD IN VOLUME 185, PAGE 263, DEED RECORDS OF NUECES COUNTY, TEXAS; 16 FEET OFF OF THE NORTHWESTERLY SIDE OF LOT 1, BLOCK 16, AND UNNUMBERED FRACTIONAL LOT ADJOINING LOT 1, STEWART & NEWMAN ADDITION NO. 2, ADDITION TO CITY OF CORPUS CHRISTI, NUECES COUNTY, TEXAS, ACCORDING TO THE MAP OR PLAT THEREOF RECORDED IN VOLUME 3, PAGE 9, MAP AND PLAT RECORDS OF NUECES COUNTY, TEXAS, DESCRIBED IN DEED TO SAN ANTONIO, UVALDE & GULF RAILROAD COMPANY, OF RECORD IN VOLUME 186, PAGE 67, DEED RECORDS OF

NUECES COUNTY, TEXAS; AND ALL OF FRACTIONAL LOTS 1 AND 2, BLOCK 5, CRAVEN HEIGHTS ADDITION TO THE CITY OF CORPUS CHRISTI, AS PER PLAT OR MAP THEREOF RECORDED IN VOLUME A, PAGE 7, MAP AND PLAT RECORDS OF NUECES COUNTY, TEXAS, DESCRIBED IN DEED TO SAN ANTONIO, UVALDE & GULF RAILROAD COMPANY, OF RECORD IN VOLUME 185, PAGE 303, DEED RECORDS OF NUECES COUNTY, TEXAS. 0.3243 ACRE TRACT BEING MORE PARTICULARLY DESCRIBED BY METES AND BOUNDS AS FOLLOWS:

BEGINNING AT A 5/8" IRON ROD WITH PLASTIC CAP STAMPED "SAM" SET IN THE NORTH RIGHT-OF-WAY LINE OF NUECES STREET, BEING THE SOUTHEAST CORNER OF LOT 2, BLOCK 5, CRAVEN HEIGHTS ADDITION TO THE CITY OF CORPUS CHRISTI, AS PER PLAT OR MAP THEREOF RECORDED IN VOLUME A, PAGE 7, MAP AND PLAT RECORDS OF NUECES COUNTY, TEXAS, FOR THE SOUTHEAST CORNER OF THE TRACT DESCRIBED HEREIN, FROM WHICH A 5/8" IRON ROD WITH PLASTIC CAP STAMPED "SAM" PREVIOUSLY SET FOR THE SOUTHWEST CORNER OF LOT 14, BLOCK 16, CRAVEN HEIGHTS ADDITION, BEARS S 60°08'01" E, A DISTANCE OF 50.00 FEET;

THENCE N 60°05'51" W, WITH SAID NORTH LINE OF NUECES STREET, THE SOUTH LINE OF SAID LOT 2 AND 1, BLOCK 5, AND THE SOUTH LINE OF THE TRACT DESCRIBED HEREIN, A DISTANCE OF 95.81 FEET TO A 5/8" IRON ROD WITH PLASTIC CAP STAMPED "SAM" SET FOR THE SOUTHWEST CORNER OF A BEING 16 FEET OFF OF THE SOUTHEASTERLY SIDE OF LOT 5 AND LOT 6, BLOCK 5, JOHN G. HATCH ADDITION, CITY OF CORPUS CHRISTI, NUECES COUNTY, TEXAS, ACCORDING TO THE MAP OR PLAT THEREOF RECORDED IN VOLUME A, PAGE 4, MAP AND PLAT RECORDS OF NUECES COUNTY, TEXAS, DESCRIBED IN DEED TO SAN ANTONIO, UVALDE & GULF RAILROAD COMPANY, OF RECORD IN VOLUME 185, PAGE 263, DEED RECORDS OF NUECES COUNTY, TEXAS, AND THE SOUTHWEST CORNER OF THE TRACT DESCRIBED HEREIN;

THENCE N 29°54'09" E, THROUGH LOTS 6 AND 5, BLOCK 5, A DISTANCE OF 250.00 FEET TO A 5/8" IRON ROD WITH PLASTIC CAP STAMPED "SAM" SET IN THE SOUTH LINE OF DEMPSEY STREET, FOR THE NORTHWEST CORNER OF THE TRACT DESCRIBED HEREIN;

THENCE S 60°05'51" E, WITH SAID SOUTH LINE OF DEMPSEY STREET, A DISTANCE OF 32.67 FEET TO A 5/8" IRON ROD WITH PLASTIC CAP STAMPED "SAM" SET IN THE WEST LINE OF A 20.58 ACRE TRACT OF LAND DESCRIBED AS PARCEL ONE AND PARCEL TWO IN QUITCLAIM DEED TO GREENFIELD ENVIRONMENTAL MULTISTATE TRUST LLC, RECORDED IN DOCUMENT NO. 2011006797, OFFICIAL PUBLIC RECORDS OF NUECES COUNTY, TEXAS, FOR THE NORTHEAST CORNER OF THE TRACT DESCRIBED HEREIN;

THENCE S 29°46'46" W, WITH SAID WEST LINE OF A 20.58 ACRE TRACT, A DISTANCE OF 173.69 FEET TO A 5/8" IRON ROD WITH PLASTIC CAP STAMPED "SAM" SET IN THE NORTH LINE OF SAID LOT 1, BLOCK 5, FOR AN INTERIOR CORNER OF THE TRACT DESCRIBED HEREIN;

THENCE S 89°26'12" E, WITH THE NORTH LINES OF SAID LOTS 1 AND 2, BLOCK 5, A DISTANCE OF 72.01 FEET TO A 5/8" IRON ROD WITH PLASTIC CAP STAMPED "SAM" SET FOR THE NORTHEAST CORNER OF SAID LOT 2, BLOCK 5;

THENCE S 29°54'09" W, WITH THE EAST LINE OF SAID LOT 2, BLOCK 5, A DISTANCE OF 111.59 FEET TO THE POINT OF BEGINNING AND CONTAINING 0.3243 OF ONE ACRE (14,125 SQUARE FEET) OF LAND, MORE OR LESS.

#### METES & BOUNDS DESCRIPTION - TRACT VIII

BEING A TRACT CONTAINING 0.2755 OF ONE ACRE (12,001 SQUARE FEET) OF LAND OUT OF THE ENRIQUEZ VILLAREA SURVEY, ABSTRACT 1, NUECES COUNTY, TEXAS; BEING ALL OF LOT 6, BLOCK 6 AND THE EAST 17.5 FEET OF LOT 5, BLOCK 6, JOHN G. HATCH ADDITION, CITY OF CORPUS CHRISTI, NUECES COUNTY, TEXAS, ACCORDING TO THE MAP OR PLAT THEREOF RECORDED IN VOLUME A, PAGE 4, MAP AND PLAT RECORDS OF NUECES COUNTY, TEXAS; AND THE WEST 20 FEET OF LOT 1, BLOCK 6 AND THE WEST 16 FEET OF LOT 3, BLOCK 6, CRAVEN HEIGHTS, CITY OF CORPUS CHRISTI, NUECES COUNTY, TEXAS, ACCORDING TO THE MAP OR PLAT THEREOF RECORDED IN VOLUME A, PAGE 7, MAP AND PLAT RECORDS OF NUECES COUNTY, TEXAS. 0.2755 ACRE TRACT BEING MORE PARTICULARLY DESCRIBED BY METES AND BOUNDS AS FOLLOWS:

BEGINNING AT A 5/8" IRON ROD WITH PLASTIC CAP STAMPED "SAM" PREVIOUSLY SET IN THE NORTH RIGHT-OF-WAY LINE OF NUECES STREET, BEING THE NORTHEAST CORNER OF THE WEST 25 FEET OF LOT 5, BLOCK 6, JOHN G. HATCH ADDITION, CITY OF CORPUS CHRISTI, NUECES COUNTY, TEXAS, ACCORDING TO THE MAP OR PLAT THEREOF RECORDED IN VOLUME A, PAGE 4, MAP AND PLAT RECORDS OF NUECES COUNTY, TEXAS, FOR THE NORTHWEST CORNER OF THE TRACT DESCRIBED HEREIN;

THENCE S 60°05'51" E, WITH SAID NORTH LINE OF NUECES STREET, THE NORTH LINE OF SAID LOT 5, BLOCK 6, AND THE NORTH LINE OF LOT 3, BLOCK 6, CRAVEN HEIGHTS, CITY OF CORPUS CHRISTI, NUECES COUNTY, TEXAS, ACCORDING TO THE MAP OR PLAT THEREOF RECORDED IN VOLUME A, PAGE 7, MAP AND PLAT RECORDS OF NUECES COUNTY, TEXAS, A DISTANCE OF 33.50 FEET TO A 5/8" IRON ROD WITH PLASTIC CAP STAMPED "SAM" SET FOR THE NORTHEAST CORNER OF THE WEST 16 FEET OF SAID LOT 3, BLOCK 6, FOR THE NORTHEAST CORNER OF THE TRACT DESCRIBED HEREIN;

THENCE S 29°54'09" W, WITH THE EAST LINE OF THE SAID WEST 16 FEET OF LOT 3, BLOCK 6, A DISTANCE OF 125.00 FEET TO A 5/8" IRON ROD WITH PLASTIC CAP STAMPED "SAM" SET IN THE NORTH LINE OF LOT 1, BLOCK 6, FOR THE SOUTHEAST CORNER OF SAID WEST 16 FEET OF LOT 3, BLOCK 6, FOR AN INTERIOR CORNER OF THE TRACT DESCRIBED HEREIN;

THENCE S 60°05'51" E, WITH SAID NORTH LINE OF LOT 1, BLOCK 6, A DISTANCE OF 4.00 FEET TO A CALCULATED POINT FOR THE NORTHEAST CORNER OF THE WEST 20 FEET OF SAID LOT 1, BLOCK 6, FOR AN EASTERLY CORNER OF THE TRACT DESCRIBED HEREON;

THENCE S 29°54'09" W, WITH THE EAST LINE OF THE SAID WEST 20 FEET OF LOT 1, BLOCK 6, A DISTANCE OF 125.00 FEET TO A CALCULATED POINT IN THE NORTH RIGHT-OF-WAY LINE OF WINNEBAGO STREET, FOR THE SOUTHEAST CORNER OF THE WEST 20 FEET OF SAID LOT 1, BLOCK 6, FOR THE SOUTHEAST CORNER OF THE TRACT DESCRIBED HEREIN;

THENCE N 60°05'51" W, WITH SAID NORTH LINE OF WINNEBAGO STREET, THE SOUTH LINE OF SAID LOT 1, BLOCK 6 AND LOT 6, BLOCK 6, A DISTANCE OF 62.50 FEET TO A 5/8" IRON ROD WITH PLASTIC CAP STAMPED "SAM" SET FOR THE SOUTHEAST CORNER OF LOT 7, BLOCK 6, THE SOUTHWEST CORNER OF LOT 6, BLOCK 6 AND THE SOUTHWEST CORNER OF THE TRACT DESCRIBED HEREON;

THENCE N 29°54'09" E, WITH THE EAST LINE OF THE SAID LOT 7, BLOCK 6, THE WEST LINE OF SAID LOT 6, BLOCK 6 AND THE WEST LINE OF THE TRACT DESCRIBED HEREIN, A DISTANCE OF 125.00 FEET TO A 5/8" IRON ROD WITH PLASTIC CAP STAMPED "SAM" SET FOR THE NORTHEAST CORNER OF SAID LOT 7, BLOCK 6 AND THE NORTHWEST CORNER OF SAID LOT 6, BLOCK 6, FOR A WESTERLY CORNER OF THE TRACT DESCRIBED HEREIN;

THENCE S 60°05'51" E, WITH SAID NORTH LINE OF LOT 6, BLOCK 6, A DISTANCE OF 25.00 FEET TO A CALCULATED POINT FOR THE SOUTHWEST CORNER OF THE WEST 20 FEET OF SAID LOT 1, BLOCK 6, FOR AN INTERIOR CORNER OF THE TRACT DESCRIBED HEREON;

THENCE N 29°54'09" E, WITH THE WEST LINE OF THE SAID WEST 20 FEET OF LOT 1, BLOCK 6, AND THE WEST LINE OF THE TRACT DESCRIBED HEREIN, A DISTANCE OF 125.00 FEET TO THE POINT OF BEGINNING AND CONTAINING 0.2755 OF ONE ACRE (12,001 SQUARE FEET) OF LAND, MORE OR LESS.

#### METES & BOUNDS DESCRIPTION – TRACT IX

BEING A TRACT CONTAINING 0.5527 OF ONE ACRE (24,075 SQUARE FEET) OF LAND OUT OF THE ENRIQUEZ VILLAREAL SURVEY, ABSTRACT 1, NUECES COUNTY, TEXAS; BEING A 16 FOOT STRIP OFF OF THE SOUTHEASTERLY SIDE OF LOTS 5 AND 6, BLOCK 7 AND LOTS 5 AND 6, BLOCK 8, JOHN G. HATCH ADDITION, CITY OF CORPUS CHRISTI, NUECES COUNTY, TEXAS, ACCORDING TO THE MAP OR PLAT THEREOF RECORDED IN VOLUME A, PAGE 4, MAP AND PLAT RECORDS OF NUECES COUNTY, TEXAS, DESCRIBED IN DEED TO SAN ANTONIO, UVALDE & GULF RAILROAD COMPANY, OF RECORD IN VOLUME 185, PAGE 263, DEED RECORDS OF NUECES COUNTY, TEXAS; A 16 FOOT STRIP OFF OF THE NORTHWESTERLY SIDE OF LOTS 1 AND 3, BLOCK 7, CRAVEN HEIGHTS, CITY OF CORPUS CHRISTI, NUECES COUNTY, TEXAS, ACCORDING



TO THE MAP OR PLAT THEREOF RECORDED IN VOLUME A, PAGE 7, MAP AND PLAT RECORDS OF NUECES COUNTY, TEXAS, AND A OFF OF THE WEST SIDE OF THE J.M. PRIOR TRACT, DESCRIBED IN DEED TO SAN ANTONIO, UVALDE & GULF RAILROAD COMPANY, OF RECORD IN VOLUME 185, PAGE 552, DEED RECORDS OF NUECES COUNTY, TEXAS; A 16 FOOT STRIP OFF OF THE WEST SIDE OF THE JULIAN PRIOR TRACT, DESCRIBED IN DEED TO SAN ANTONIO, UVALDE & GULF RAILROAD COMPANY, OF RECORD IN VOLUME 185, PAGE 551, DEED RECORDS OF NUECES COUNTY, TEXAS; A 16 FOOT STRIP OFF OF THE WEST SIDE OF THE JULIAN PRIOR TRACT, DESCRIBED IN DEED TO SAN ANTONIO, UVALDE & GULF RAILROAD COMPANY, OF RECORD IN VOLUME 184, PAGE 619, DEED RECORDS OF NUECES COUNTY, TEXAS; AND ALL OF LOT 1, BLOCK 21, CRAVEN HEIGHTS, CITY OF CORPUS CHRISTI, NUECES COUNTY, TEXAS, ACCORDING TO THE MAP OR PLAT THEREOF RECORDED IN VOLUME A, PAGE 7, MAP AND PLAT RECORDS OF NUECES COUNTY, TEXAS, DESCRIBED IN DEED TO SAN ANTONIO, UVALDE & GULF RAILROAD COMPANY, OF RECORD IN VOLUME 184, PAGE 621, DEED RECORDS OF NUECES COUNTY, TEXAS. 0.5527 ACRE TRACT BEING MORE PARTICULARLY DESCRIBED BY METES AND BOUNDS AS FOLLOWS:

BEGINNING AT A TXDOT TYPE II MONUMENT FOUND IN THE NORTH RIGHT-OF-WAY LINE OF SMITH STREET, BEING THE SOUTHWEST CORNER OF LOT 1, BLOCK 21, CRAVEN HEIGHTS, CITY OF CORPUS CHRISTI, NUECES COUNTY, TEXAS, ACCORDING TO THE MAP OR PLAT THEREOF RECORDED IN VOLUME A, PAGE 7, MAP AND PLAT RECORDS OF NUECES COUNTY, TEXAS, FOR THE SOUTHWEST CORNER OF THE TRACT DESCRIBED HEREIN;

THENCE N 29°D46'45" E, A DISTANCE OF 360.24 FEET TO A 5/8" IRON ROD WITH PLASTIC CAP STAMPED "SAM" SET IN THE NORTH RIGHT-OF-WAY LINE OF MINTON STREET FOR THE SOUTHEAST CORNER OF LOT 6, BLOCK 8, JOHN G. HATCH ADDITION, CITY OF CORPUS CHRISTI, NUECES COUNTY, TEXAS, ACCORDING TO THE MAP OR PLAT THEREOF RECORDED IN VOLUME A, PAGE 4, MAP AND PLAT RECORDS OF NUECES COUNTY, TEXAS, FOR AN INTERIOR CORNER OF THE TRACT DESCRIBED HEREIN;

THENCE N 60°D16'11" W, WITH SAID NORTH LINE OF MINTON STREET AND THE SOUTH LINE OF LOT 6, BLOCK 8, A DISTANCE OF 15.91 FEET TO A 5/8" IRON ROD WITH PLASTIC CAP STAMPED "SAM" SET;

THENCE N 29°D45'51" E, THROUGH LOTS 6 AND 5, BLOCK 8, A DISTANCE OF 237.15 FEET TO A 5/8" IRON ROD WITH PLASTIC CAP STAMPED "SAM" SET IN THE SOUTH RIGHT-OF-WAY LINE OF MOORE STREET;

THENCE S 60°D16'11" E, WITH SAID SOUTH LINE OF MOORE STREET AND THE NORTH LINE OF LOT 5, BLOCK 8, A DISTANCE OF 15.95 FEET TO A 5/8" IRON ROD WITH PLASTIC CAP STAMPED "SAM" SET FOR THE NORTHEAST CORNER OF SAID LOT 5, BLOCK 8;

THENCE N 29°D46'24" E, CROSSING MOORE STREET, A DISTANCE OF 50.00 FEET TO A 5/8" IRON ROD WITH PLASTIC CAP STAMPED "SAM" SET IN THE NORTH RIGHT-OF-WAY LINE OF MOORE STREET FOR THE SOUTHEAST CORNER OF LOT 6, BLOCK 7; THENCE N 60°D16'11" W, WITH SAID NORTH LINE OF MOORE STREET AND THE SOUTH LINE OF LOT 6, BLOCK 7, A DISTANCE OF 15.96 FEET TO A 5/8" IRON ROD WITH PLASTIC CAP STAMPED "SAM" SET;

THENCE N 29°D45'51" E, THROUGH LOTS 6 AND 5, BLOCK 7, A DISTANCE OF 249.94 FEET TO A 5/8" IRON ROD FOUND IN THE SOUTH RIGHT-OF-WAY LINE OF WINNEBAGO STREET;

THENCE S 60°D12'19" E, WITH SAID SOUTH LINE OF WINNEBAGO STREET AND THE NORTH LINE OF LOT 5, BLOCK 7, A DISTANCE OF 32.06 FEET TO A TXDOT TYPE II MONUMENT FOUND FOR THE NORTHWEST CORNER OF A 9.345 ACRE PARCEL OF LAND DESCRIBED IN DEED TO TEXAS DEPARTMENT OF TRANSPORTATION RECORDED IN DOCUMENT NO. 2017022243, OFFICIAL PUBLIC RECORDS OF NUECES COUNTY, TEXAS;

THENCE S 29°D54'09" W, WITH THE WEST LINE OF THE SAID 9.345 ACRE PARCEL OF LAND, PASSING AT A DISTANCE OF 677.33 FEET A TXDOT TYPE II MONUMENT FOUND, AND CONTINUING FOR A TOTAL DISTANCE OF 809.70 FEET TO A 5/8" IRON ROD WITH PLASTIC CAP STAMPED "SAM" SET IN THE EAST LINE OF SAID LOT 1, BLOCK 21;

THENCE S 00°D42'24" W, WITH SAID EAST LINE OF LOT 1, BLOCK 21, A DISTANCE OF 87.47 FEET TO A 5/8" IRON ROD WITH PLASTIC CAP STAMPED "SAM" SET IN THE NORTH LINE OF BUFFALO STREET;

THENCE N 89°D25'12" W, WITH SAID NORTH LINE OF BUFFALO STREET, A DISTANCE OF 23.04 FEET TO A 5/8" IRON ROD WITH PLASTIC CAP STAMPED "SAM" SET FOR THE SOUTH CORNER OF SAID LOT 1, BLOCK 21;

THENCE N 60°D05'51" W, WITH THE NORTH LINE OF SMITH STREET, A DISTANCE OF 38.27 FEET TO THE POINT OF BEGINNING AND CONTAINING 0.5527 OF ONE ACRE (24,075 SQUARE FEET) OF LAND, MORE OR LESS.

**Nueces County  
Kara Sands  
Nueces County  
Clerk**

---

**Instrument Number:** 2024034769

eRecording - Real Property

DEED

Recorded On: October 11, 2024 10:48 AM

Number of Pages: 20

---

**" Examined and Charged as Follows: "**

Total Recording: \$92.00

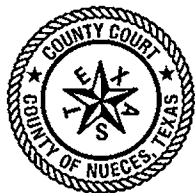

**STATE OF TEXAS  
NUECES COUNTY**

**I hereby certify that this Instrument was FILED In the File Number sequence on the date/time printed hereon, and was duly RECORDED in the Official Records of Nueces County, Texas.**

Kara Sands  
Nueces County Clerk  
Nueces County, TX



---

**\*\*\*\*\* THIS PAGE IS PART OF THE INSTRUMENT \*\*\*\*\***

Any provision herein which restricts the Sale, Rental or use of the described REAL PROPERTY because of color or race is invalid and unenforceable under federal law.

**File Information:**

Document Number: 2024034769  
Receipt Number: 20241011000039  
Recorded Date/Time: October 11, 2024 10:48 AM  
User: Lisa C  
Station: CLERK08

**Record and Return To:**

Simplifile  
484 North 300 West, Suite 202  
Provo UT