



# **Corpus Christi Parks & Recreation Master Plan**

**City Council Presentation**

**August 21, 2012**

# Park Land Comparison

**TABLE 56 - BENCHMARK OF PARKLAND PER 1,000 RESIDENTS**

City	2010 Population*	# of Parks	Net Park Acreage**	Park Sites/1,000 Residents	Developed Park Acreage/1,000 Residents	Average Acres/Site
Austin	790,390	187	11,534	0.24	14.6	61.68
Brownsville	175,203	30	1,100	0.17	6.3	36.67
Corpus Christi	305,215	208	2,200	0.68	5.7	10.61
San Antonio	1,327,407	236	6,420	0.18	4.8	27.20
Victoria	62,592	15	650	0.24	10.4	32.50
Waco	124,805	60	1,200	0.49	9.7	20.00

\* Source: 2010 US Census

\*\* Developed park acreage, not including golf courses, based on information provided by City.

**Too Many Parks With Small Acreage**

# Planning Approach

Corpus Christi Parks and Recreation Master Plan

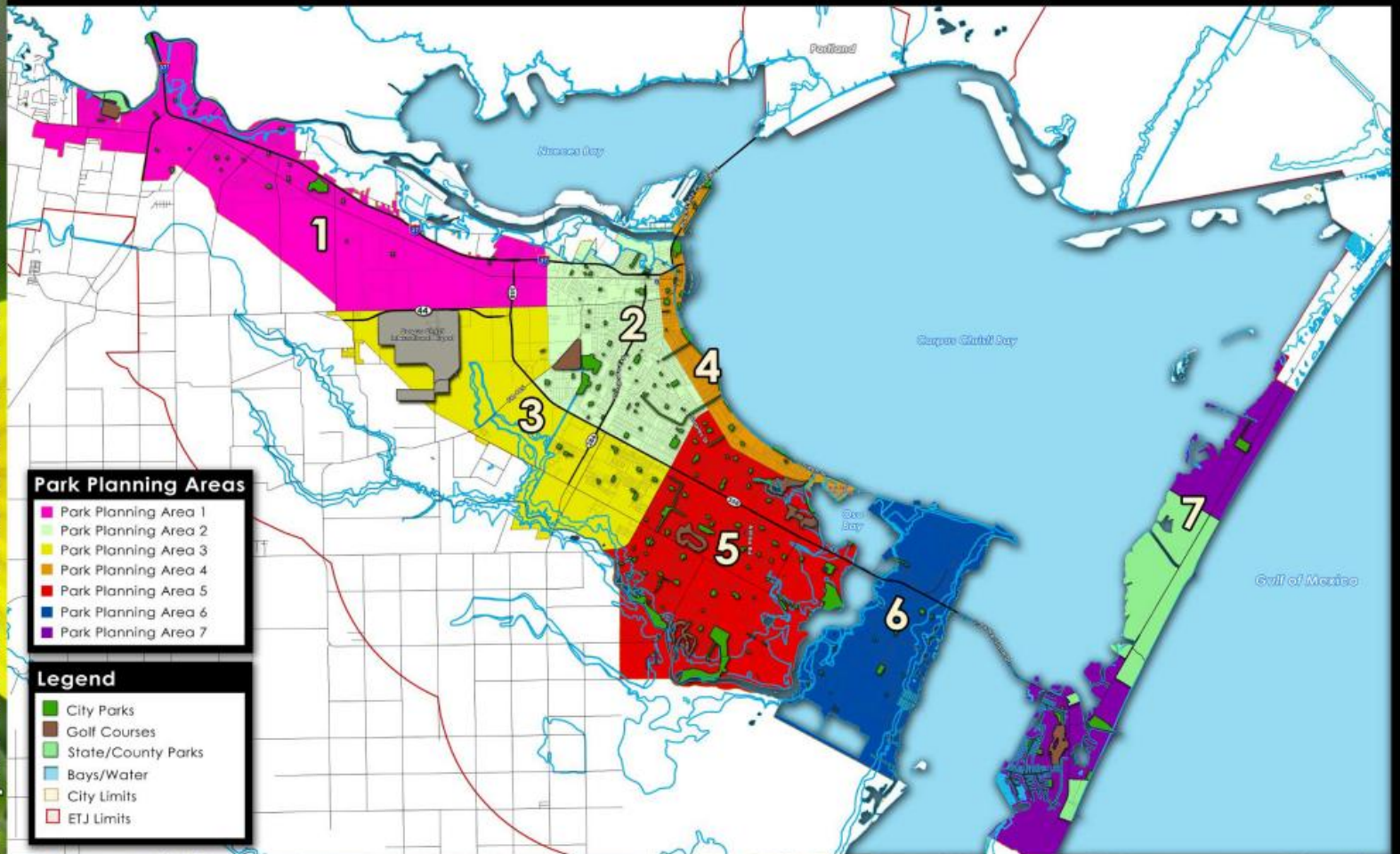

Park Planning Areas

GRAPHIC SCALE



# Goals

***1. Bring Greater Efficiency and Value to Park Development and Maintenance***

***2. Enhance the Experience of Visiting Parks and Recreation Facilities for All Residents***

***3. Increase Recreation Opportunities and Activities***

***4. Acquire New Park Land for Future Development In A Strategic Manner over the Next 8 Years***

# Objectives

**Objectives are Real and  
Measurable Actions  
to Implement Goals**

# Objective # 1

**Parks must be designed and improved to reduce maintenance and operational costs.**

**(Goal 1)**

# Objective # 2

**Throughout the City, parks and recreation facilities must be improved to meet accepted standards for safety, accessibility and “playability”. (Goal 2)**

# Objective # 3

**Parks should be attractive, with shade trees and a neat, well maintained appearance.  
(Goal 2)**



# Objective #4

**Parks should include a variety of recreation features to appeal to a wide range of ages and interests. (Goal 3)**

# Objective # 5

**Trail and /or bicycle routes should provide linkage between parks and other destinations.**

**(Goal 3)**

# Objective # 6

**Parks and facilities that are not well used, or do not provide significant recreation opportunities, Should be “repurposed” to allow available funding to be focused elsewhere in the parks system.  
(Goal 1)**

# New Maintenance Standards (Goals 1 & 2)

**TABLE 70 - CORPUS CHRISTI PARKS STANDARDS OF CARE LEVELS**

Core Business	Defined Tasks	Level A	Level B	Level C	Level D	Natural Areas
Inspections		Daily	Daily (Mon-Fri)	Weekly	Monthly	Monthly
<b>Turf Management</b>	Mow	7 Day	14 Day	21 Day	Seasonally (trails, playgrounds, picnic units)	Seasonally (trails, interpretive center)
	Aerify	Annual	Annual	Annual	N/A	N/A
	Seed/Sod Cycle	Winter overseed (with rye grass)	Native grass seed	Wildflowers every other year	Wildflowers every third year	Wildflowers once
	Pest Control	Annual pre-emerge, preventive spray program	IPM spot treatment	IPM spot treatment	Selective grass suppression in wildflower zones	Selective grass suppression in wildflower zones
	Fertility	6# / 1000 sq ft during growing season 50% water insoluble	7# / 1000 sq ft during growing season 50% water insoluble	Minimal macronutrients	N/A	N/A
	Irrigation	Smart automated	Automated	No irrigation	N/A	N/A
<b>Sanitation</b>	Litter	Daily	Daily (Mon-Fri)	Bi Weekly	Weekly	Public areas daily, wildscapes by volunteers
	Receptacles	Daily	Daily (Mon-Fri)	Bi Weekly	Weekly	Public areas daily, wildscapes by volunteers
	Facilities	Daily	N/A	N/A	N/A	N/A
<b>Horticultural</b>	Shade Trees	Annual attention	Three year rotation	Five year rotation	Ordinance driven	None
	Palms	Twice annual	Annual	Annual	Every other year	Never
	Pest Control	Preventive and reactive IPM	Preventive and reactive IPM	Reactive	Reactive	None
	Fertility	Liquid foliar feed, complete with trace elements, monthly	Time released complete, quarterly	None	None	None
	Horticultural Displays	Annuals with 3 rotations, perennials including tropicals	Native perennials	Wildflowers	Wildflowers	Wildflowers
	Care of Displays	Weekly	Monthly	None	None	None

# New Park Classifications

(Goals 1, 2 & 3)

**TABLE 57 - NEW PARK CLASSIFICATIONS**

Park Type	Acreage Criteria	Service Area Radius
Niche	< 3 acres	1/4 mile
Neighborhood	3 - 10 acres	1 mile
Community	10 - 50 acres	3 miles
Regional	> 50 acres	10 miles
City Park	> 100 acres	Entire City
Bay/Beach	N/A	Citywide
Special Use	N/A	Citywide
Nature Preserve	N/A	Citywide
Esplanades, Parkways, Trails	N/A	Citywide
Boat Ramps	N/A	Citywide

# New Park Classifications

Corpus Christi Parks and Recreation Master Plan

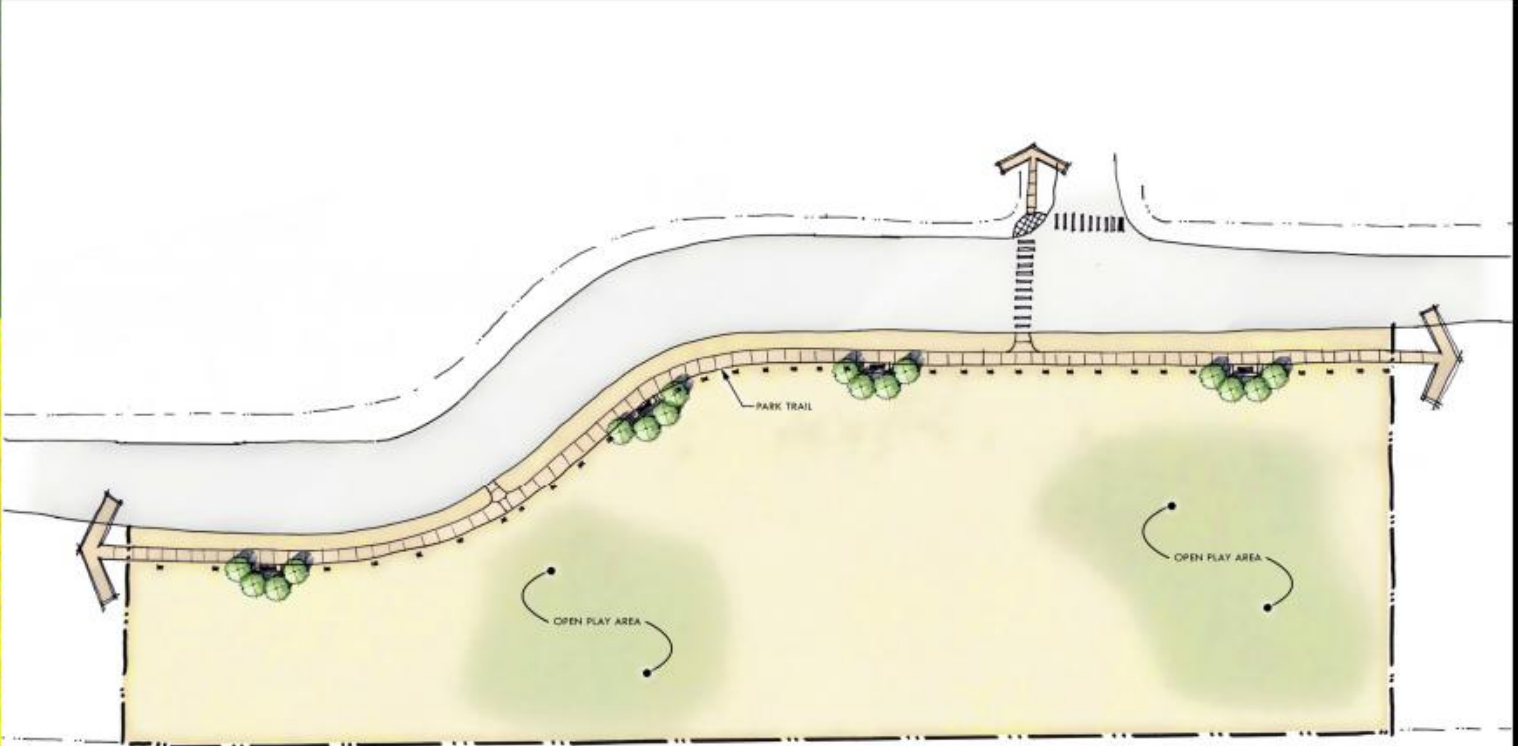

*“Walk To” Parks*

Typical Niche Park Concept



GRAPHIC SCALE



# New Park Classifications



*“Walk To” Parks*

Typical Neighborhood Park Concept



# New Park Classifications

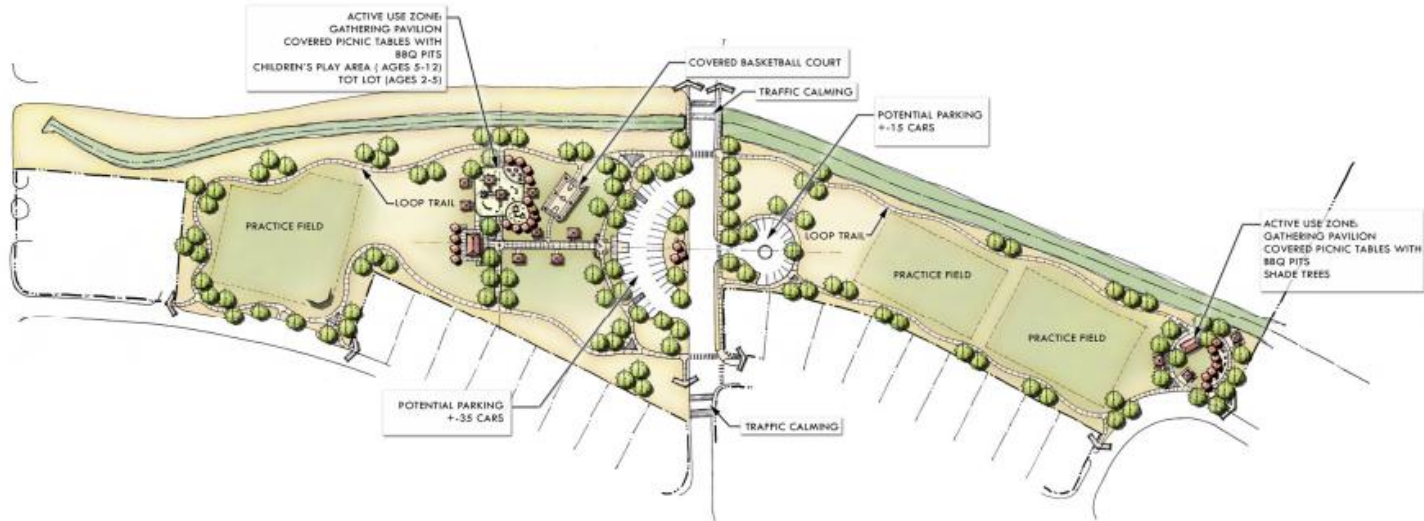

## Major Investment Parks

## Typical Community Park Concept

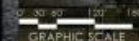



# New Park Classifications



*Major Investment Parks*

**Typical Regional Park Concept**



# Repurposing Approach (Goal 1)

**TABLE 64 - PARK REPURPOSING APPROACH**

Key Steps	Years									
	1	2	3	4	5	6	7	8	9	10
Remove defective/unsafe equipment										
Repurposing Options Investigation										
Preserve as "Open Space" - Native Trees & Grasses										
Partner with an "Adopt-A-Park" Organization										
Transfer to Another Public Agency										
Transfer to Neighborhood Organization										
Transfer to "Non-Profit" Organization										
Sell to Private Owner										
Other Options										
Negotiations/Arrangements/Transfers										
Maintenance - "Open Space" Preserves										

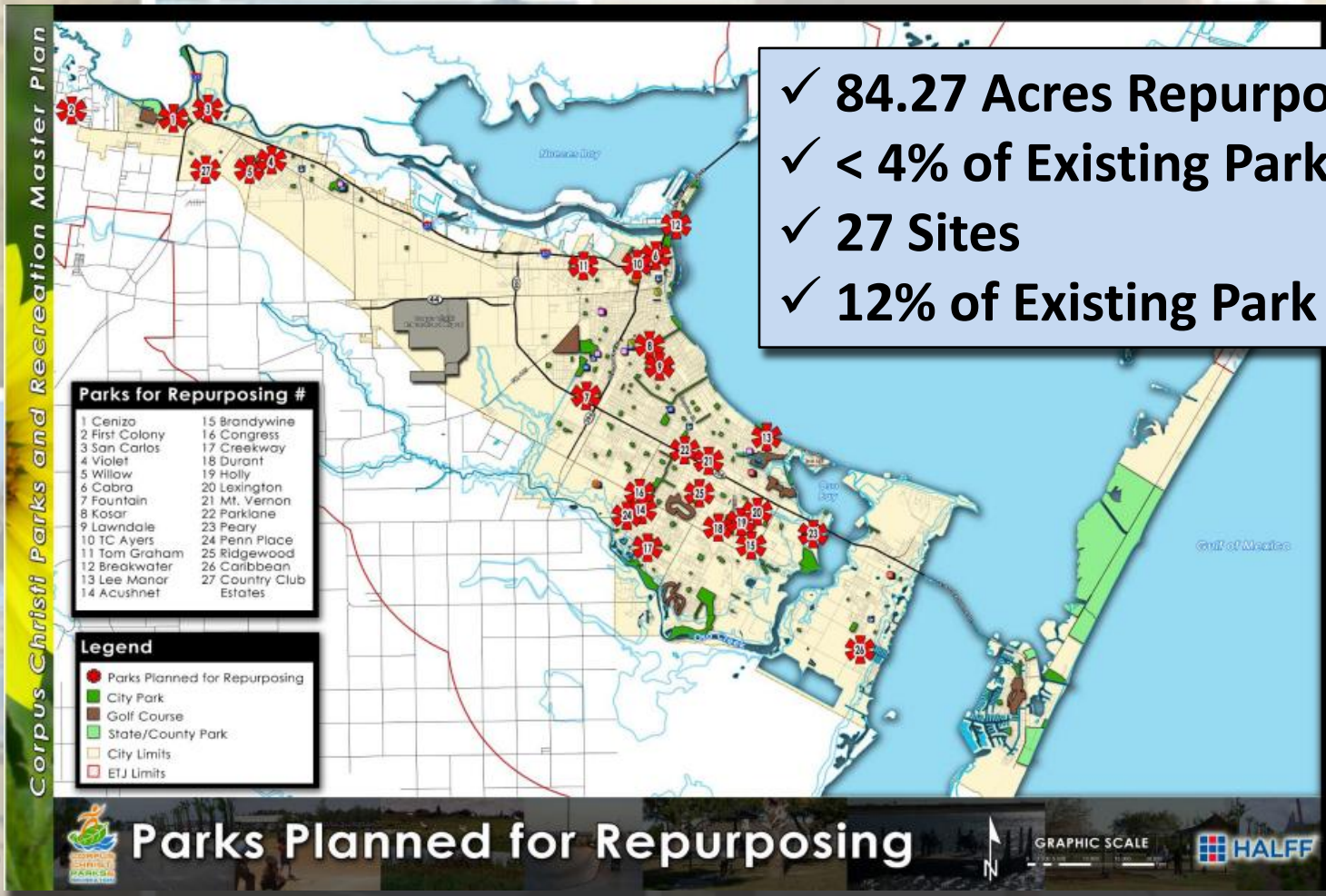

# Recommendations for Repurposing



# Park Development Priorities

**TABLE 53 - CORPUS CHRISTI PARKS MASTER PLAN RECREATION AND FACILITY PRIORITIES**

Rank	Master Plan Recreation Priorities	Community & Regional Park Development	Hike & Bike Trails - City Wide	Aquatic Facilities	Sports Fields and Complex Improvements	Southside Park Maintenance Facility (Witt)	ADA Upgrades & Improvements	Golf Course Improvements: Lozano & Oso	Bicycle/Pedestrian Bridge @ Oso Bay	Bayfront Parks - Irrig. & Stabilize Shoreline	Senior & Rec Center Improvements	Tennis Center Improvements: HEB & Al Kruse	Heritage Park - Steamboat/Ropes House	Water Garden Improvements	Oso Bay Wetlands and Nat. Pres. - Ph 3
1	Walking, jogging, bicycling														
1	Swimming and water play														
2	Picnicking														
2	Bird watching, nature study														
2	Fitness classes and programs														
3	Music, dance, theater														
4	Canoeing and kayaking														
5	Festivals and special events														
6	Fishing - saltwater														
6	Playgrounds and play equipment														

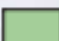
-  "Parks to Standards" Improvements
-  Recreation Development Priority
-  Infrastructure Improvement

# Major Investment Parks

**TABLE 68 - MAJOR INVESTMENT PARKS**

Name	Park Planning Area	Acres	Community Park	Primary Community Park	Regional Park	Special Use Park
West Guth Regional Park	1	80.0				
Ben Garza Community Park	2	10.9				
Lindale Community Park	2	10.9				
Salinas/Garcia Sports Complex	2	156.9				
Parkview Community Park	3	11.5				
Cole Park*	4	43.0				
Brockhampton Community Park	5	20.0				
Capt. Falcon Community Park	5	29.3				
Cullen Community Park	5	17.9				
Lincoln Community Park	5	11.6				
Schanen Community Park	5	18.0				
St. Andrews Community Park	5	30.6				
Bill Witt/Oso 1 Regional Park	5	80				
Parker Community Park	6	13.74				
Waldron Community Park	6	20.0				
Billish Community Park	7	11.2				
Commodore Community Park	7	19.0				

\* Cole Park will have Community Park Components, in addition to its role as a showcase bay front park.



Major Investment Parks



Non-major investment community parks

# Major Investment Parks

Corpus Christi Parks and Recreation Master Plan

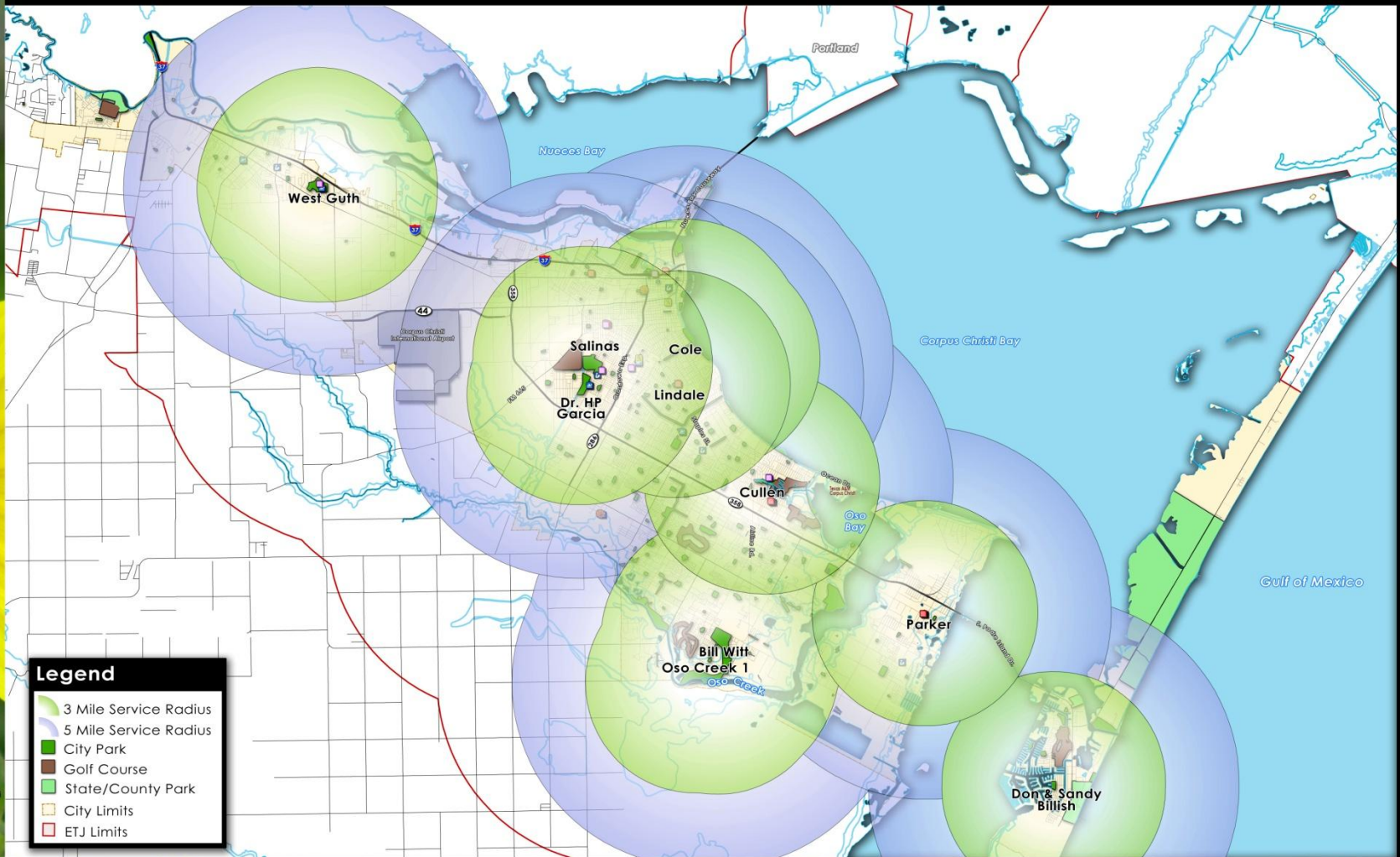

**Legend**

- 3 Mile Service Radius
- 5 Mile Service Radius
- City Park
- Golf Course
- State/County Park
- City Limits
- ETJ Limits



3 & 5 Mile Service Radius of Major Investment Parks



# Proposed Trails

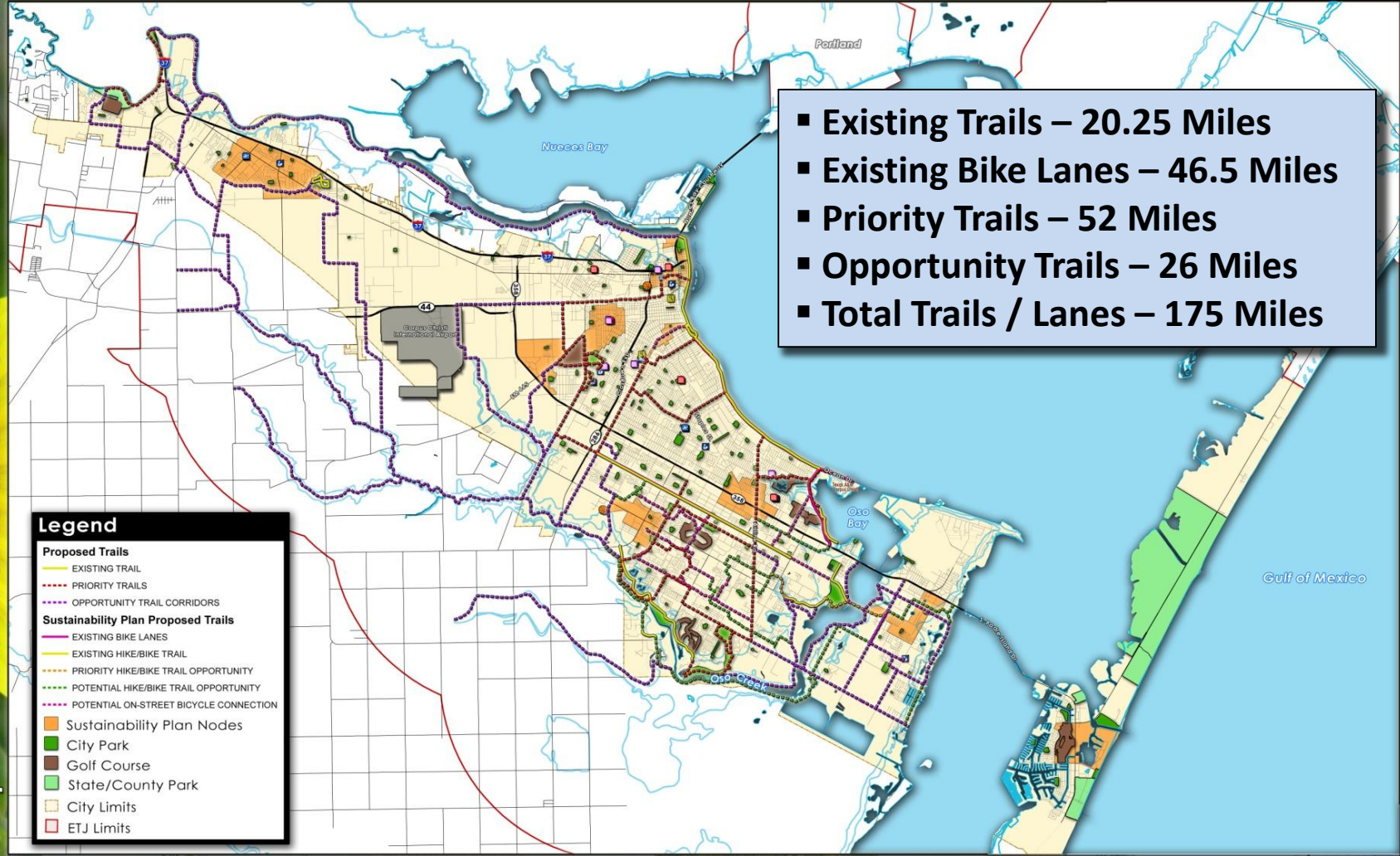

- Existing Trails – 20.25 Miles
- Existing Bike Lanes – 46.5 Miles
- Priority Trails – 52 Miles
- Opportunity Trails – 26 Miles
- Total Trails / Lanes – 175 Miles



## Proposed Trail Recommendations

Trail alignments are approximate and are intended to show general geographical locations. Trail alignments are conceptual and demonstrate a future need for citywide and neighborhood area connectivity. Precise trail alignments and decisions should be made as more detailed planning, consulting and design occurs.



# What Will We Have?

✓ **197 Park Sites**

✓ **Over 2,000 Acres of Parks**

- |                        |        |
|------------------------|--------|
| • Niche                | 82.30  |
| • Neighborhood         | 366.52 |
| • Community            | 281.65 |
| • Regional             | 160.00 |
| • Special Use Parks    | 418.75 |
| • Bay Beach            | 128.28 |
| • Nature Park Preserve | 426.68 |



# Next Steps - Adoption

- Planning Commission - August 29<sup>th</sup>
- City Council – September 18<sup>th</sup> and 25<sup>th</sup>

## Questions?

CITY COUNCIL PRESENTATION

August 21, 2012