

Holly Road Train Trestle to Tourism Trail - AFA



Council Presentation
April 08, 2025



Project Location





Project Scope



This motion authorizes an Advance Funding Agreement (AFA) with the Texas Department of Transportation (TXDOT) for Holly Road Train Trestle to Tourism Trail consists of the construction of a 15-foot-wide shared use path from the existing shared use path on the west side of Oso Bay along Division Road to Flour Bluff Drive and along Flour Bluff Drive from Division Road to Don Patricio Road. The project will include the construction of a pedestrian bridge across the OSO Bay utilizing existing pilings from the abandoned train trestle bridge.



Train Trestle Photos





Conceptual Layouts



Typical Sections A, D, E, and F - Corresponding to Project Overview Exhibit

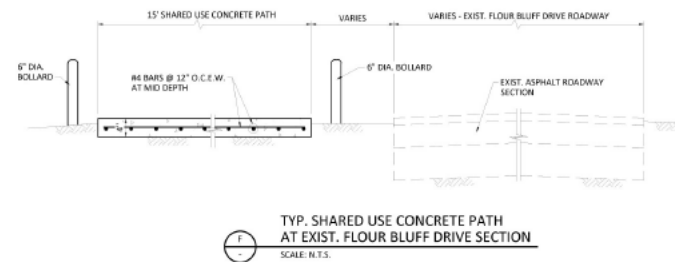
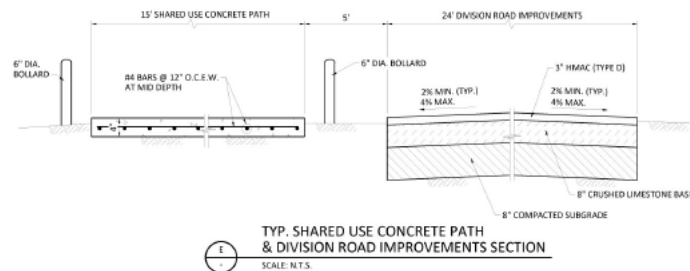
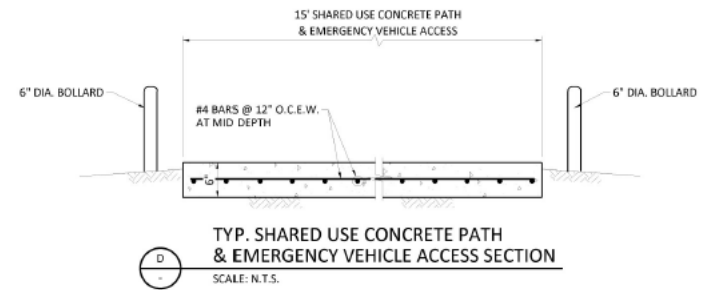
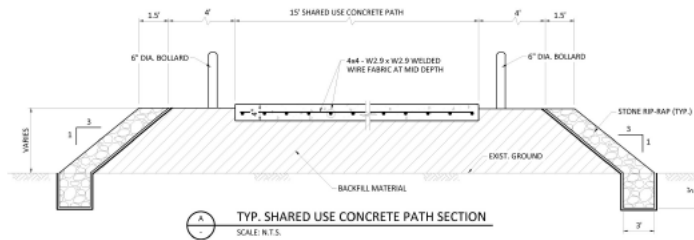



Conceptual Layouts



Typical Bridge Sections B & C - Corresponding to Project Overview Exhibit

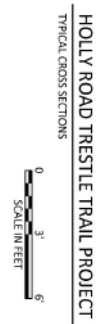
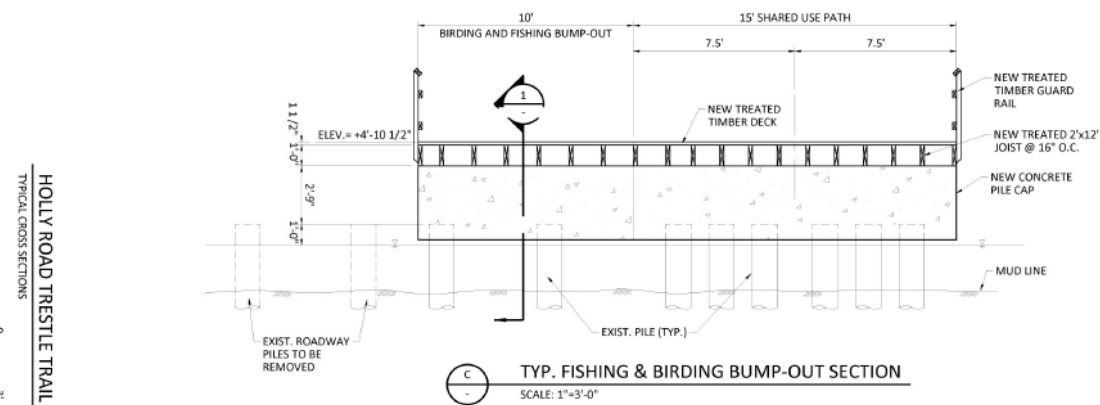
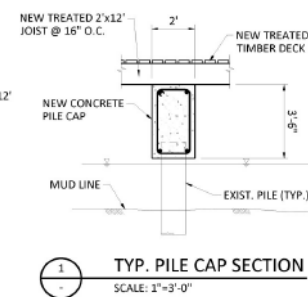
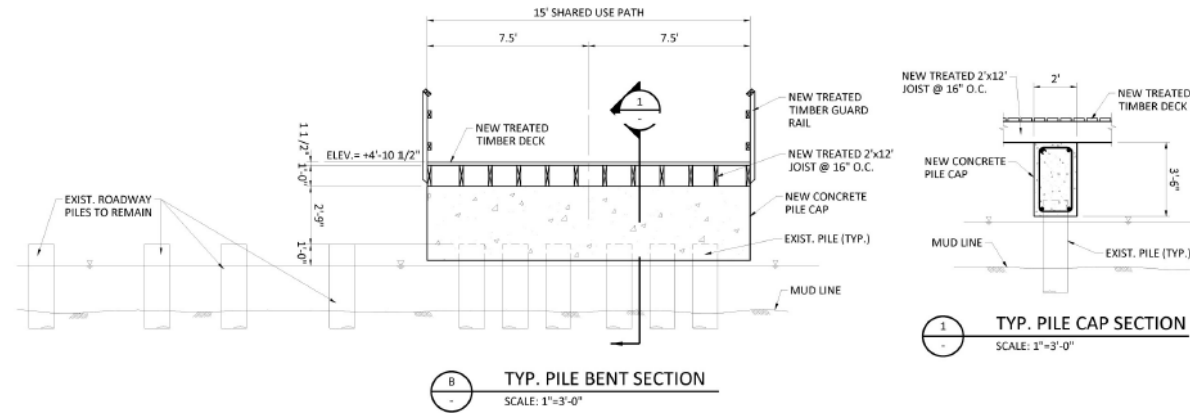

HOLLY ROAD TRESTLE TRAIL PROJECT
TYPICAL CROSS SECTIONS