

# Farming Lease Agreement Cefé Valenzuela Landfill



Council Presentation  
October 24, 2017



# Lease Location

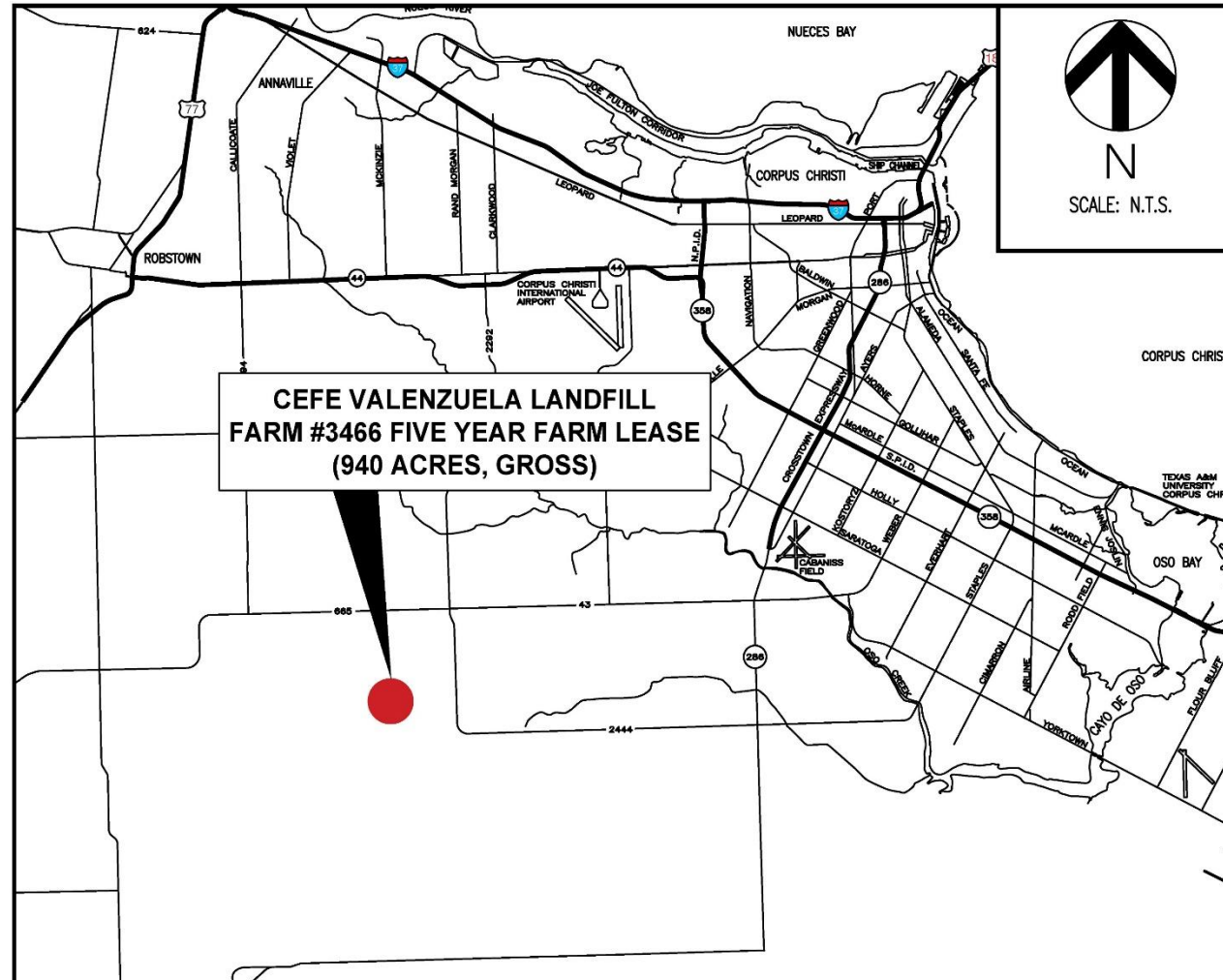
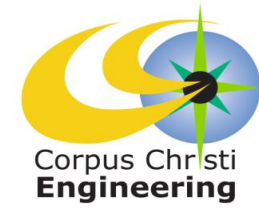



# Lease Vicinity Map

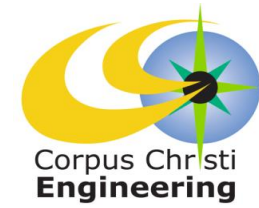



# Five-Year Farm Lease

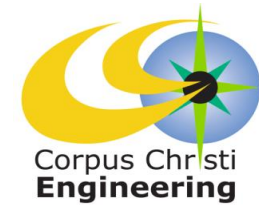

- Farm Lease area contains 940 acres (gross) and 818 acres (net).
- Annual payment is based on the gross acreage of 940 acres.
- Cash rent per acre is \$105.
- Annual lease rent is \$98,700, payable in advance.
- The five-year lease term is effective November 1, 2017 and ends on October 31, 2022.
- Tenant must comply with all applicable Federal, State, and local laws, rules, and regulations
- Lease is not assignable or cannot be sub-leased.
- Tenant carries commercial general liability insurance in the amount of \$1,000,000.