



Zoning Case #0414-04 BCH Investment Group, LLC

From: "RM-2" Multifamily 2 District
To: "CG-2" General Commercial District



Planning Commission
April 9, 2014



Aerial Overview





Aerial





Site Plan

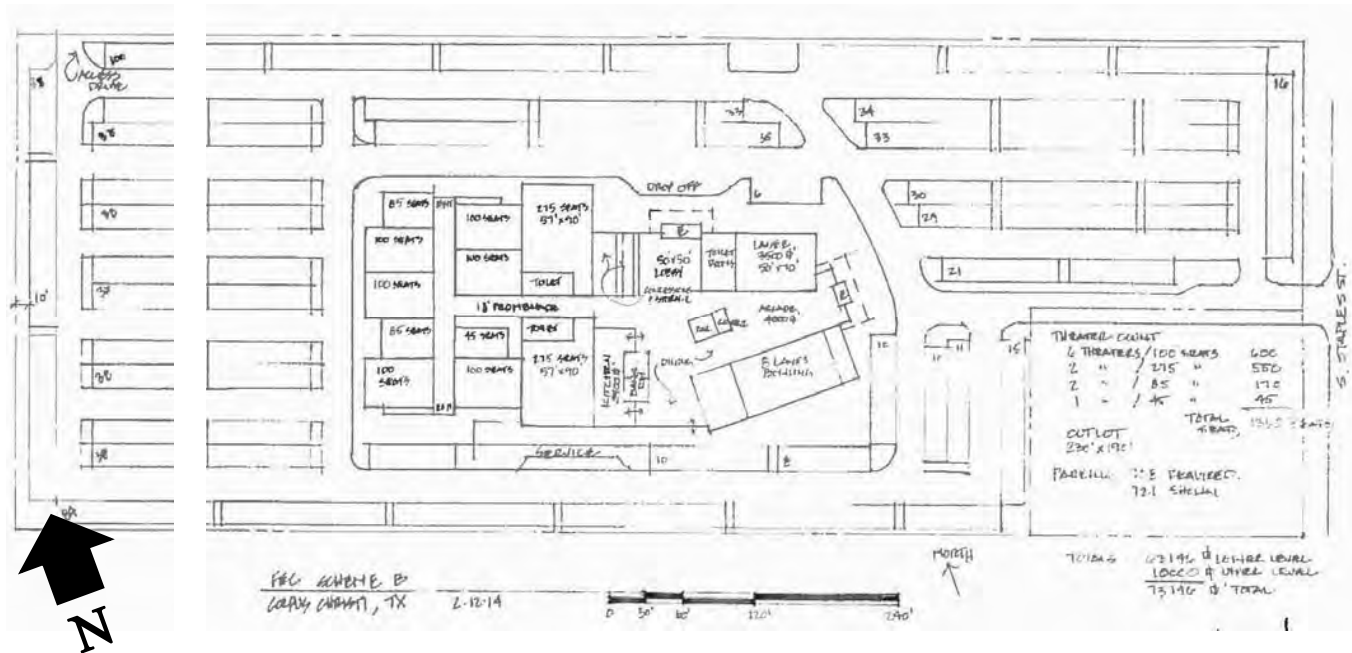





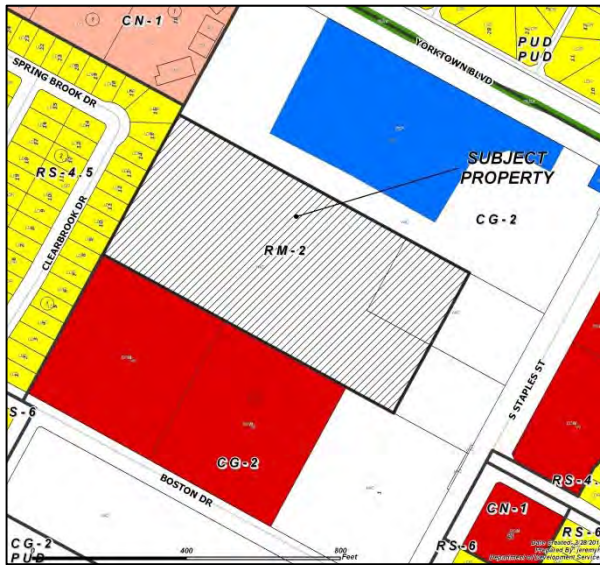

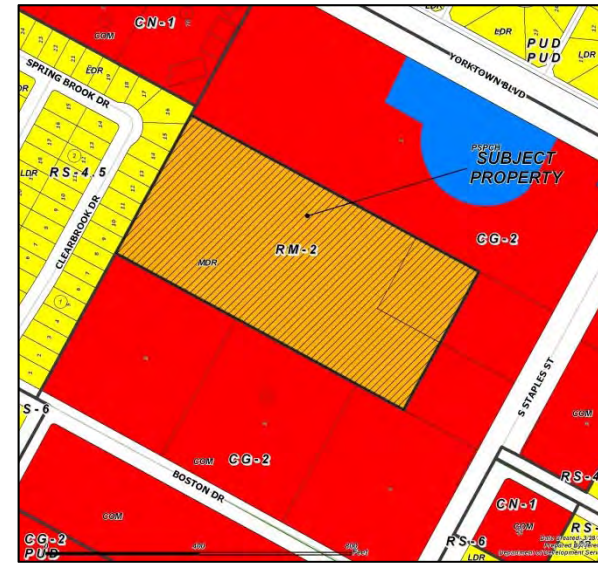

Existing Land Use



Future Land Use

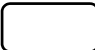

- | | | | | | |
|---|------------|---|----------------------------|---|---------------------|
|  | Commercial |  | Medium Density Residential |  | Professional Office |
|  | Vacant |  | Low Density Residential |  | Public/Semi-Public |



Future Land Use Map





Site Photos



North along South Staples Street (FM 2444)



South along South Staples Street (FM 2444)





Site Photos



Subject Property

Self-storage facility

Residential





Site Photos



Commercial Retail east of Property



Church north of Property





Public Notification



32 Notices mailed inside 200' buffer
4 Notices mailed outside 200' buffer

Notification Area



Opposed: 0



In Favor: 0

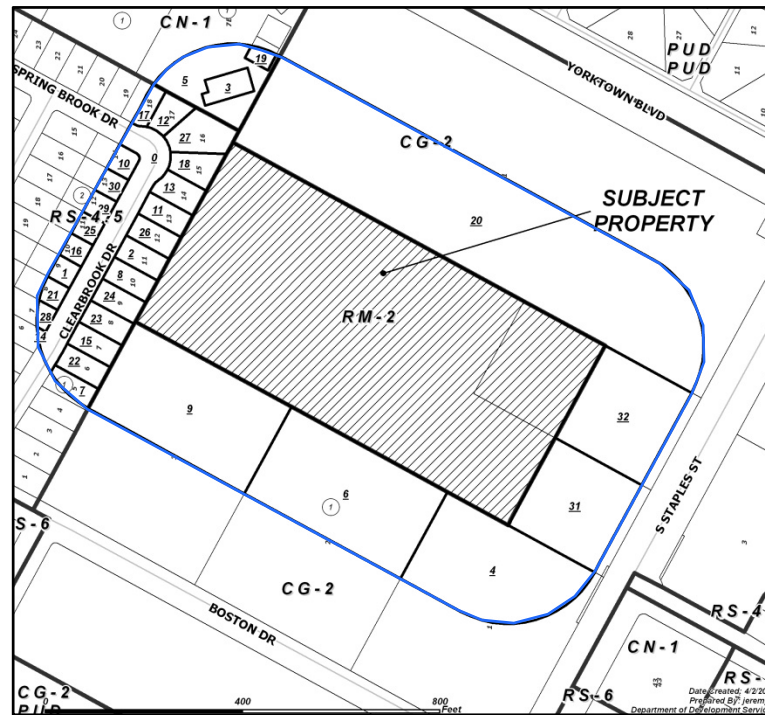



Staff Recommendation



Approval of the "CG-2" General Commercial District