

**Ordinance amending the Unified Development Code (“UDC”), upon application by Coastal Signature Homes, LLC (“Owner”), by changing the UDC Zoning Map in reference to Lot 2, Block 1, River Heights Subdivision (“Property”), from the “ON” Office District to the “RS-4.5” Single Family 4.5 District; amending the Comprehensive Plan to account for any deviations; and providing for a repealer clause and publication.**

**WHEREAS**, the Planning Commission has forwarded to the City Council its final report and recommendation regarding the application of Coastal Signature Homes, LLC (“Owner”), for an amendment to the City of Corpus Christi’s Unified Development Code (“UDC”) and corresponding UDC Zoning Map;

**WHEREAS**, with proper notice to the public, public hearings were held on Wednesday, June 3, 2015, during a meeting of the Planning Commission when the Planning Commission recommended approval of the requested “RS-4.5” Single Family 4.5 District, and on Tuesday, July 14, 2015, during a meeting of the City Council, during which all interested persons were allowed to appear and be heard; and

**WHEREAS**, the City Council has determined that this amendment would best serve the public health, necessity, convenience and general welfare of the City of Corpus Christi and its citizens.

**BE IT ORDAINED BY THE CITY COUNCIL OF THE CITY OF CORPUS CHRISTI, TEXAS:**

**SECTION 1.** Upon application made by Coastal Signature Homes, LLC (“Owner”), the Unified Development Code (“UDC”) of the City of Corpus Christi, Texas (“City”), is amended by changing the zoning of Lot 2, Block 1, River Heights Subdivision, located on the east side of River Walk Drive, near the intersection with Trinity River Drive (the property), from the “ON” Office District to the “RS-4.5” Single Family 4.5 District (Zoning Map No. 068051), as shown in Exhibit “A”. Exhibit “A”, which is a location map of the Property, is attached to and incorporated in this ordinance by reference as if fully set out herein in its entirety.

**SECTION 2.** The official UDC Zoning Map of the City is amended to reflect changes made to the UDC by Section 1 of this ordinance.

**SECTION 3.** The UDC and corresponding UDC Zoning Map of the City, made effective July 1, 2011, and as amended from time to time, except as changed by this ordinance, both remain in full force and effect.

**SECTION 4.** To the extent this amendment to the UDC represents a deviation from the City’s Comprehensive Plan, the Comprehensive Plan is amended to conform to the UDC, as it is amended by this ordinance.

**SECTION 5.** All ordinances or parts of ordinances specifically pertaining to the zoning of the Property and that are in conflict with this ordinance are hereby expressly repealed.

**SECTION 6.** Publication shall be made in the City's official publication as required by the City's Charter.

The foregoing ordinance was read for the first time and passed to its second reading on this the \_\_\_\_\_ day of \_\_\_\_\_, 20\_\_\_\_, by the following vote:

Nelda Martinez	_____	Brian Rosas	_____
Rudy Garza	_____	Lucy Rubio	_____
Chad Magill	_____	Mark Scott	_____
Colleen McIntyre	_____	Carolyn Vaughn	_____
Lillian Riojas	_____		

The foregoing ordinance was read for the second time and passed finally on this the \_\_\_\_\_ day of \_\_\_\_\_, 20\_\_\_\_, by the following vote:

Nelda Martinez	_____	Brian Rosas	_____
Rudy Garza	_____	Lucy Rubio	_____
Chad Magill	_____	Mark Scott	_____
Colleen McIntyre	_____	Carolyn Vaughn	_____
Lillian Riojas	_____		

PASSED AND APPROVED this the \_\_\_\_\_ day of \_\_\_\_\_, 20\_\_\_\_\_.

ATTEST:

\_\_\_\_\_  
Rebecca Huerta  
City Secretary

\_\_\_\_\_  
Nelda Martinez  
Mayor

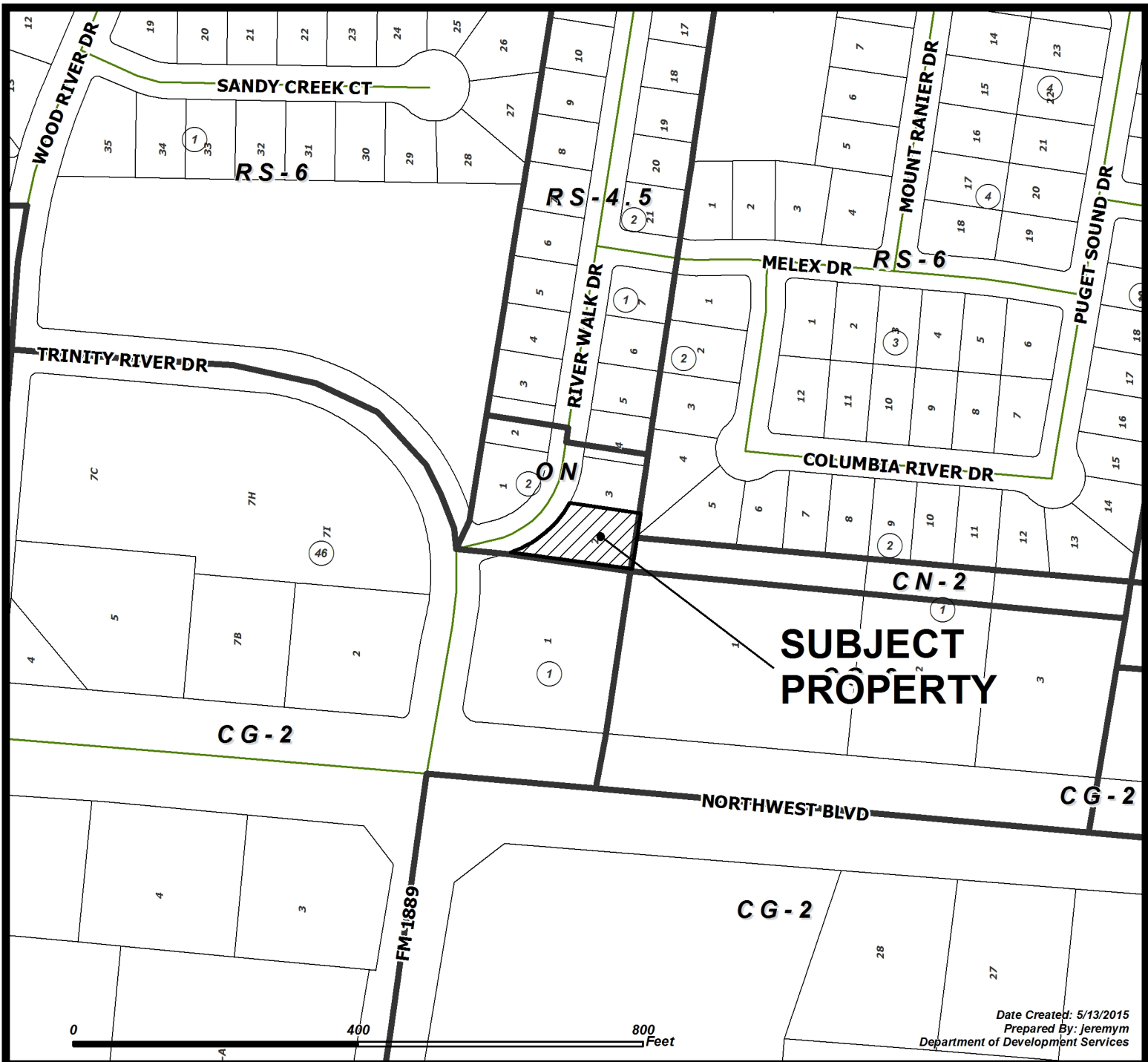

Date Created: 5/13/2015  
 Prepared By: Jeremym  
 Department of Development Services

## CASE: 0615-03

### SUBJECT PROPERTY WITH ZONING

 Subject Property

RM-1 Multifamily 1	IL Light Industrial
RM-2 Multifamily 2	IH Heavy Industrial
RM-3 Multifamily 3	PUD Planned Unit Dev. Overlay
ON Professional Office	RS-10 Single-Family 10
RM-AT Multifamily AT	RS-6 Single-Family 6
CN-1 Neighborhood Commercial	RS-4.5 Single-Family 4.5
CN-2 Neighborhood Commercial	RS-TF Two-Family
CR-1 Resort Commercial	RS-15 Single-Family 15
CR-2 Resort Commercial	RE Residential Estate
CG-1 General Commercial	RS-TH Townhouse
CG-2 General Commercial	SP Special Permit
CI Intensive Commercial	RV Recreational Vehicle Park
CBD Downtown Commercial	RMH Manufactured Home
CR-3 Resort Commercial	
FR Farm Rural	
H Historic Overlay	
BP Business Park	

