



Brister Surveying

4455 South Padre Island Drive Suite 51
Corpus Christi, Texas 78411
Office 361-850-1800
Fax 361-850-1802
bristersurveying@corpus.twcba.com
Firm Registration No. 10072800

**FINAL PLAT OF
ALARCON ADDITION
BLOCK 1, LOTS 1 AND 2**

BEING A FINAL PLAT OF A 4.376 ACRE TRACT OUT OF SHARE 10 OF THE PARTITION OF THE JOHN HARNEY LANDS, AS SHOWN ON THE PLAT RECORDED IN VOLUME 6, PAGE 29, MAP RECORDS OF NUECES COUNTY, TEXAS. SAID 4.376 ACRE TRACT BEING DESCRIBED IN A DEED RECORDED IN DOCUMENT NO. 2015017709, OFFICIAL PUBLIC RECORDS OF NUECES COUNTY, TEXAS AND ALSO BEING OUT OF THE GREGORIO FARIAS GRANT, NUECES COUNTY, TEXAS.

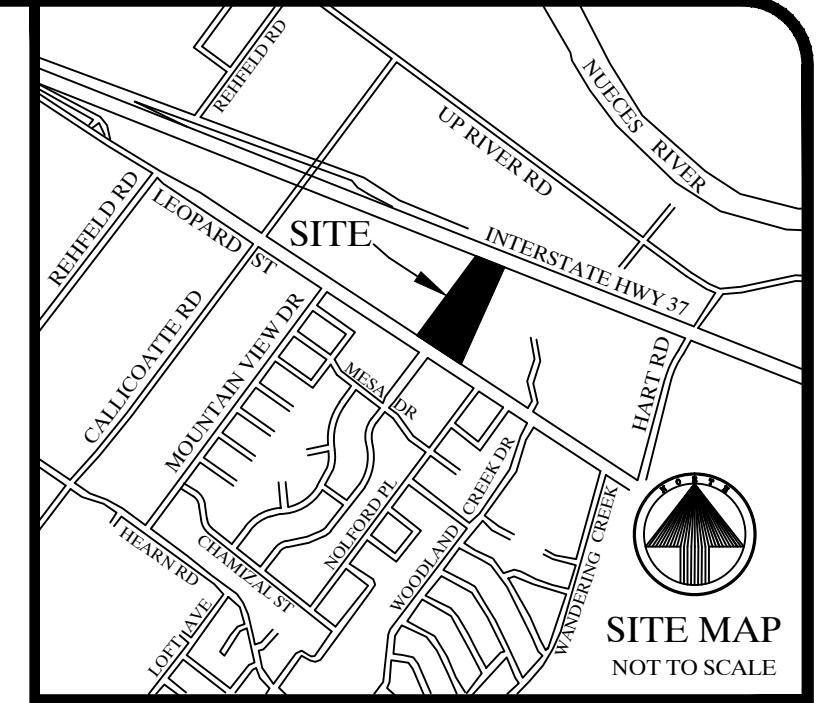

STATE OF TEXAS
COUNTY OF NUECES

I, DANIEL ALARCON, DO HEREBY CERTIFY THAT I AM THE OWNER OF THE PROPERTY SHOWN HEREON, I HAVE HAD SAID LAND SURVEYED AS SHOWN ON THE FOREGOING MAP. THIS MAP HAS BEEN PREPARED FOR THE PURPOSE OF DESCRIPTION AND DEDICATION.

THIS THE _____ DAY OF _____, 2024

DANIEL ALARCON
OWNER

STATE OF TEXAS
COUNTY OF NUECES

BEFORE ME, THE UNDERSIGNED AUTHORITY, ON THIS DAY PERSONALLY APPEARED, DANIEL ALARCON THE PERSON WHOSE NAME IS SUBSCRIBED TO THE FOREGOING INSTRUMENT AND ACKNOWLEDGED TO ME THAT THEY EXECUTED THE SAME AS THE ACT AND DEED OF SAID LANDS FOR THE PURPOSE AND CONSIDERATION THEREIN EXPRESSED, AND IN THE CAPACITY STATED.

GIVEN UNDER MY HAND AND SEAL OF OFFICE.

THIS THE _____ DAY OF _____, 2024

NOTARY PUBLIC

NOTES:

1. THE RECEIVING WATER FOR THE STORM WATER RUNOFF FROM THIS PROPERTY IS THE NUECES RIVER DOWNSTREAM OF THE CALLEN SALTWATER INTRUSION DAM LOCATED 1.1 MILES FROM NUECES BAY. THE TCEQ HAS CLASSIFIED THE AQUATIC LIFE USE FOR THIS SEGMENT OF THE NUECES RIVER AS "HIGH". TCEQ ALSO CATEGORIZED THE NUECES RIVER AS "CONTACT RECREATION" USE.
2. BY GRAPHIC PLOTTING ONLY, THIS PROPERTY IS IN ZONE "X" ON THE FLOOD INSURANCE RATE MAP, COMMUNITY PANEL NO. 48355C 0280 G, WHICH BEARS AN EFFECTIVE DATE OF OCTOBER 13, 2022 AND IS NOT IN A SPECIAL FLOOD HAZARD AREA.
3. MEASURED BEARINGS ARE BASED ON GLOBAL POSITIONING SYSTEM NAD 83 (93) 4205 DATUM.
4. SET 5/8" RE-BAR = STEEL RE-BAR SET WITH YELLOW PLASTIC CAP LABELED BRISTER SURVEYING.
5. THE TOTAL PLATTED AREA IS 4.376 ACRES.
6. THE YARD REQUIREMENT, AS DEPICTED, IS A REQUIREMENT OF THE UNIFIED DEVELOPMENT CODE AND IS SUBJECT TO CHANGE AS THE ZONING MAY CHANGE.
7. IF ANY LOT IS DEVELOPED WITH RESIDENTIAL USES, COMPLIANCE WITH THE OPEN SPACE REGULATION WILL BE REQUIRED DURING THE BUILDING PERMIT PHASE.
8. ACCESS TO INTERSTATE HIGHWAY 37 IS PROHIBITED.

STATE OF TEXAS
COUNTY OF NUECES

THIS FINAL PLAT OF THE HEREIN DESCRIBED PROPERTY WAS APPROVED BY THE PLANNING COMMISSION OF THE CITY OF CORPUS CHRISTI, TEXAS.

THIS THE _____ DAY OF _____, 2024

MICHAEL MILLER
CHAIRMAN

AL RAYMOND III, A.I.A.
SECRETARY

STATE OF TEXAS
COUNTY OF NUECES

THIS FINAL PLAT OF THE HEREIN DESCRIBED PROPERTY WAS APPROVED BY THE DEVELOPMENT SERVICES ENGINEER OF THE CITY OF CORPUS CHRISTI, TEXAS.

THIS THE _____ DAY OF _____, 2024

BRIA A. WHITMIRE, P.E., CFM, CPM
DEVELOPMENT SERVICES ENGINEER

STATE OF TEXAS
COUNTY OF NUECES

APPROVED BY THE CORPUS CHRISTI-NUECES COUNTY HEALTH DEPARTMENT THIS THE _____ DAY OF _____, 2024. ANY PRIVATE SEWAGE SYSTEM SHALL BE APPROVED BY THE CORPUS CHRISTI-NUECES COUNTY HEALTH DEPARTMENT PRIOR TO INSTALLATION.

PUBLIC HEALTH DEPARTMENT

STATE OF TEXAS
COUNTY OF NUECES

I, KARA SANDS, CLERK OF THE COUNTY COURT IN AND FOR NUECES COUNTY, TEXAS, DO HEREBY CERTIFY THAT THE FOREGOING INSTRUMENT DATED THE _____ DAY OF _____, 2024, WITH ITS CERTIFICATE OF AUTHENTICATION WAS FILED FOR RECORD IN MY OFFICE THE _____ DAY OF _____, 2024 AT _____ O'CLOCK _____ M IN SAID COUNTY IN VOLUME _____, PAGE _____ MAP RECORDS.

WITNESS MY HAND AND SEAL OF THE COUNTY COURT, IN AND FOR SAID COUNTY AT MY OFFICE, IN CORPUS CHRISTI, TEXAS, THE DAY AND YEAR LAST WRITTEN.

NO. _____
FILED FOR RECORD

KARA SANDS, CLERK
NUECES COUNTY, TEXAS

BY: _____
DEPUTY:

STATE OF TEXAS
COUNTY OF NUECES

I, RONALD E. BRISTER, A REGISTERED PROFESSIONAL LAND SURVEYOR OF BRISTER SURVEYING, HAVE PREPARED THE FOREGOING MAP FROM A SURVEY MADE ON THE GROUND UNDER MY DIRECTION AND IT IS TRUE AND CORRECT TO THE BEST OF MY KNOWLEDGE, INFORMATION AND BELIEF.

THIS THE _____ DAY OF _____, 2024

RONALD E. BRISTER
REGISTERED PROFESSIONAL LAND SURVEYOR



Brister Surveying

4455 South Padre Island Drive Suite 51
Corpus Christi, Texas 78411
Office 361-850-1800
Fax 361-850-1802
bristersurveying@corpus.twcbc.com
Firm Registration No. 10072800

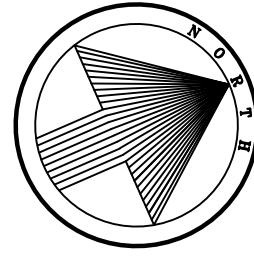

FINAL PLAT OF ALARCON ADDITION BLOCK 1, LOTS 1 AND 2

BEING A FINAL PLAT OF A XXX ACRE TRACT OUT OF SHARE 10 OF THE PARTITION OF THE JOHN HARNEY LANDS, AS SHOWN ON THE PLAT RECORDED IN VOLUME 6, PAGE 29, MAP RECORDS OF NUECES COUNTY, TEXAS. SAID XXX ACRE TRACT BEING DESCRIBED IN A DEED RECORDED IN DOCUMENT NO. 2015017709, OFFICIAL PUBLIC RECORDS OF NUECES COUNTY, TEXAS AND ALSO BEING OUT OF THE GREGORIO FARIAS GRANT, NUECES COUNTY, TEXAS.

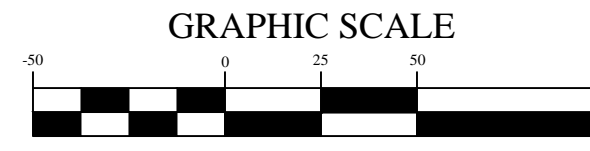

(IN FEET)
1 inch = 50 ft.

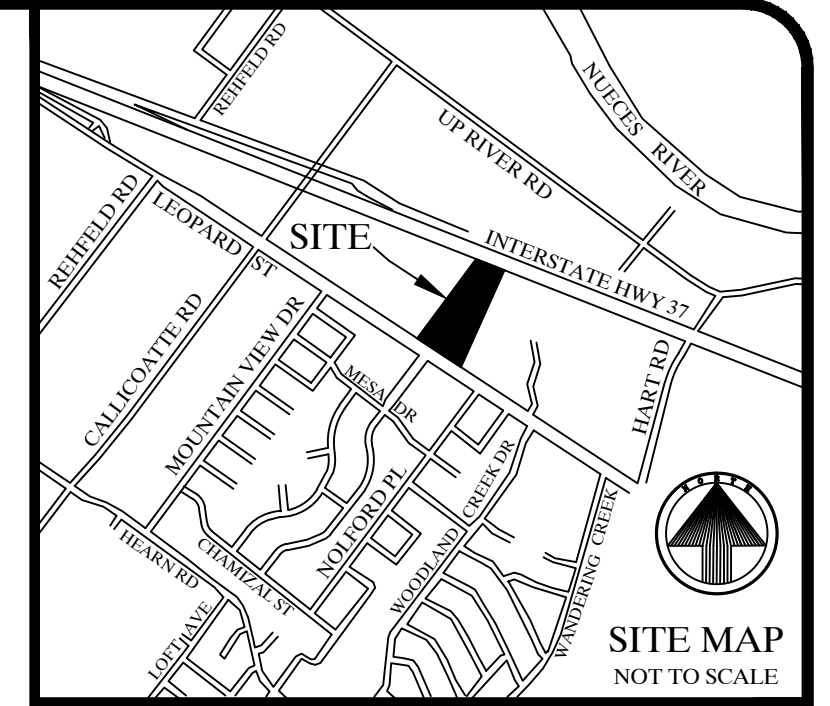

SITE MAP
NOT TO SCALE

NOTES:

1. THE RECEIVING WATER FOR THE STORM WATER RUNOFF FROM THIS PROPERTY IS THE NUECES RIVER DOWNSTREAM OF THE CALALLEN SALTWATER INTRUSION DAM LOCATED 1.1 MILES FROM NUECES BAY. THE TCEQ HAS CLASSIFIED THE AQUATIC LIFE USE FOR THIS SEGMENT OF THE NUECES RIVER AS "HIGH". TCEQ ALSO CATEGORIZED THE NUECES RIVER AS "CONTACT RECREATION" USE.
2. BY GRAPHIC PLOTTING ONLY, THIS PROPERTY IS IN ZONE "X" ON THE FLOOD INSURANCE RATE MAP, COMMUNITY PANEL NO. 48355C 0280 G, WHICH BEARS AN EFFECTIVE DATE OF OCTOBER 13, 2022 AND IS NOT IN A SPECIAL FLOOD HAZARD AREA.
3. MEASURED BEARINGS ARE BASED ON GLOBAL POSITIONING SYSTEM NAD 83 (93) 4205 DATUM.
4. SET 5/8" RE-BAR = STEEL RE-BAR SET WITH YELLOW PLASTIC CAP LABELED BRISTER SURVEYING.
5. THE TOTAL PLATTED AREA IS 4.376 ACRES.
6. THE YARD REQUIREMENT, AS DEPICTED, IS A REQUIREMENT OF THE UNIFIED DEVELOPMENT CODE AND IS SUBJECT TO CHANGE AS THE ZONING MAY CHANGE.
7. IF ANY LOT IS DEVELOPED WITH RESIDENTIAL USES, COMPLIANCE WITH THE OPEN SPACE REGULATION WILL BE REQUIRED DURING THE BUILDING PERMIT PHASE.
8. ACCESS TO INTERSTATE HIGHWAY 37 IS PROHIBITED.

- = SET 5/8" RE-BAR
- = FOUND 5/8" RE-BAR

LEGEND:
 B.L. = BUILDING LINE
 CL = CENTERLINE
 D.E. = DRAINAGE EASEMENT
 DOC. NO. = DOCUMENT NUMBER
 M.R.N.C.T. = MAP RECORDS OF NUECES COUNTY, TEXAS
 PG. = PAGE
 S.F. = SQUARE FEET
 U.E. = UTILITY EASEMENT
 VOL. = VOLUME
 Y.R. = YARD REQUIREMENT

LEOPARD STREET
(STATE HIGHWAY NO. 9)
160' RIGHT OF WAY

