

Reclaimed Water for Industrial Reuse Construction Manager-At-Risk (CMAR) Contract Amendment No. 1

Nicholas J. Winkelmann, P.E.
Chief Operating Officer – Corpus Christi
June 30, 2026

Project Purpose

- This project will deliver non-potable water from the Oso Water Reclamation Plant (WRP) to the Greenwood WRP to support industrial reuse of reclaimed water
- Increasing the utilization of reclaimed water for industry will reduce the demand and reliance on the potable water system
- Expanding water reuse capacity is a key component of the City's long-term water supply strategy



Project Scope

Proposed construction:

- Reclaimed Water Pump Station and Wet Well at the Oso WRP
- Approx. 10.5 miles of 36-inch force main to convey reclaimed water from the Oso WRP to the Greenwood WRP
- Electrical, mechanical, and other associated infrastructure

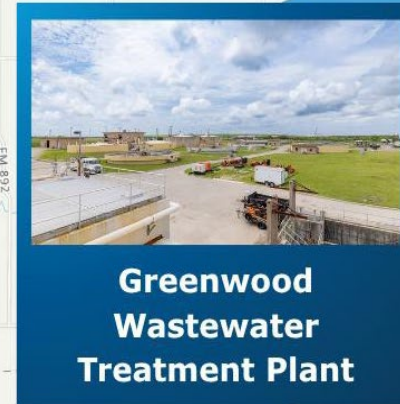

**Greenwood
Wastewater
Treatment Plant**

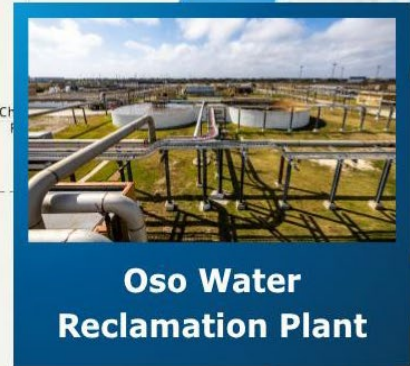

**Oso Water
Reclamation Plant**

Agenda Item Overview

- One-reading emergency ordinance authorizing the execution of a Construction Manager-At-Risk (CMAR) contract amendment with Reytec Construction Resources Inc., transitioning the project into Phase 2 (Full Construction Services)
- Establishes the Guaranteed Maximum Price (GMP) for total construction of the project
- Amends the FY 2026 Capital Budget, with funding available from the Water Capital Fund
- Authorizes the reimbursement resolution for capital expenditures

GMP Development

- The GMP was developed through a collaborative process between the City, Ardurra, and Reytec, using CMAR open book procurement
- The GMP reflects current market conditions and competitive subcontractor pricing, provides cost transparency, and establishes a high level of confidence in the total project budget
- Procurement conducted through Competitive Sealed Proposals (CSP), with subcontractor selection based on best value
- Subcontractor bid packages have been issued and received, supporting development of market-based construction pricing

CMAR Delivery Strategy

Transmission main divided into four pipeline segments to support accelerated project delivery by enabling multiple construction crews to work concurrently

NOTE:
THE TOPOGRAPHY SHOWN FOR THIS PROJECT WAS REVIEWED BY ARCADIA ON
FEBRUARY 2008 AND IS BASED ON NORTH AMERICAN DATUM OF 1983 (NAD 83)
TERRAIN STATE PLANE COORDINATES, SOUTH ZONE (NAD83).

BENCHMARK & CONSTRUCTION CONTROL INFORMATION							
NO.		NO.	NO.	NO.		NO.	
BM-2000	SEE SHEETS C1-C4	BM-2006		BM-2010		BM-2020	
CP-1000		CP-1008		BM-2013		CP-1022	
CP-999		BM-2007		CP-1010		BM-2001	
BM-2021		BM-2008		CP-1003		CP-1005	
CP-1021	SEE BASILINE A SHEETS TM1-TM7	CP-1009	SEE BASILINE B SHEETS TM8-TM10	CP-1018	SEE BASILINE C SHEETS TM11-TM15	BM-2022	SEE BASILINE C SHEETS TM11-TM15
BM-2002		BM-2010		BM-2014		BM-2023	
CP-1002		CP-1012		CP-1017		BM-2025	
BM-2003		BM-2011		BM-2016		CP-1025	
BM-2004		CP-1011		CP-1019		BM-2024	
CP-1004		CP-1012		BM-2017		CP-1026	
CP-1005		CP-1013		BM-2020		CP-1027	
BM-2005		BM-2012		BM-2018		BM-2028	
CP-1008		BM-2013		CP-1020		BM-2029	
CP-1007		CP-1021		CP-1028		CP-1029	

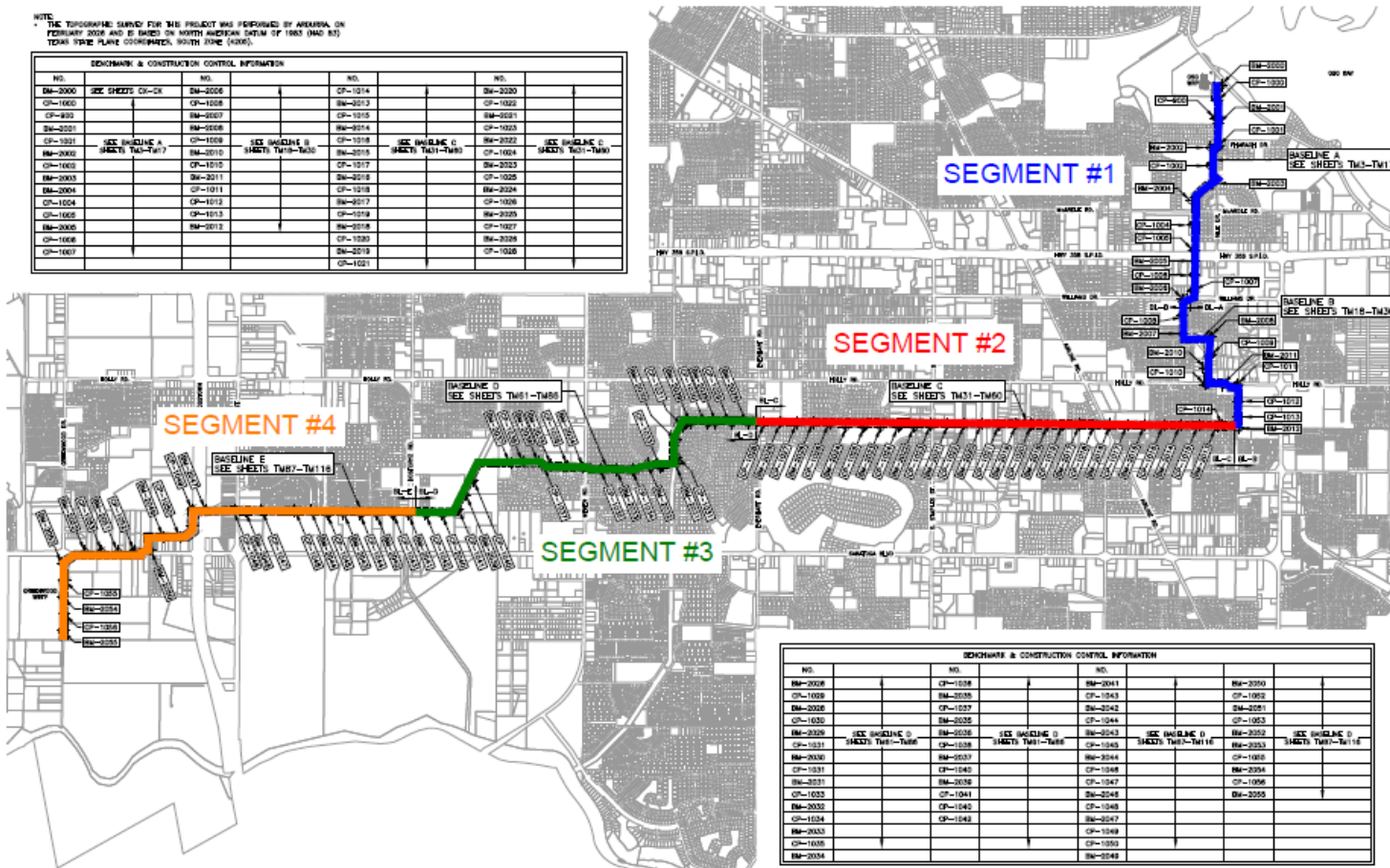

BENCHMARK & CONSTRUCTION CONTROL INFORMATION							
NO.		NO.		NO.		NO.	
BM-2028		CP-1018		BM-2041		BM-2050	
CP-1009		BM-2005		CP-1043		CP-1052	
BM-2029		CP-1017		BM-2042		BM-2051	
CP-1020		BM-2035		CP-1044		CP-1053	
BM-2026	SEE BASILINE D SHEETS TM1-TM6	BM-2036	SEE BASILINE D SHEETS TM1-TM6	BM-2043	SEE BASILINE D SHEETS TM1-TM16	BM-2052	SEE BASILINE D SHEETS TM1-TM16
CP-1031		CP-1038		CP-1045		BM-2053	
BM-2030		BM-2037		BM-2044		CP-1054	
CP-1031		CP-1040		CP-1046		BM-2054	
BM-2031		BM-2038		CP-1047		CP-1056	
CP-1032		CP-1041		BM-2048		BM-2055	
BM-2032		CP-1042		CP-1048			
CP-1034		CP-1043		BM-2047			
BM-2033		CP-1044		CP-1049			
CP-1035		CP-1045		CP-1050			
BM-2034		BM-2049		BM-2056			

CMAR Delivery Strategy

- Construction of a new pump station and wet well at Oso WRP to include:
 - Vertical turbine pumps
 - Electrical systems (switchgear and transformers)
 - Instrumentation and SCADA integration
 - Structural components (foundations and caissons)

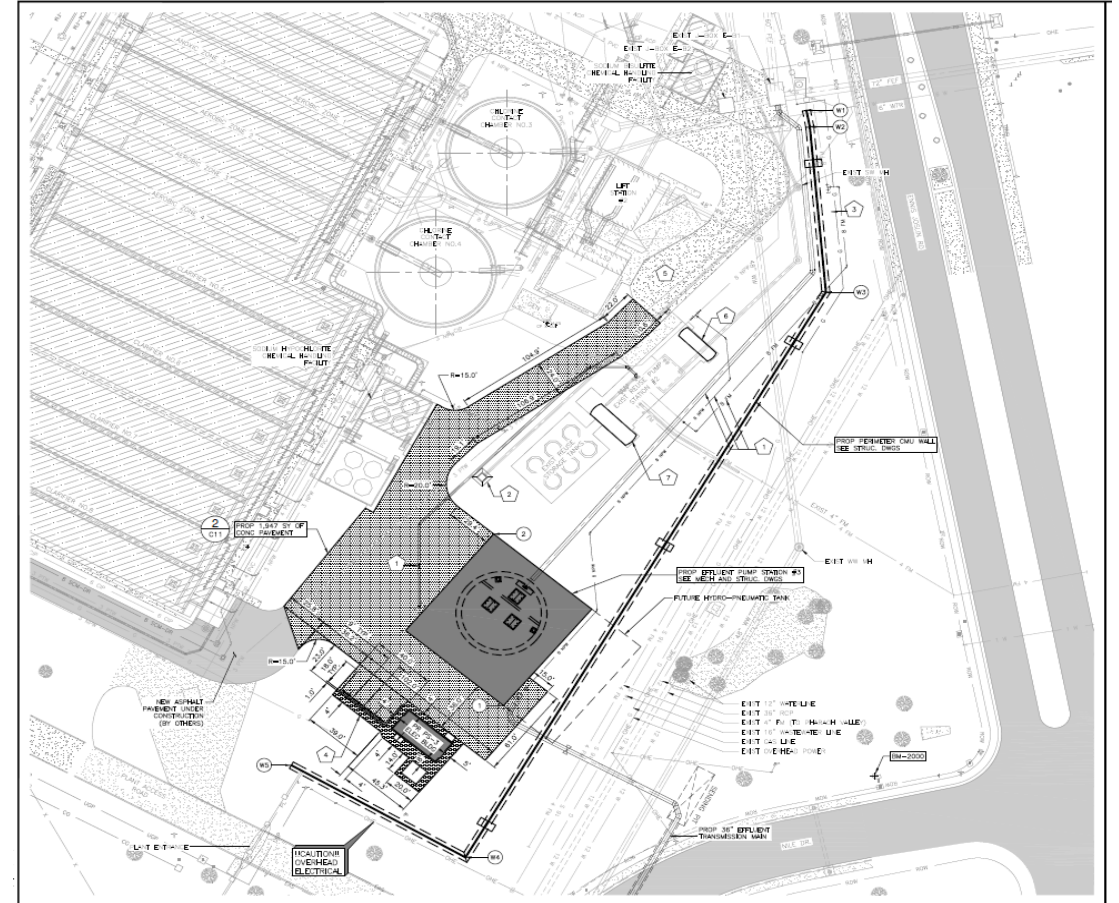

Schedule

- Early work and procurement currently underway to maintain schedule
- Project delivery through concurrent construction work packages
- Multiple crews working simultaneously to accelerate delivery

Project Schedule	
Milestone	Date
GMP Approval (City Council)	June 30, 2026
Construction Start (Phase 2)	Late June / July 2026
Final Design Completion	July 2026
Substantial Completion	May 24, 2027

Project Timeline

2025 - 2026	2026 - 2026	2026 - 2027
November - July	May - June	June - May
Design	Construction	
	Phase 1	Phase 2

Projected schedule reflects City Council award of Phase 2 Construction in June 2026 with anticipated construction completion in May 2027.

Emergency Declaration

This ordinance is presented as an emergency measure. Under an Emergency Declaration, the City Council declares an emergency due to the need for immediate action necessary for the efficient and effective administration of City affairs. Immediate approval of the Phase 2 CMAR Contract Amendment and associated GMP is necessary to avoid schedule delays that could adversely impact project delivery.

Fiscal Impact

- Project Funding Overview
 - Phase 1 (Pre-Construction + Early Work): \$16,194,400
 - Phase 2 (Construction): \$91,337,220
 - Total Project Cost (GMP): \$107,531,622
- GMP includes:
 - All construction work packages (pipeline segments + pump station)
 - Procurement of long-lead materials and major equipment
 - CMAR general conditions, fees, and contingencies
 - Complete system installation (pipeline, pump station, SCADA, electrical)

Staff Recommendation

- Approval of the CMAR Contract Amendment with Reytec Construction Resources, Inc., transitioning the project from pre-construction (phase 1) to full construction services (phase 2)
- Establish the GMP, providing a not-to-exceed cost for complete project delivery, including the force main, pump station, and associated infrastructure
- Approval of this item will:
 - Maintain project schedule and construction momentum
 - Reduce cost and schedule risks through market-based pricing
 - Enable coordinated, multi-front construction, accelerating the overall project delivery



CITY OF CORPUS CHRISTI
**CORPUS CHRISTI
WATER**