



Zoning Case #0514-01 Lutheran Properties, Inc.

From: "ON" Office District
To: "ON/SP" Office District with a Special Permit



Planning Commission
May 7, 2014



Aerial Overview





Aerial





Site Plan

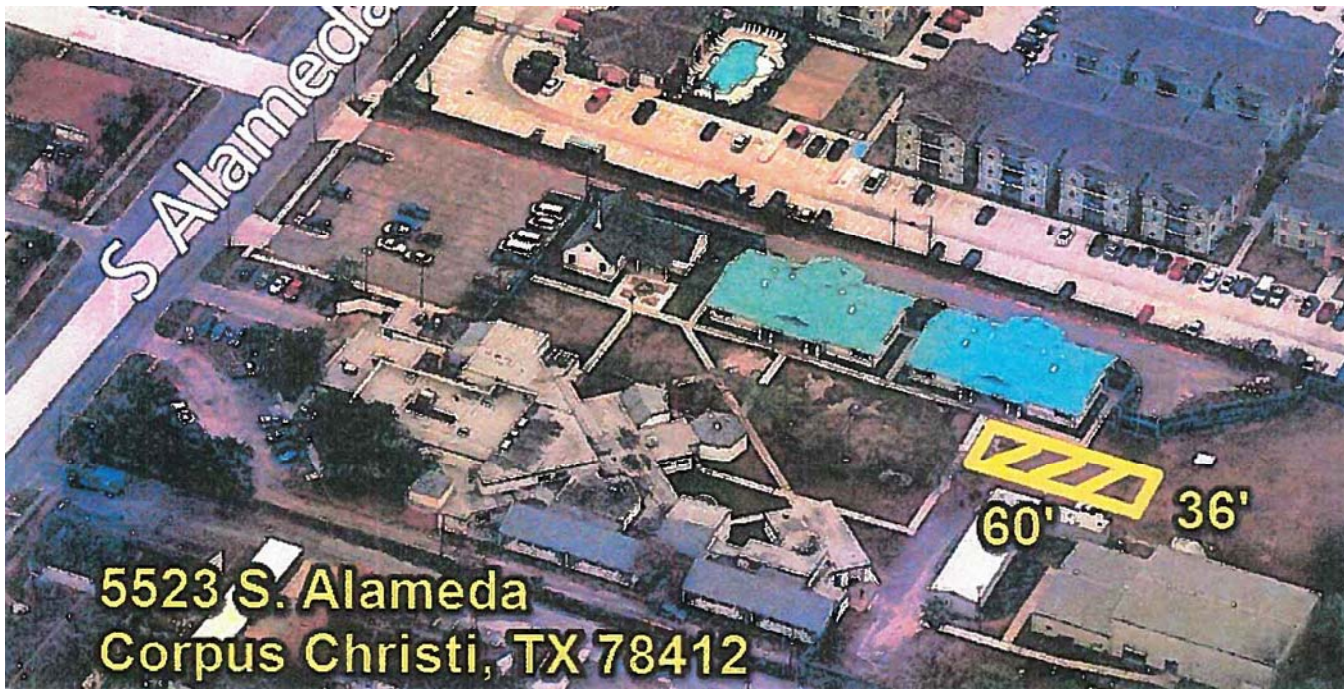



Existing Land Use

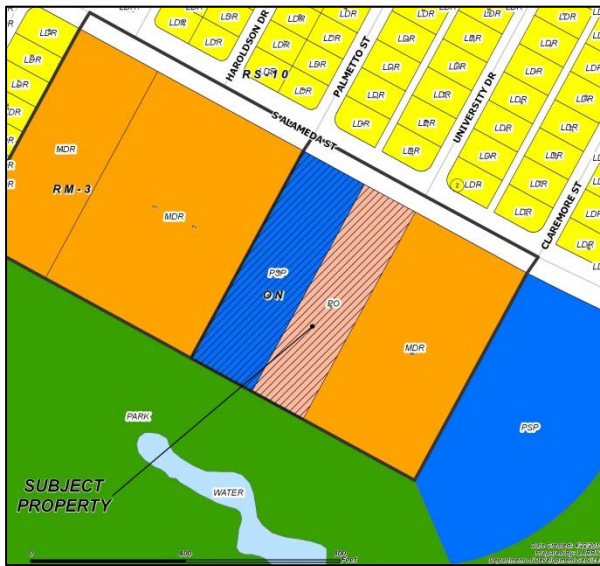

Future Land Use

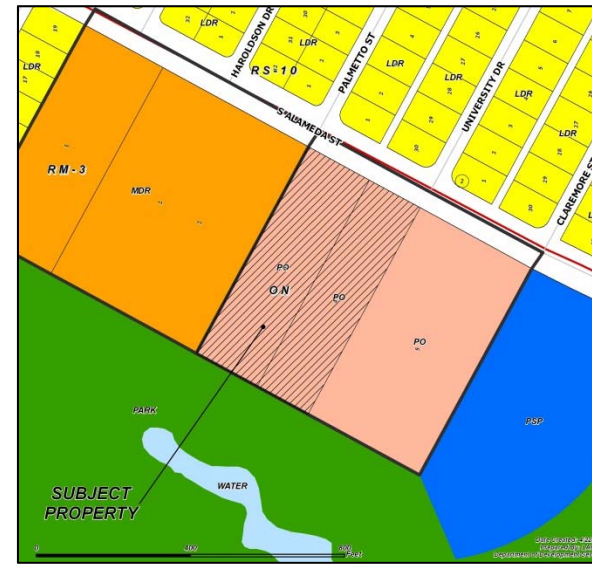

- Public Semi Public
- Medium Density Residential
- Park
- Professional Office
- Low Density Residential



Site Photos



Residential- North across S. Alameda Street



Church on Subject Property





Site Photos



Subject Property (Administration Building)





Site Photos



Apartments east of property



Apartments west of property





Public Notification



12 Notices mailed inside 200' buffer
5 Notice mailed outside 200' buffer

Notification Area



Opposed: 0



In Favor: 0

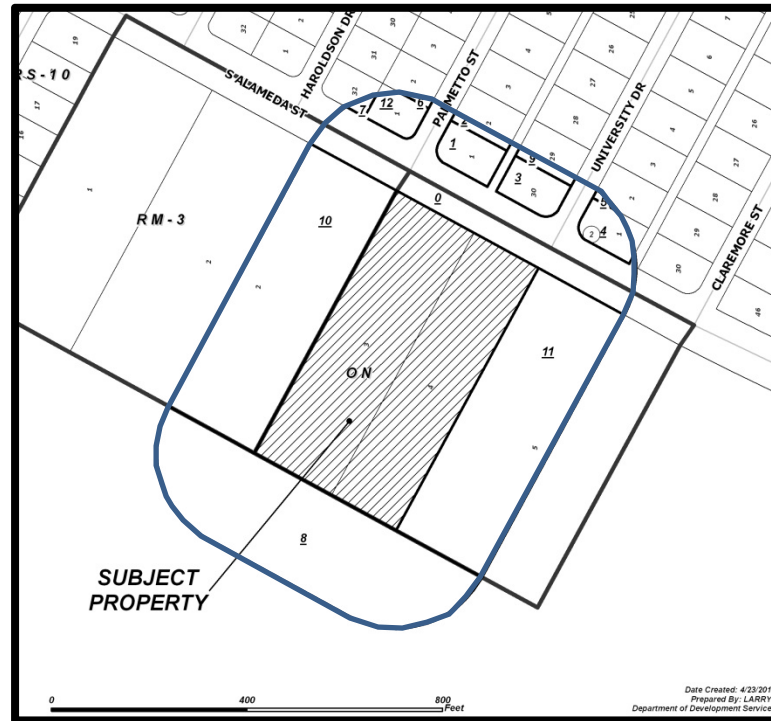



Staff Recommendation



Approval of the
“ON” Office District with a Special
Permit