

The American Bank Center, renovated and expanded in the mid 2000s, includes the Selena Auditorium, expanded Convention Center and the ABC Arena. The renovated and expanded facility includes new and existing conditions which would be resolved by further modification.

Existing Structure

EXPANSION

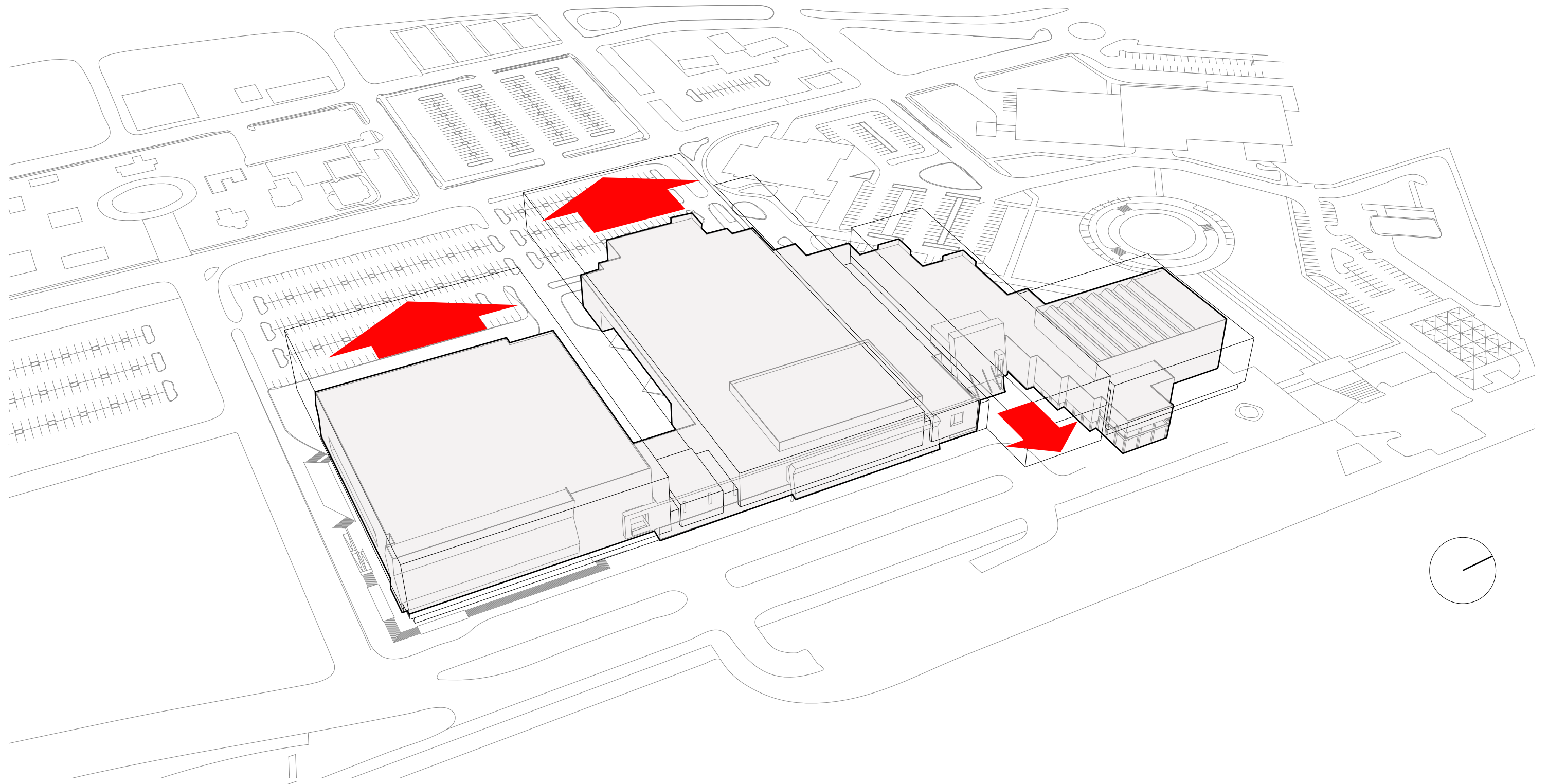

The proposed renovation and expansion is based upon the expansion program recommended by HVS as well as past experience with similar centers. It includes the linear expansion and renovation of the entry sequence, exhibition halls and meeting rooms, arena support and auditorium refinement.

Extruded Bar Concept

EXPANSION

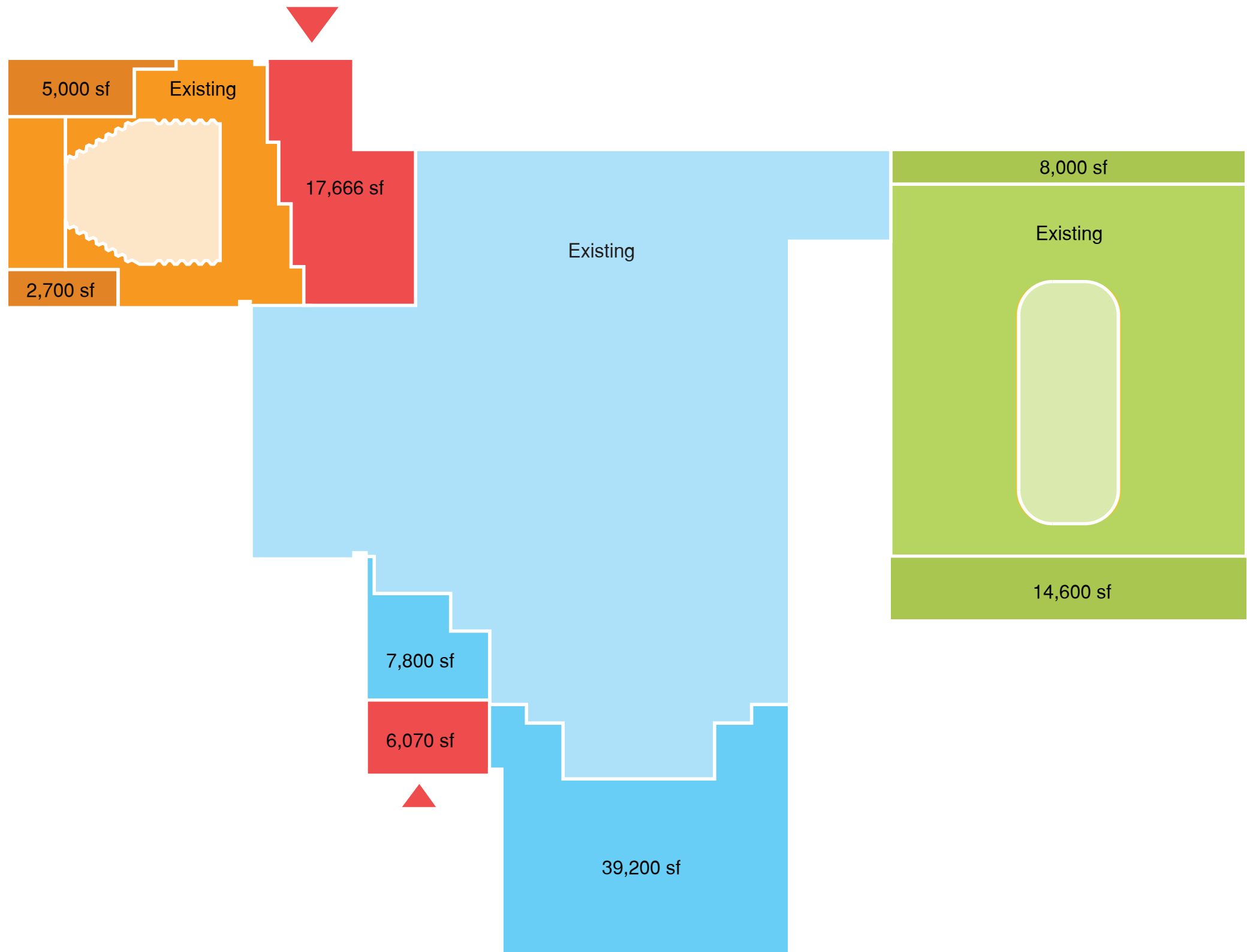

- THEATRE
- LOBBY
- CONVENTION CENTER
- ARENA

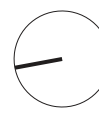
 CONVENTION CENTER LEVEL 1
SCALE: 1/128" = 1'-0"

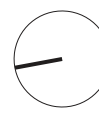

- THEATRE
- LOBBY
- CONVENTION CENTER
- ARENA

 CONVENTION CENTER LEVEL 2
SCALE: 1/128" = 1'-0"

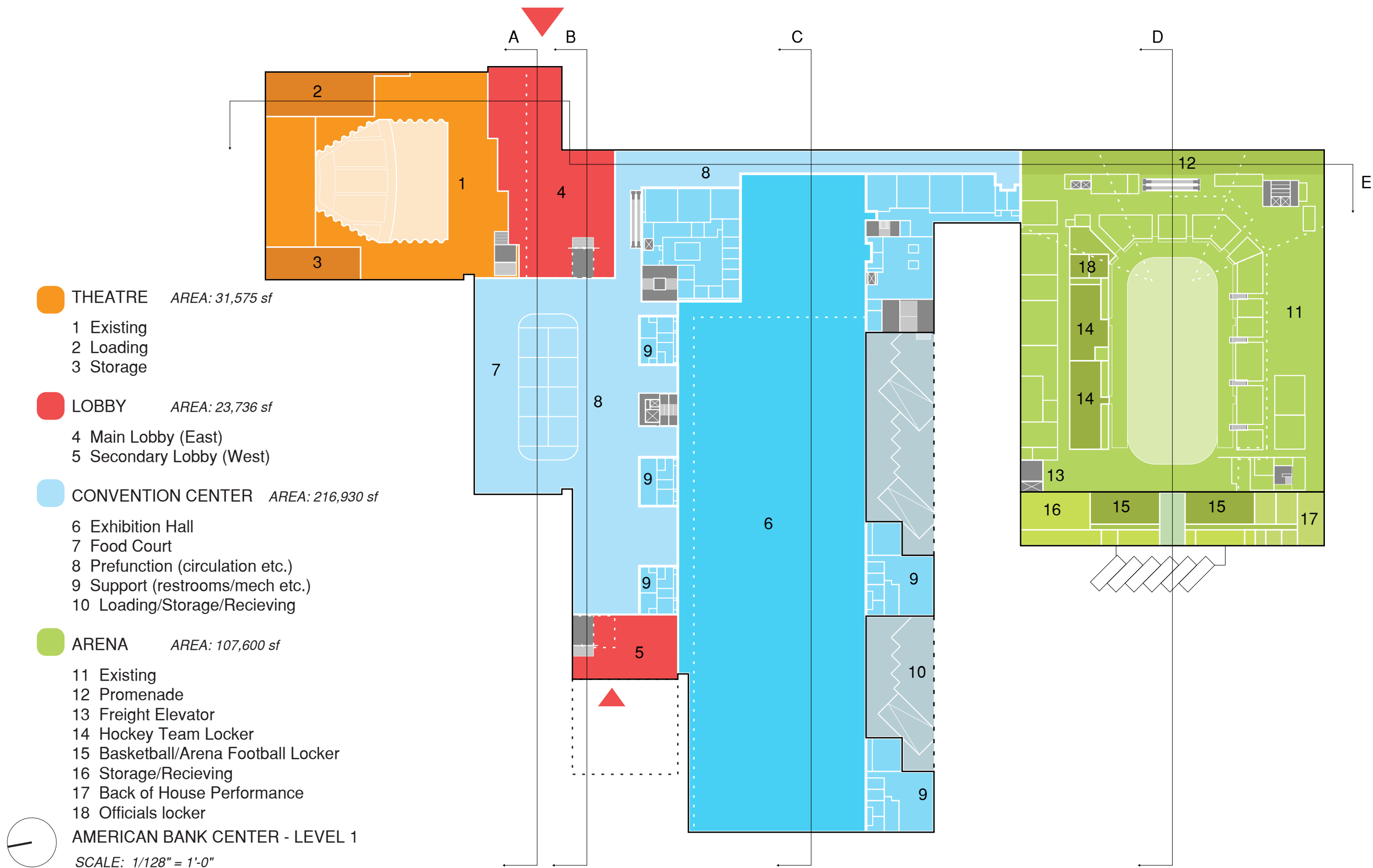

Level 1 Plan showing revisions to the theater, entry lobby sequence, and pre-function and food court zones of the convention center. The exhibit halls are also expanded to the west and include new dock and support/loading space. The arena includes a proposed lobby expansion to accommodate circulation from the south hotel site as well as renovations to existing locker rooms, a new freight elevator and expanded support to the west to accommodate additional facilities.

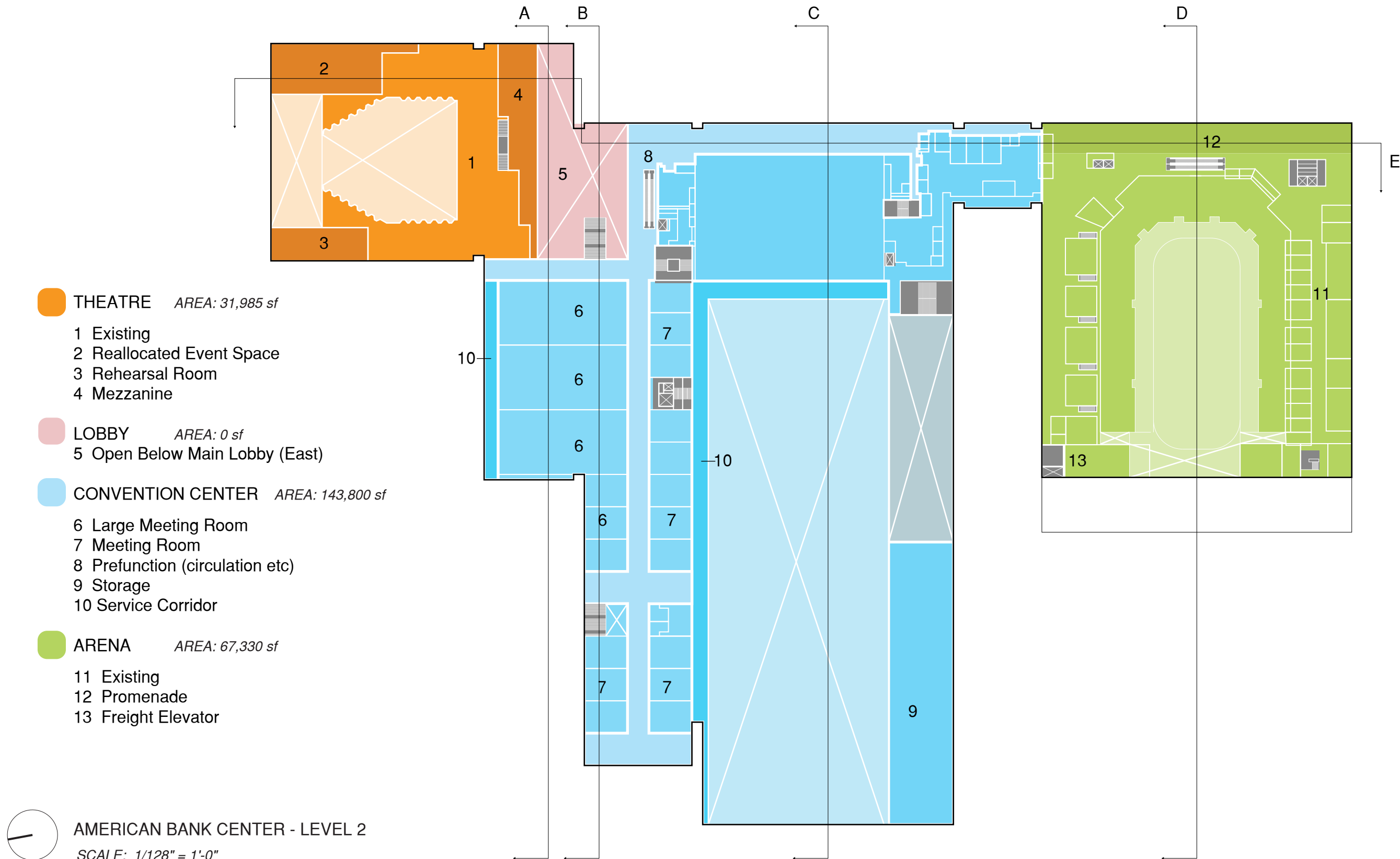

Level 2 Plan showing revisions to the theater, entry lobby sequence, and pre-function and meeting level of the convention center. The meeting level includes reconfigured junior ballroom facilities as well as substantial increases in meeting room spaces supported by service corridors.. The arena includes a proposed lobby expansion to accommodate circulation from the south hotel site as well as a new freight elevator.

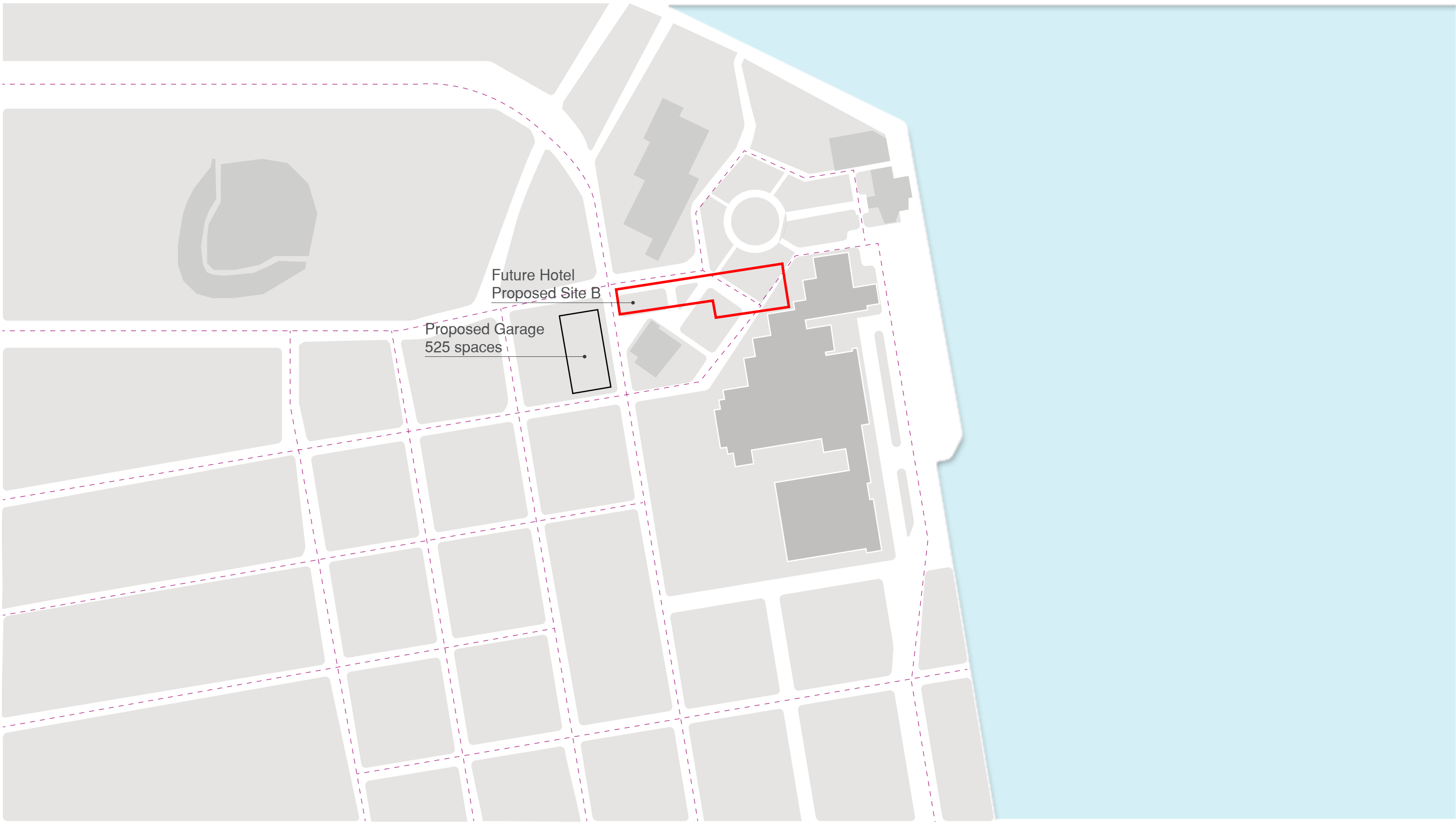

Site B displaces parking. Thus the proposed hotel project may include a parking garage on existing parking lots, connected to the new hotel by a skybridge, which includes displaced and new parking to support the ABC and the hotel.

Site B

HOTEL STUDY

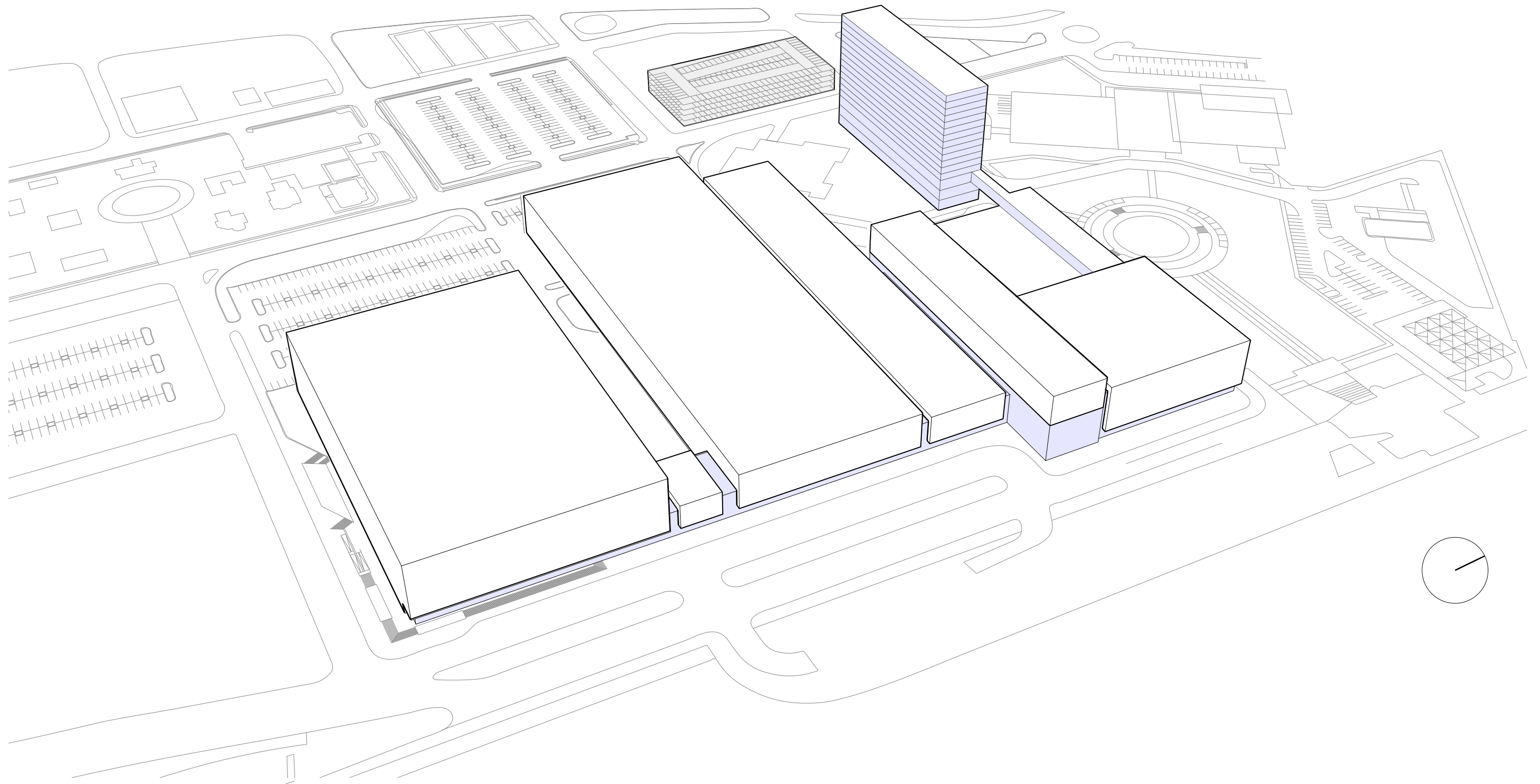
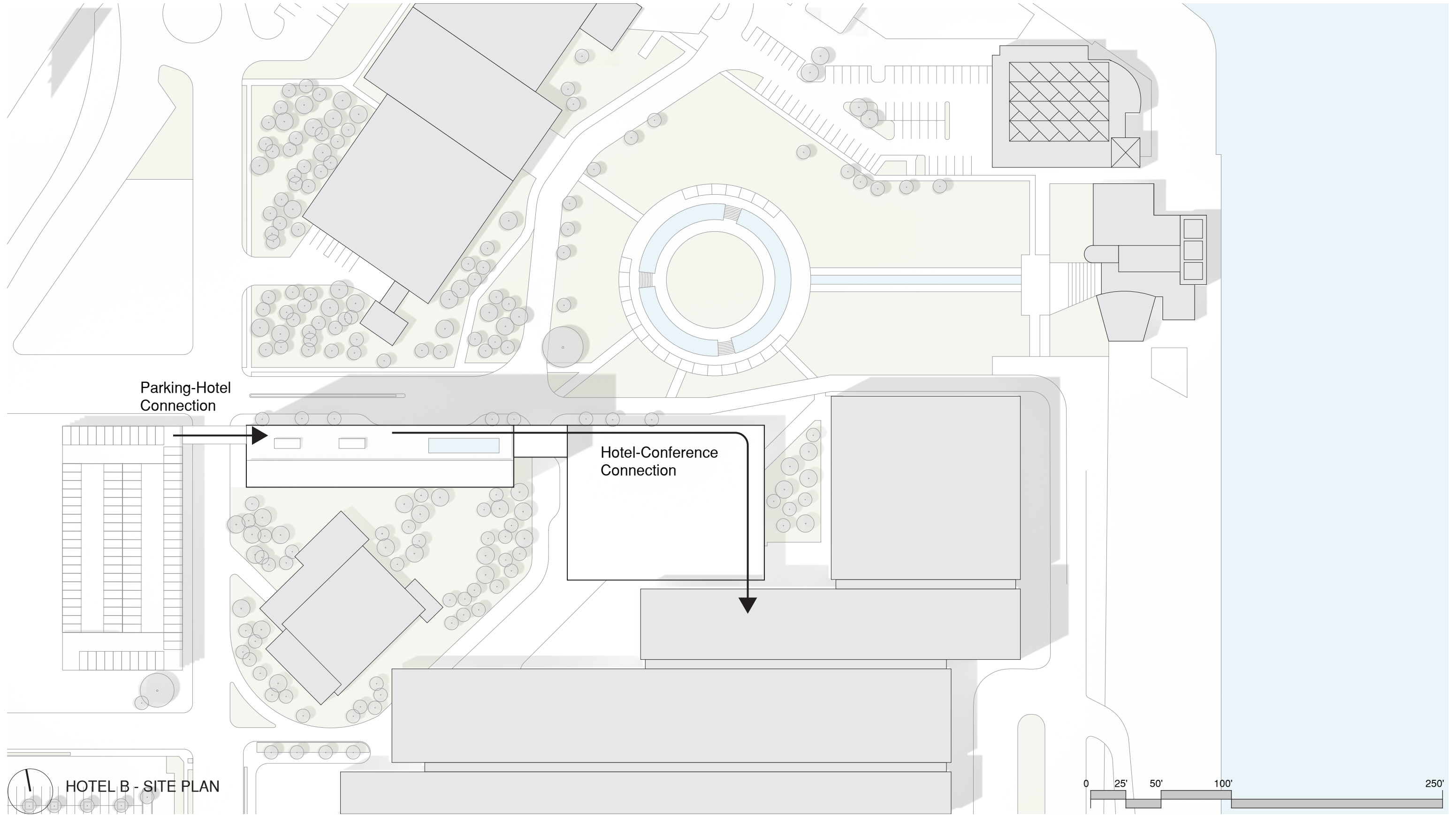

Diagram showing the relationship of the Site B hotel in relation to the new entry sequence and the existing theater. The hotel tower, which includes the restaurant, lobby lounge, guest services, health club and spa, is separated from the meeting room/ballroom wing.



HOTEL B - SITE PLAN

Diagram indicating the proposed circulation route for patrons moving to and from the hotel to the convention center and connectivity to the parking garage

Connection

HOTEL STUDY

- LOBBY
- RESTAURANT
- BALLROOM
- SUPPORT / B.O.H.
- SPA / FITNESS
- ADMIN / EMPLOYEE SUPPORT
- HOUSEKEEPING / MEP
- HOTEL ROOMS
- ROOF TERRACE

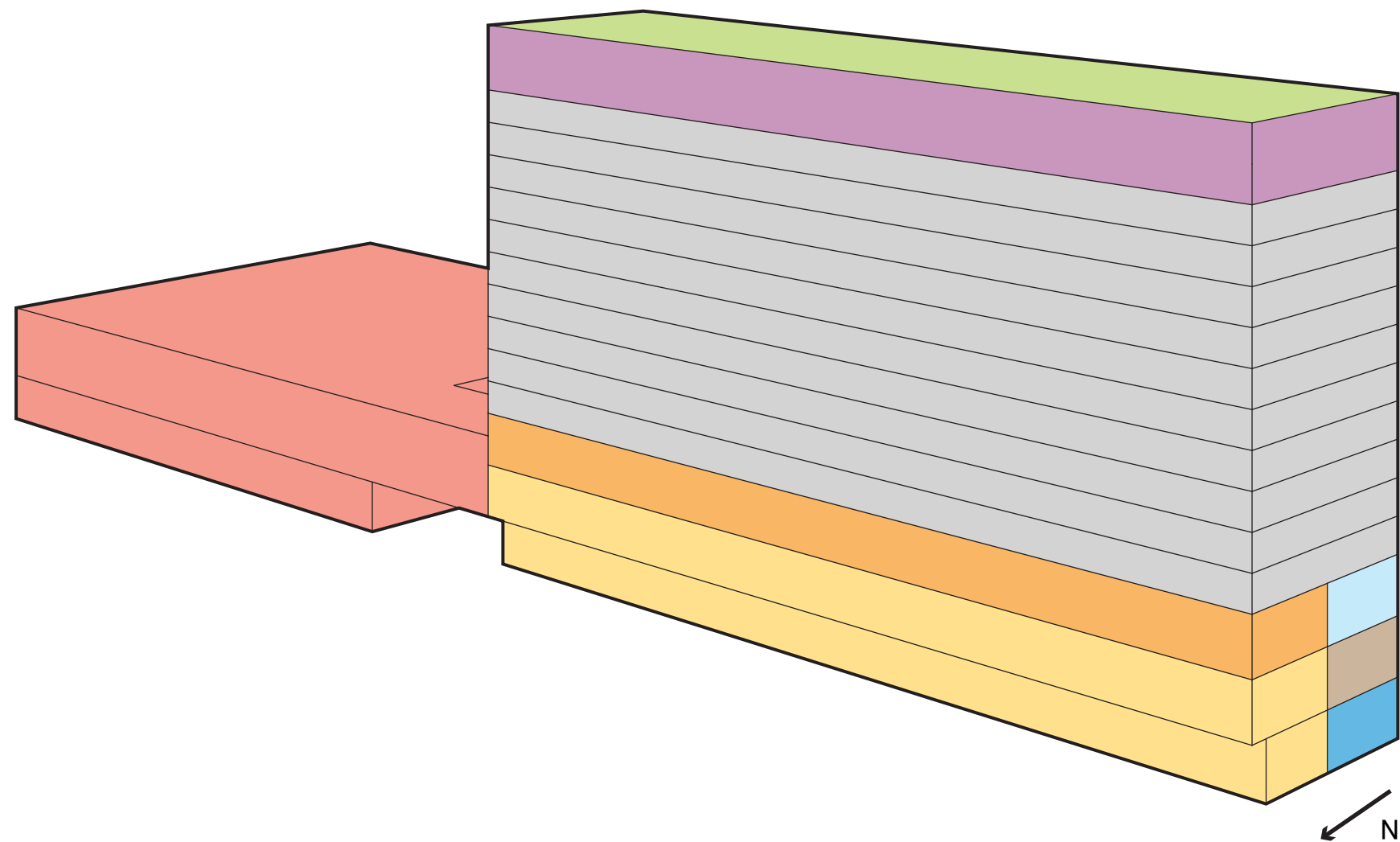

HOTEL B - PROGRAM MASSING

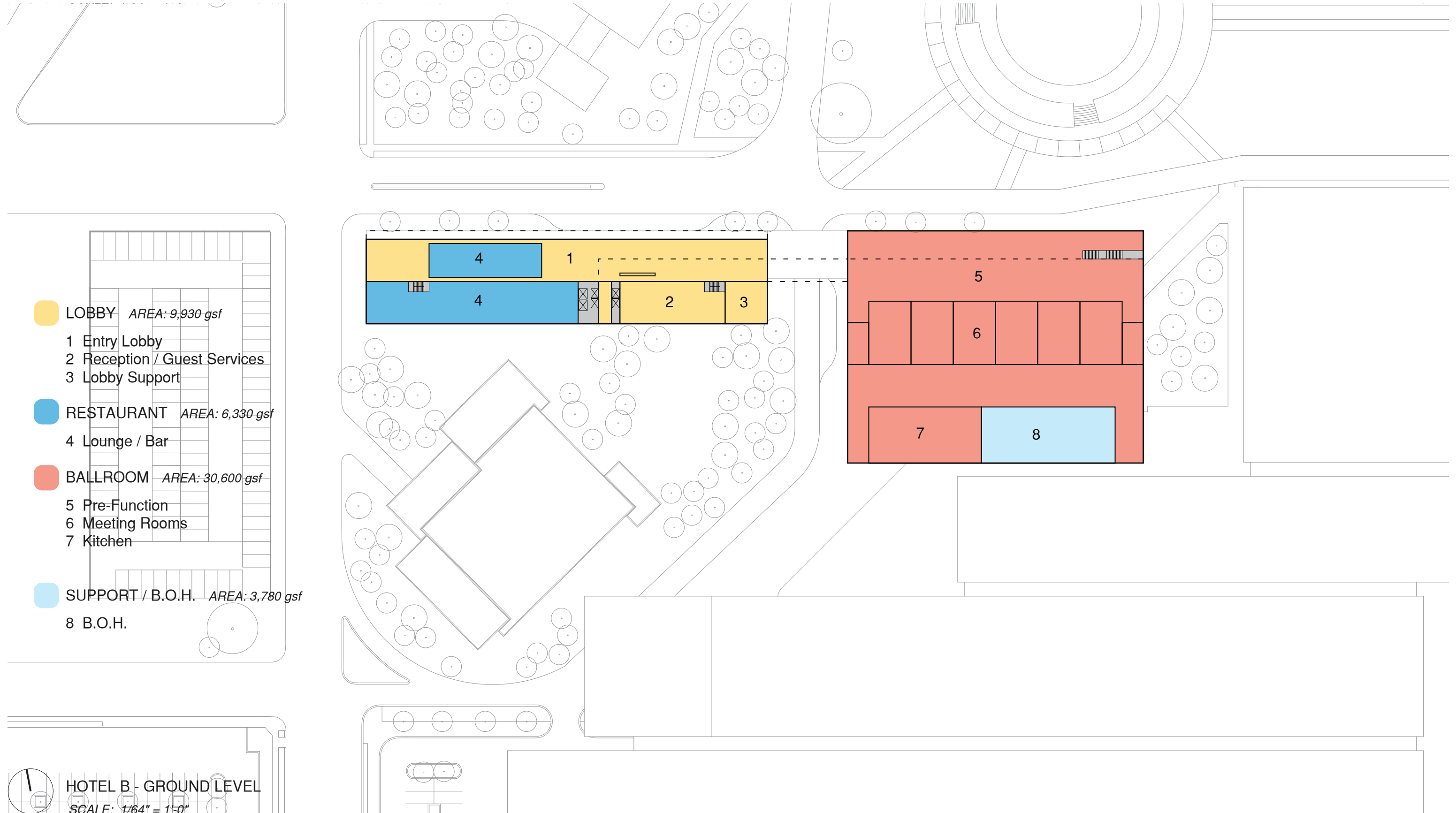

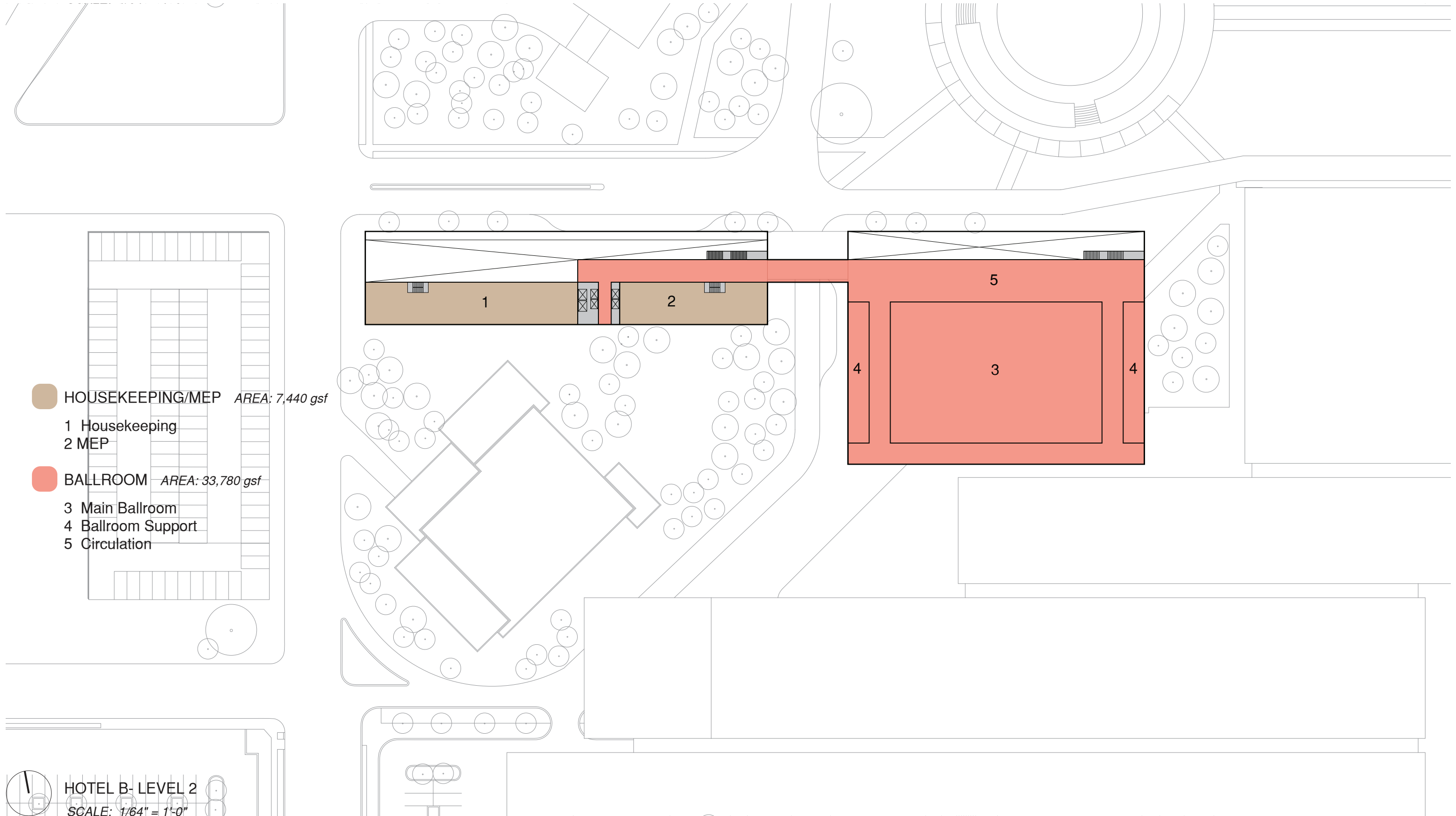

- HOUSEKEEPING/MEP** AREA: 7,440 gsf
 - 1 Housekeeping
 - 2 MEP
- BALLROOM** AREA: 33,780 gsf
 - 3 Main Ballroom
 - 4 Ballroom Support
 - 5 Circulation

HOTEL B- LEVEL 2
 SCALE: 1/64" = 1'-0"

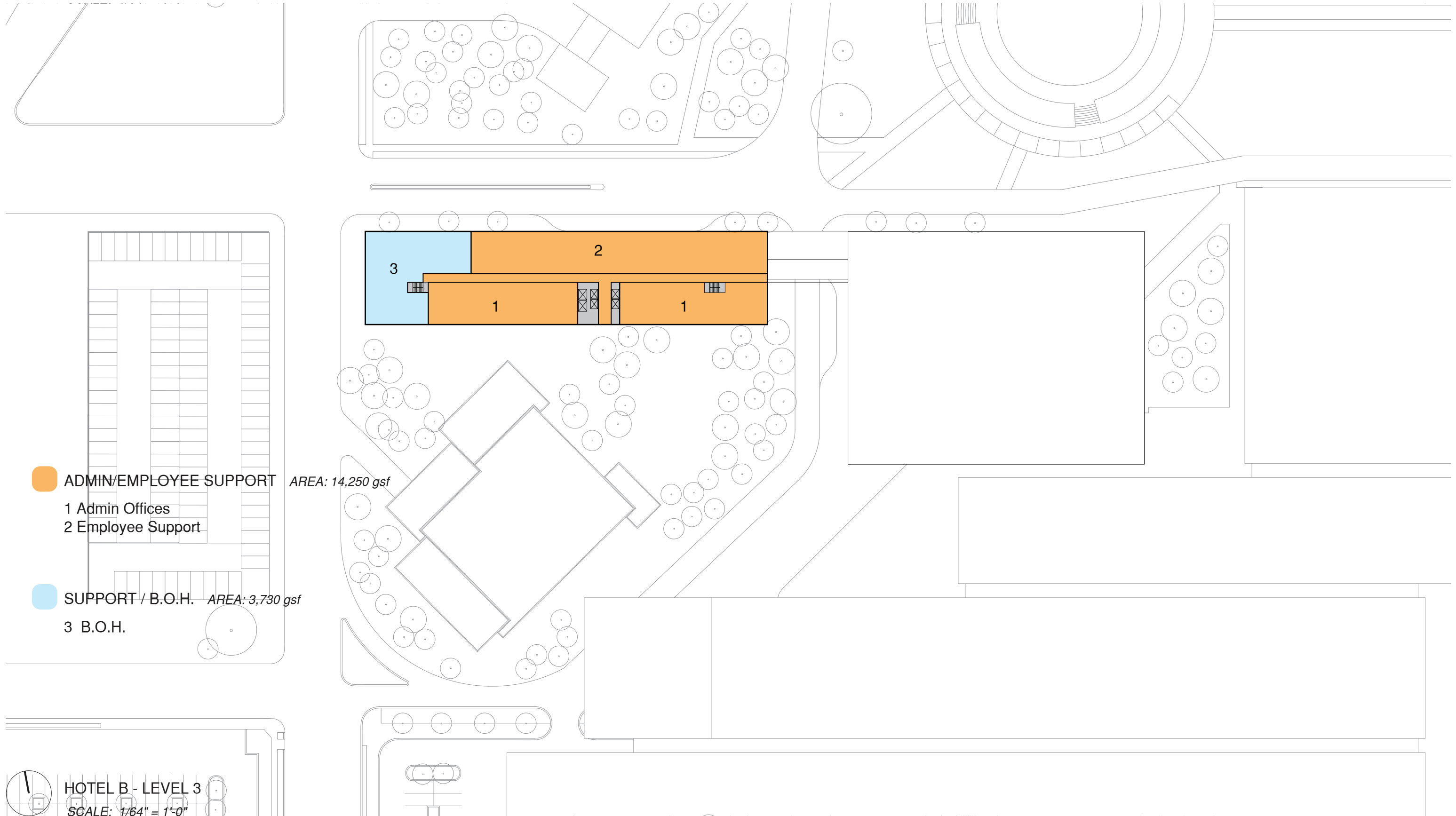

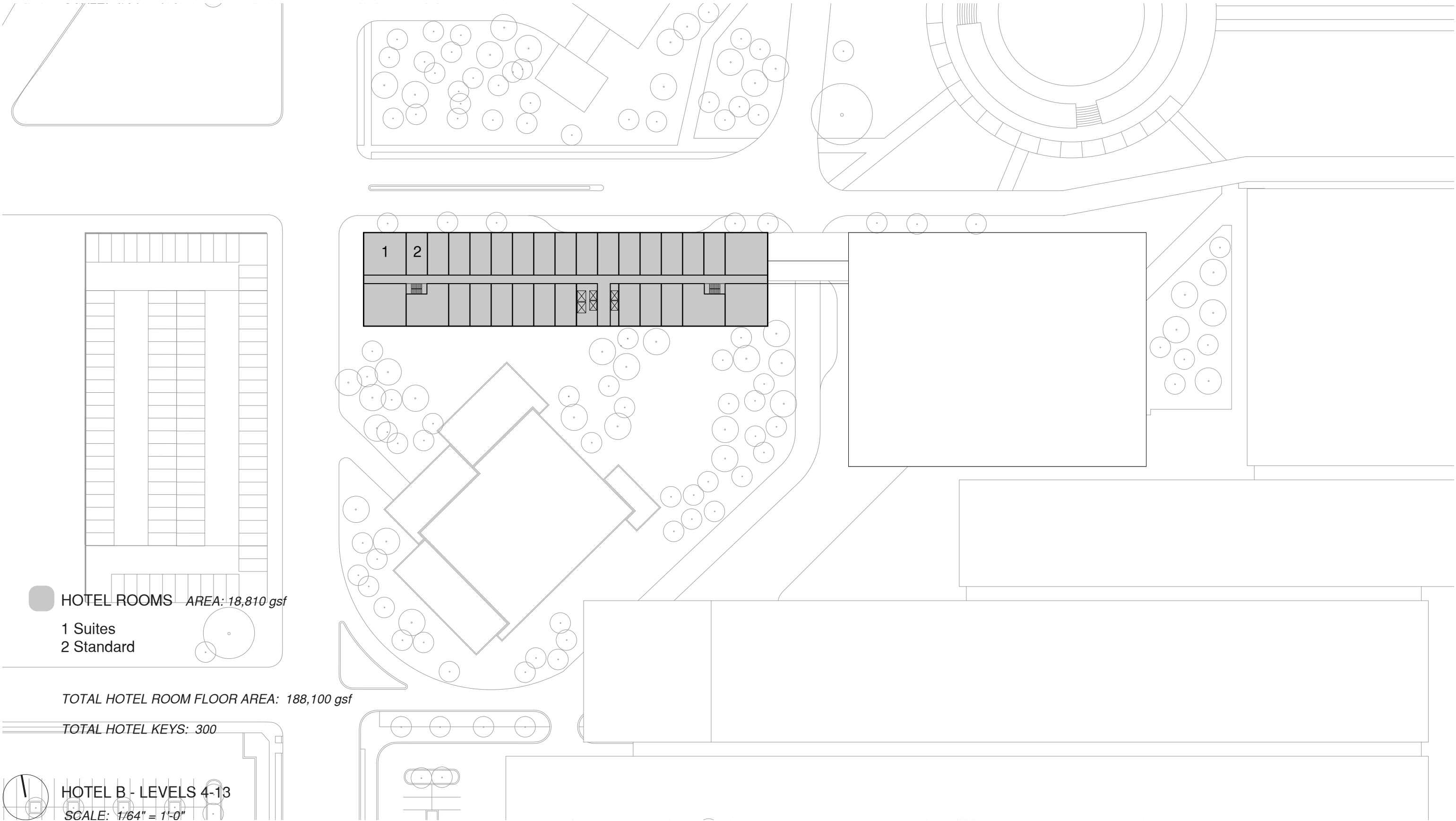

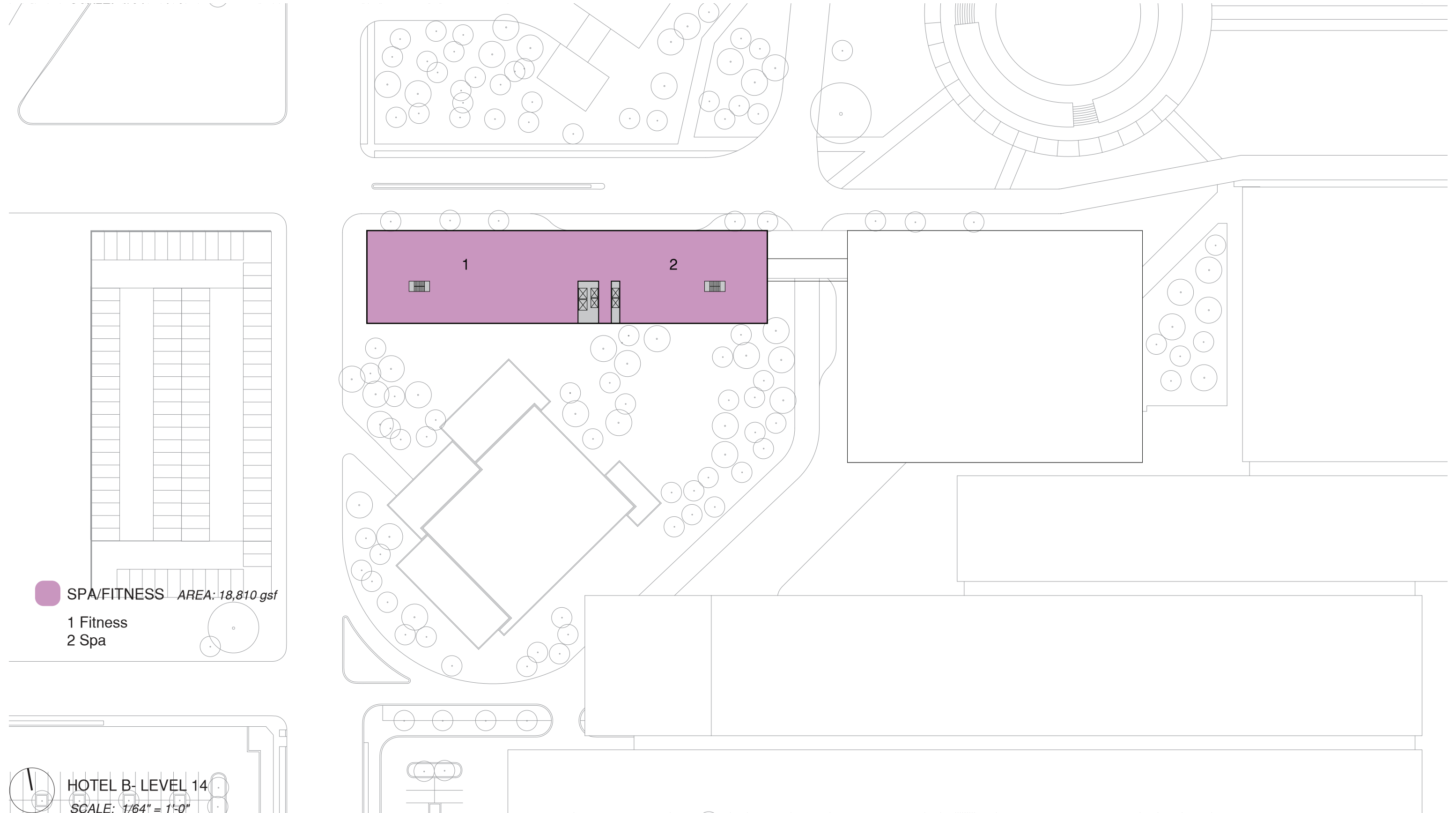

SPA/FITNESS AREA: 18,810 gsf
1 Fitness
2 Spa

HOTEL B- LEVEL 14
SCALE: 1/64" = 1'-0"



ROOF TERRACE AREA: 18,810 gsf
 1 Vegetated Roof
 2 Pool
 3 Roof Bar

HOTEL B- LEVEL 15 ROOF TERRACE
 SCALE: 1/64" = 1'-0"

