

**Zoning Case No. ZN8200, Barajas Family Corporation (District 2).  
Ordinance rezoning a property at or near 2823 South Port Avenue and 2511 San Jacinto Drive from the “CG-2” General Commercial District and the “RS-6” Single-Family 6 District to the “CG-2” General Commercial District; Providing for a penalty not to exceed \$2,000 and publication. (Planning Commission and Staff recommend approval).**

**WHEREAS**, with proper notice to the public, a public hearing was held during a meeting of the Planning Commission during which all interested persons were allowed to appear and be heard;

**WHEREAS**, the Planning Commission has forwarded to the City Council its final report and recommendation regarding the application for an amendment to the City of Corpus Christi’s Unified Development Code (“UDC”) and corresponding UDC Zoning Map;

**WHEREAS**, with proper notice to the public, a public hearing was held during a meeting of the City Council, during which all interested persons were allowed to appear and be heard;

**WHEREAS**, the City Council has determined that this rezoning is not detrimental to the public health, safety, or general welfare of the City of Corpus Christi and its citizens; and

**WHEREAS**, the City Council finds that this rezoning will promote the best and most orderly development of the properties affected thereby, and to be affected thereby, in the City of Corpus Christi.

**NOW, THEREFORE, BE IT ORDAINED BY THE CITY COUNCIL OF THE CITY OF CORPUS CHRISTI, TEXAS:**

**SECTION 1.** The Unified Development Code (“UDC”) and corresponding UDC Zoning Map of the City of Corpus Christi, Texas is amended by changing the zoning on the subject property being Lot 3A & 4, Block 6, High Terrace, as shown in Exhibit A, from:

**the “RS-6” Single-Family 6 District and “CG-2” General Commercial District to the “CG-2” General Commercial District.**

The subject property is located at or near **2823 South Port Avenue and 2511 San Jacinto Drive.** Exhibit A, a map, is attached to and incorporated in this ordinance.

**SECTION 2.** The UDC and corresponding UDC Zoning Map of the City, made effective July 1, 2011 and as amended from time to time, except as changed by this ordinance, both remain in full force and effect including the penalties for violations as made and provided for in Article 10 of the UDC.

**SECTION 3.** To the extent this amendment to the UDC represents a deviation from the City’s Comprehensive Plan, the Comprehensive Plan is amended to conform to the UDC, as it is amended by this ordinance.

**SECTION 4.** All ordinances or parts of ordinances specifically pertaining to the zoning of the subject property that are in conflict with this ordinance are hereby expressly superseded.

**SECTION 5.** A violation of this ordinance, or requirements implemented under this ordinance, constitutes an offense punishable by a fine not to exceed \$2,000.00 for each offense; as provided in Article 1, Section 1.10.1 of the UDC, Article 10 of the UDC, and/or Section 1-6 of the Corpus Christi Code of Ordinances.

**SECTION 6.** Publication shall be made in the official publication of the City of Corpus Christi as required by the City Charter of the City of Corpus Christi.

**SECTION 7.** This ordinance shall become effective upon publication.

Introduced and voted on the \_\_\_\_\_ day of \_\_\_\_\_, 2024.

PASSED and APPROVED on the \_\_\_\_\_ day of \_\_\_\_\_, 2024.

ATTEST:

\_\_\_\_\_  
Paulette Guajardo, Mayor

\_\_\_\_\_  
Rebecca Huerta, City Secretary

# Exhibit A

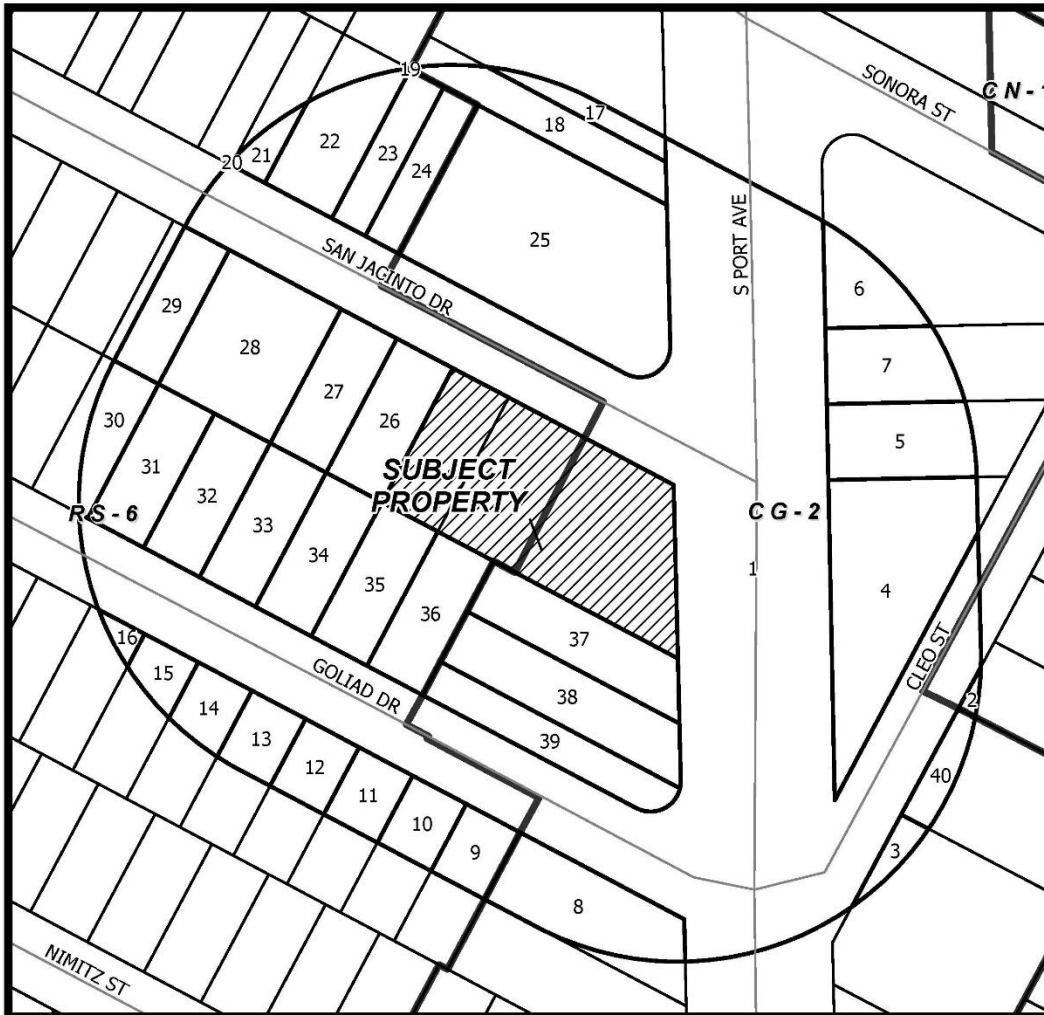

## CASE: 0424-02 Zoning and notice Area

RM-1	Multifamily 1	IL	Light Industrial
RM-2	Multifamily 2	IH	Heavy Industrial
RM-3	Multifamily 3	PUD	Planned Unit Dev. Overlay
CN	Professional Office	RS-10	Single-Family 10
RM-AT	Multifamily AT	RS-6	Single-Family 6
CN-1	Neighborhood Commercial	RS-4.5	Single-Family 4.5
CN-2	Neighborhood Commercial	RS-TF	Two-Family
CR-1	Resort Commercial	RS-15	Single-Family 15
CR-2	Resort Commercial	RE	Residential Estate
CG-1	General Commercial	RS-TH	Townhouse
CG-2	General Commercial	SP	Special Permit
CI	Intensive Commercial	RV	Recreational Vehicle Park
CBD	Downtown Commercial	RMH	Manufactured Home
CR-3	Resort Commercial		
FR	Farm Rural		
H	Historic Overlay		
BP	Business Park		

Subject Property with 200' buffer

Owners in favor

4 Owners within 200' listed on attached ownership table

Owners in opposition

