



# Harbor East Park Partnership Briefing

**Neiman C. Young, PhD**

Assistant City Manager

June 13, 2022

# LOCATION

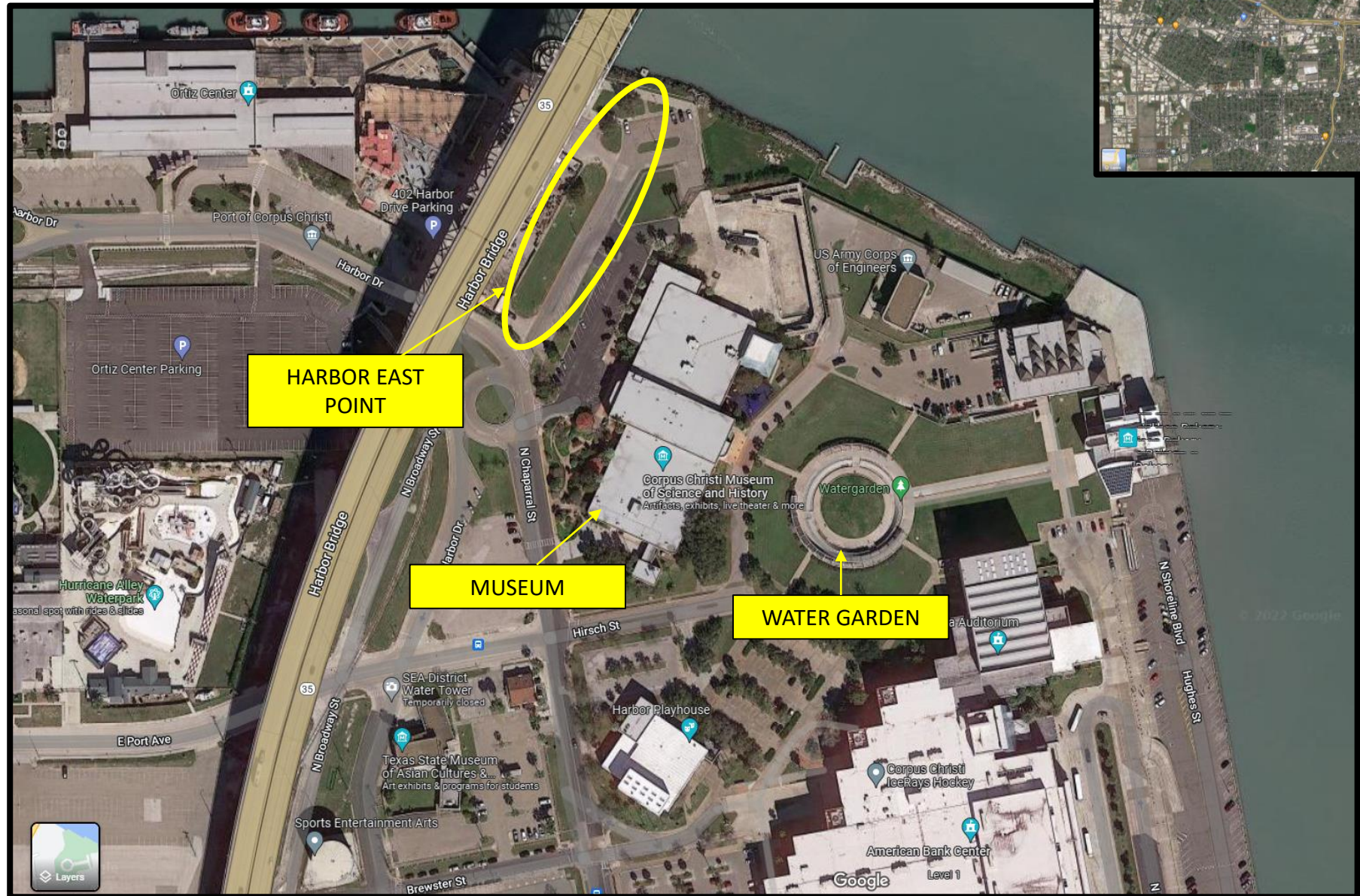



# HARBOR EAST PROJECT (OVERVIEW)

## EXISTING SITE CONDITIONS

- 1 PORT OFFICE
- 2 MUSEUM OF SCIENCE & HISTORY
- 3 RESTROOM & SECURITY
- 4 FOOD TRUCK COURT
- 5 ACCESS FROM SOUTH PARKING LOT
- APPROXIMATE TXDOT BRIDGE RIGHT OF WAY

## HARBOR POINT EAST SITE EXPERIENCES

- 7 GATEWAY
- 8 ART WALK
- 9 DISCOVERY PATH
- 10 LOUNGE LAWN
- 11 BOWSPRIT OVERLOOK
- 12 INTERACTIVE PLAY
- 13 BOARDWALK OVERLOOK
- 14 STORMWATER MANAGEMENT/  
NATIVE LANDSCAPE



# HARBOR EAST PROJECT (GATEWAY SIGN)



- 1 CONCRETE GATEWAY STRUCTURE
- 2 PCCA/HARBOR POINT SIGNAGE
- 3 STAIR ACCESS
- 4 RAMP ACCESS
- 5 RETAINING WALL
- 6 BRICK WALL SEATING
- 7 FRENCH DRAIN

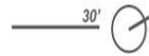

# HARBOR EAST PROJECT (ART WALK)



TEXTURED, LAYERED  
PLANTINGS WITH A FOCUS  
ON ECOLOGICAL VALUE AND  
APPROPRIATE USE

BRICK SEATING WALLS WITH  
ACCENT CAPS

CONCRETE SCORING  
ACCENT

PERMEABLE EDGE FOR  
EVENT MANAGEMENT  
FLEXIBILITY

REINFORCED CONCRETE  
PAVING FOR EVENT  
INSTALLATION

ADDITIONAL ART WALK  
FEATURES:

- LIGHTING
- CONVENIENCE POWER
- WI-FI CONNECTIVITY



# HARBOR EAST PROJECT (LOUNGE & OVERLOOK)

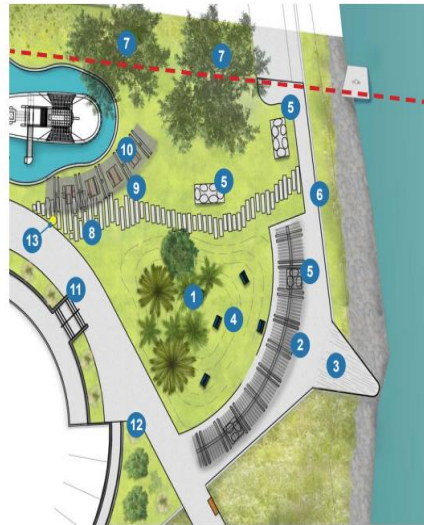

- 1 LOW MOUNDED LAWN (4' MAX)
- 2 SHADED BENCH SWINGS
- 3 BOWSPRIT
- 4 LOUNGE CHAIRS
- 5 CAST STONE LOUNGER
- 6 BULKHEAD PATH (6')
- 7 EXISTING TREE TO REMAIN
- 8 CONCRETE PLANK PATH
- 9 SHADE STRUCTURE
- 10 PICNIC TABLES
- 11 STAIR ACCESS
- 12 RAMP ACCESS
- 13 PERMANENT ART



# HARBOR EAST PROJECT (BOARDWALK OVERLOOK)

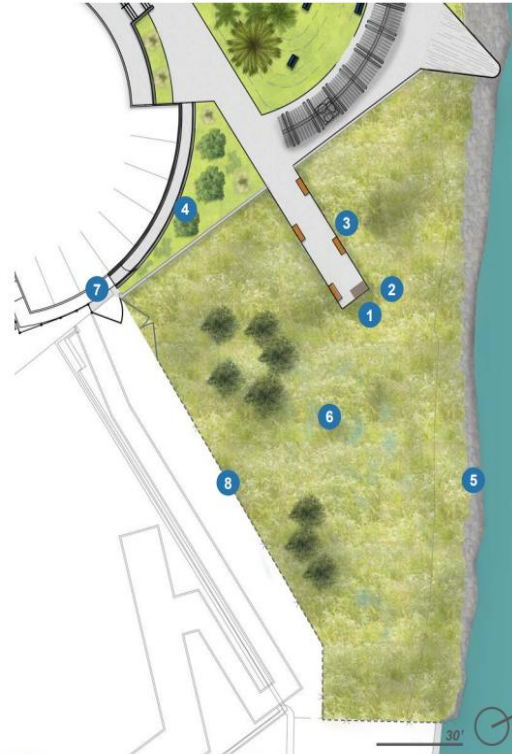

- 1 INTERPRETIVE SIGNAGE
- 2 SPOTTING SCOPE
- 3 BENCHES
- 4 RAMP ACCESS
- 5 STORMWATER OUTFALL
- 6 COASTAL PRAIRIE PLANTING
- 7 MAINTENANCE ACCESS
- 8 EXISTING FENCE TO REMAIN



MRWM  
LANDSCAPE ARCHITECTS

RICHTER  
ARCHITECTS

LJA  
LJA ENGINEERING



# HARBOR EAST PROJECT (BOARDWALK OVERLOOK)





# BULKHEAD PROJECT (CURRENT CONDITIONS)



# BULKHEAD PROJECT (FUTURE CONDITIONS)





# BULKHEAD PROJECT (ADD'L IMPROVEMENTS)



# BULKHEAD PROJECT (ADD'L IMPROVEMENTS)

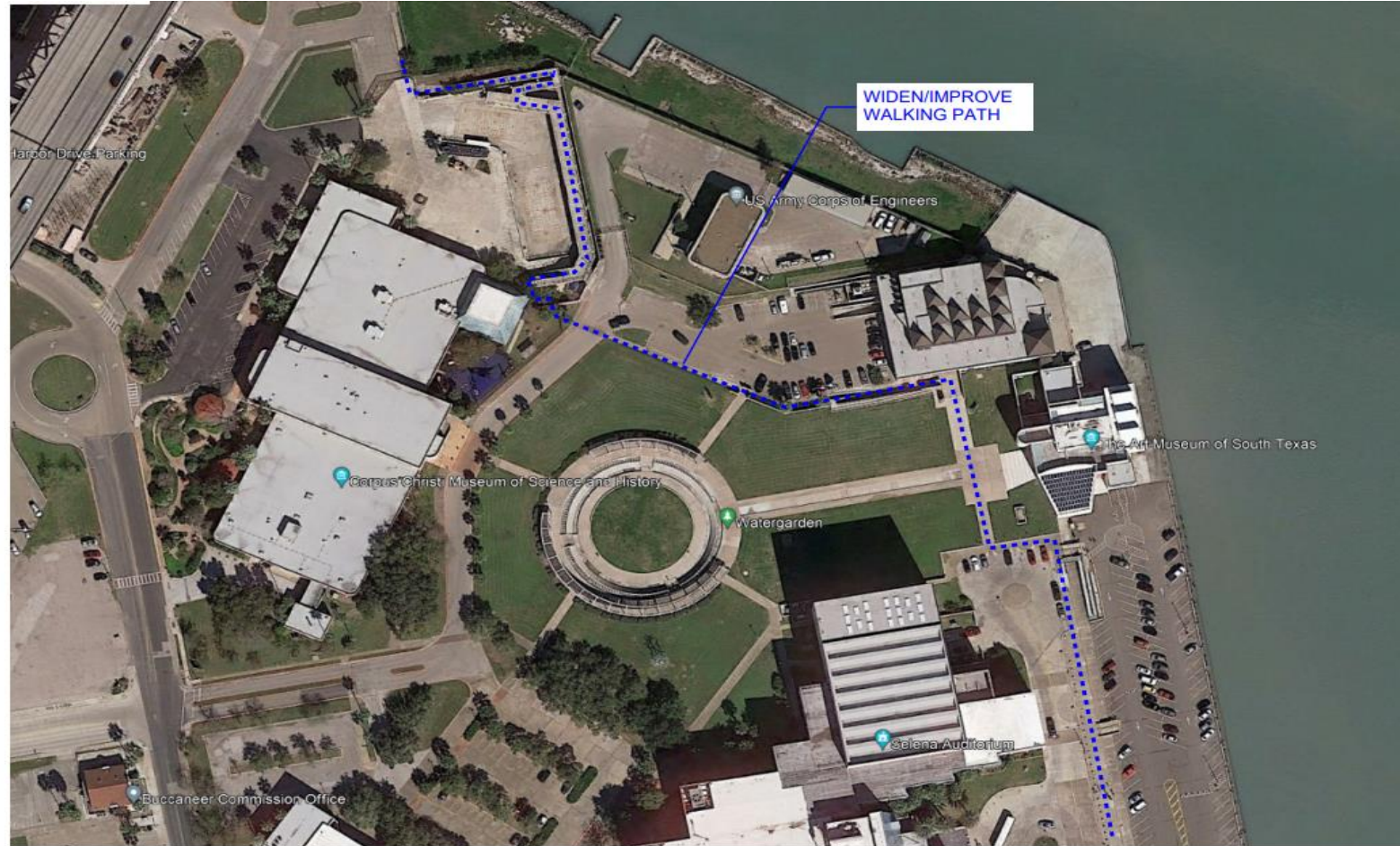



# BULKHEAD PROJECT (ADD'L IMPROVEMENTS)



QUESTIONS/COMMENTS