

STATE OF TEXAS
COUNTY OF NUECES

WE, ROBERT EDWARD TREVINO AND MARY MAGDALENA TREVINO, HEREBY CERTIFIES THAT IT IS THE OWNER OF THE LANDS EMBRACED WITHIN THE BOUNDARIES OF THE FORGOING PLAT; THAT IT HAS HAD SAID LAND SURVEYED AND SUBDIVIDED AS SHOWN; THAT STREETS AS SHOWN ARE DEDICATED TO THE PUBLIC FOREVER; THAT ALL EASEMENTS ARE DEDICATED TO THE PUBLIC FOR THE INSTALLATION, OPERATION, AND USE OF PUBLIC UTILITIES; THAT THIS MAP WAS MADE FOR THE PURPOSE OF DESCRIPTION AND DEDICATION.

THIS THE_____ DAY OF _____ 2023.

ROBERT EDWARD TREVINO, OWNER

MARY MAGDALENA TREVINO, OWNER

STATE OF TEXAS
COUNTY OF NUECES

THIS INSTRUMENT WAS ACKNOWLEDGED BEFORE ME BY
ROBERT EDWARD TREVINO AND MARY MAGDALENA
TREVINO

THIS THE_____ DAY OF _____ 2023.

NOTARY PUBLIC IN AND FOR THE STATE OF TEXAS

STATE OF TEXAS
COUNTY OF NUECES

THIS FINAL PLAT OF THE HEREIN DESCRIBED PROPERTY WAS
APPROVED ON BEHALF OF THE CITY OF CORPUS CHRISTI, TEXAS
PLANNING COMMISSION.

THIS THE_____ DAY OF _____ 2023.

KAMRAN ZARGHOUN
CHAIRMAN

AL RAYMOND III, AIA
SECRETARY

STATE OF TEXAS
COUNTY OF NUECES

THIS FINAL PLAT OF THE HEREIN DESCRIBED PROPERTY WAS APPROVED
BY THE DEVELOPMENT SERVICES ENGINEER OF THE CITY OF CORPUS
CHRISTI, TEXAS.

THIS THE_____ DAY OF _____ 2023.

BRIA WHITMIRE, P.E. CFM, CPM
DEVELOPMENT SERVICES ENGINEER

STATE OF TEXAS
COUNTY OF NUECES

I, KARA SANDS, CLERK OF THE COUNTY COURT IN AND FOR NUECES COUNTY,
TEXAS, DO HEREBY CERTIFY THAT THE FOREGOING INSTRUMENT DATED THE _____
DAY OF _____, 2023, WITH ITS CERTIFICATE OF AUTHENTICATION WAS
FILED FOR RECORD IN MY OFFICE THE _____ DAY OF _____, 2023, AT
_____ O'CLOCK _____M. AND DULY RECORDED THE _____ DAY OF
_____, 2023, AT _____ O'CLOCK _____M., IN VOLUME _____, PAGE
_____, MAP RECORDS NUECES COUNTY, TEXAS.

KARA SANDS, COUNTY CLERK
NUECES COUNTY, TEXAS

AT _____ O'CLOCK _____M.
_____, 2023

BY: _____ DEPUTY

PLAT OF: McNORTON SUBDIVISION UNIT 2 BLOCK 4, LOTS 12A AND 12B

BEING A RE-PLAT OF LOT 12, BLOCK 4 OF THE McNORTON SUBDIVISON UNIT 2,
RECORDED IN VOLUME 11, PAGE 31 OF THE MAP RECORDS OF NUECES COUNTY,
TEXAS.

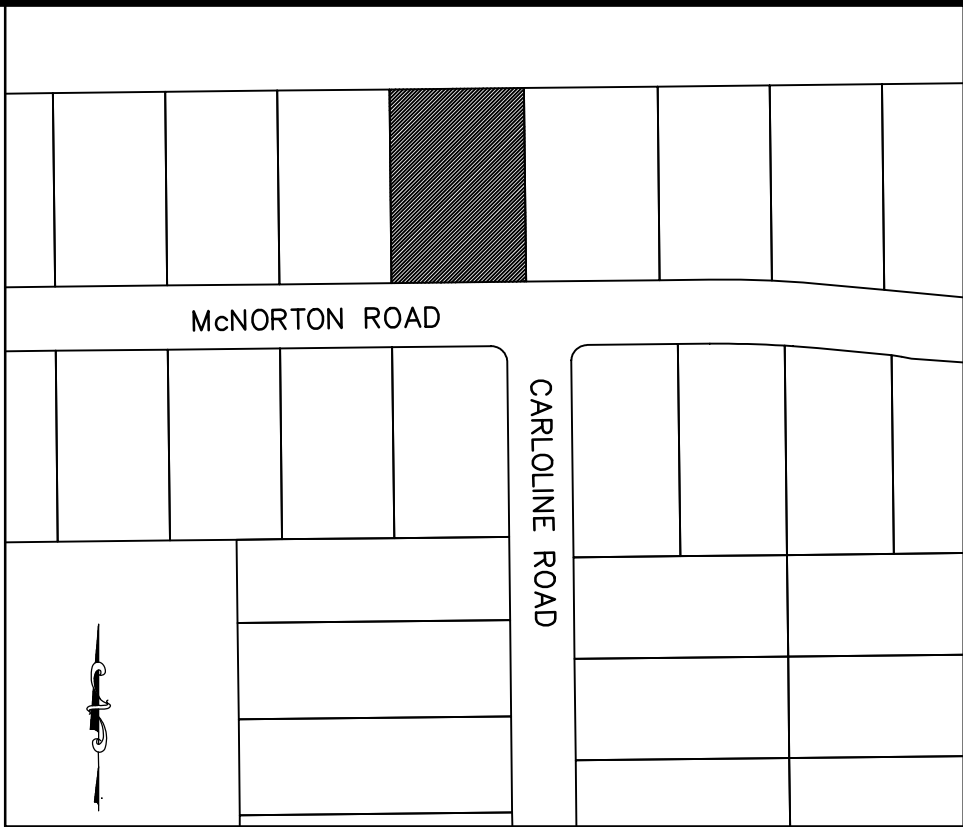

LOCATION MAP
NOT TO SCALE

GENERAL NOTES:

- 1) THE TOTAL PLATTED AREA CONTAINS 0.52 ACRES OF LAND.
- 2) A 5/8" DIAMETER STEEL REBAR WAS SET AT EVERY CORNER, EXCEPT OTHERWISE SPECIFIED.
- 3) PER FLOOD INSURANCE RATE MAP, MAP INDEX, COMMUNITY-PANEL NUMBER 48355C0285G, MAP REVISED 10/13/2022, THE SUBJECT PROPERTY IS LOCATED IN ZONE X AREAS OF MINIMAL FLOOD;
- 4) ALL BEARINGS REFER TO THE TEXAS STATE PLANE COORDINATE SYSTEM OF 1983, TEXAS SOUTH ZONE.
- 5) THE RECEIVING WATER FROM THE STORM WATER RUNOFF FROM THIS PROPERTY IS THE CORPUS CHRISTI INNER HARBOR. THE TCEQ HAS CLASSIFIED THE AQUATIC LIFE USE FOR THE CORPUS CHRISTI INNER HARBOR AS "INTERMEDIATE".
- 6) PROPOSED DRIVEWAY ACCESS TO A PUBLIC CITY STREET SHALL CONFORM TO ACCESS MANAGEMENT STANDARDS OUTLINED IN ARTICLE 7 OF THE UDC (UDC 7.1.7)

STATE OF TEXAS
COUNTY OF NUECES

I, JARREL L. MOORE, A REGISTERED PROFESSIONAL LAND SURVEYOR HEREBY CERTIFY THAT THE FOREGOING PLAT WAS PREPARED FROM A SURVEY MADE ON THE GROUND UNDER MY DIRECTION AND IS TRUE AND CORRECT; THAT I HAVE BEEN ENGAGED UNDER CONTRACT TO SET ALL LOT AND BLOCK CORNERS AND COMPLETE SUCH OPERATIONS WITHOUT DELAY.

THIS THE _____ DAY OF _____ 2023.

JARREL L. MOORE
REGISTERED PROFESSIONAL LAND SURVEYOR
LICENSE NO. 4854

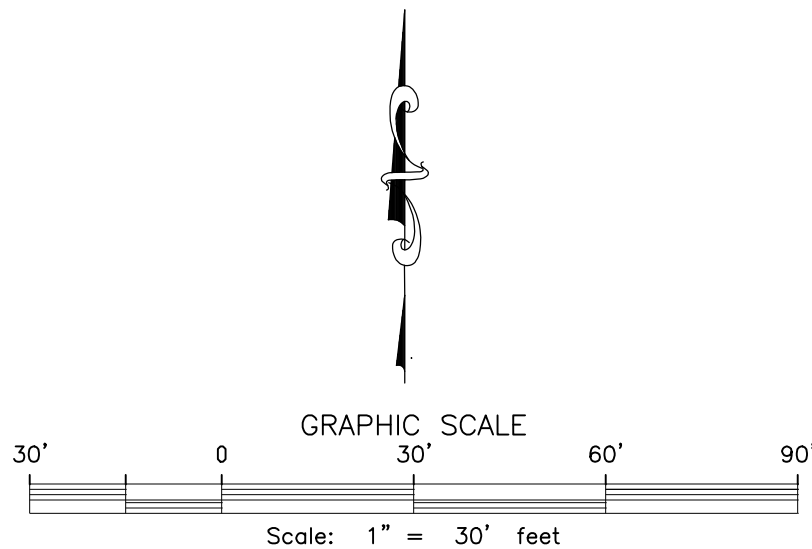

TEXAS GEO TECH
LAND SURVEYING, INC

5525 S. STAPLES ST. SUITE B2
Corpus Christi, TX 78411
(361) 993-0808 Fax (361) 993-2955
JOB # 230411
MAY 08, 2023