

Ordinance amending the Unified Development Code (“UDC”), upon application by the City of Corpus Christi (“Owner”), by changing the UDC Zoning Map in reference to Lot 5A, Block 4, Brennan Addition, from the “IH” Heavy Industrial District to the “RS-4.5” Single-Family 4.5 District; amending the Comprehensive Plan to account for any deviations; and providing for a repealer clause and publication.

WHEREAS, the Planning Commission has forwarded to the City Council its final report and recommendation regarding the application of the City of Corpus Christi (“Owner”), for an amendment to the City of Corpus Christi’s Unified Development Code (“UDC”) and corresponding UDC Zoning Map;

WHEREAS, with proper notice to the public, public hearings were held on Wednesday, January 13, 2016, during a meeting of the Planning Commission when the Planning Commission recommended approval of the change of zoning from the “IH” Heavy Industrial District to the “RS-4.5” Single-Family 4.5 District, and on Tuesday, February 9, 2016, during a meeting of the City Council, during which all interested persons were allowed to appear and be heard; and

WHEREAS, the City Council has determined that this amendment would best serve the public health, necessity, convenience and general welfare of the City of Corpus Christi and its citizens.

BE IT ORDAINED BY THE CITY COUNCIL OF THE CITY OF CORPUS CHRISTI, TEXAS:

SECTION 1. Upon application made by the City of Corpus Christi (“Owner”), the Unified Development Code (“UDC”) of the City of Corpus Christi, Texas (“City”), is amended by changing the zoning on Lot 5A, Block 4, Brennan Addition, located on the north side of Lipan Street between Coke Street and 19th Street (the “Property”), from the “IH” Heavy Industrial District to the “RS-4.5” Single-Family 4.5 District; (Zoning Map No. 046044), as shown in Exhibit “A”. Exhibit A, which is a map of the Property, is attached to and incorporated in this ordinance by reference as if fully set out herein in its entirety.

SECTION 2. The official UDC Zoning Map of the City is amended to reflect changes made to the UDC by Section 1 of this ordinance.

SECTION 3. The UDC and corresponding UDC Zoning Map of the City, made effective July 1, 2011, and as amended from time to time, except as changed by this ordinance, both remain in full force and effect.

SECTION 4. The City’s Future Land Use Map, an element of the Comprehensive Plan, is amended to designate the Property for low density residential land uses.

SECTION 5. All ordinances or parts of ordinances specifically pertaining to the zoning of the Property and that are in conflict with this ordinance are hereby expressly repealed.

SECTION 6. Publication shall be made in the City's official publication as required by the City's Charter.

The foregoing ordinance was read for the first time and passed to its second reading on this the _____ day of _____, 20____, by the following vote:

Nelda Martinez	_____	Brian Rosas	_____
Rudy Garza	_____	Lucy Rubio	_____
Chad Magill	_____	Mark Scott	_____
Colleen McIntyre	_____	Carolyn Vaughn	_____
Lillian Riojas	_____		

The foregoing ordinance was read for the second time and passed finally on this the _____ day of _____, 20____, by the following vote:

Nelda Martinez	_____	Brian Rosas	_____
Rudy Garza	_____	Lucy Rubio	_____
Chad Magill	_____	Mark Scott	_____
Colleen McIntyre	_____	Carolyn Vaughn	_____
Lillian Riojas	_____		

PASSED AND APPROVED this the _____ day of _____, 20_____.

ATTEST:

Rebecca Huerta
City Secretary

Nelda Martinez
Mayor

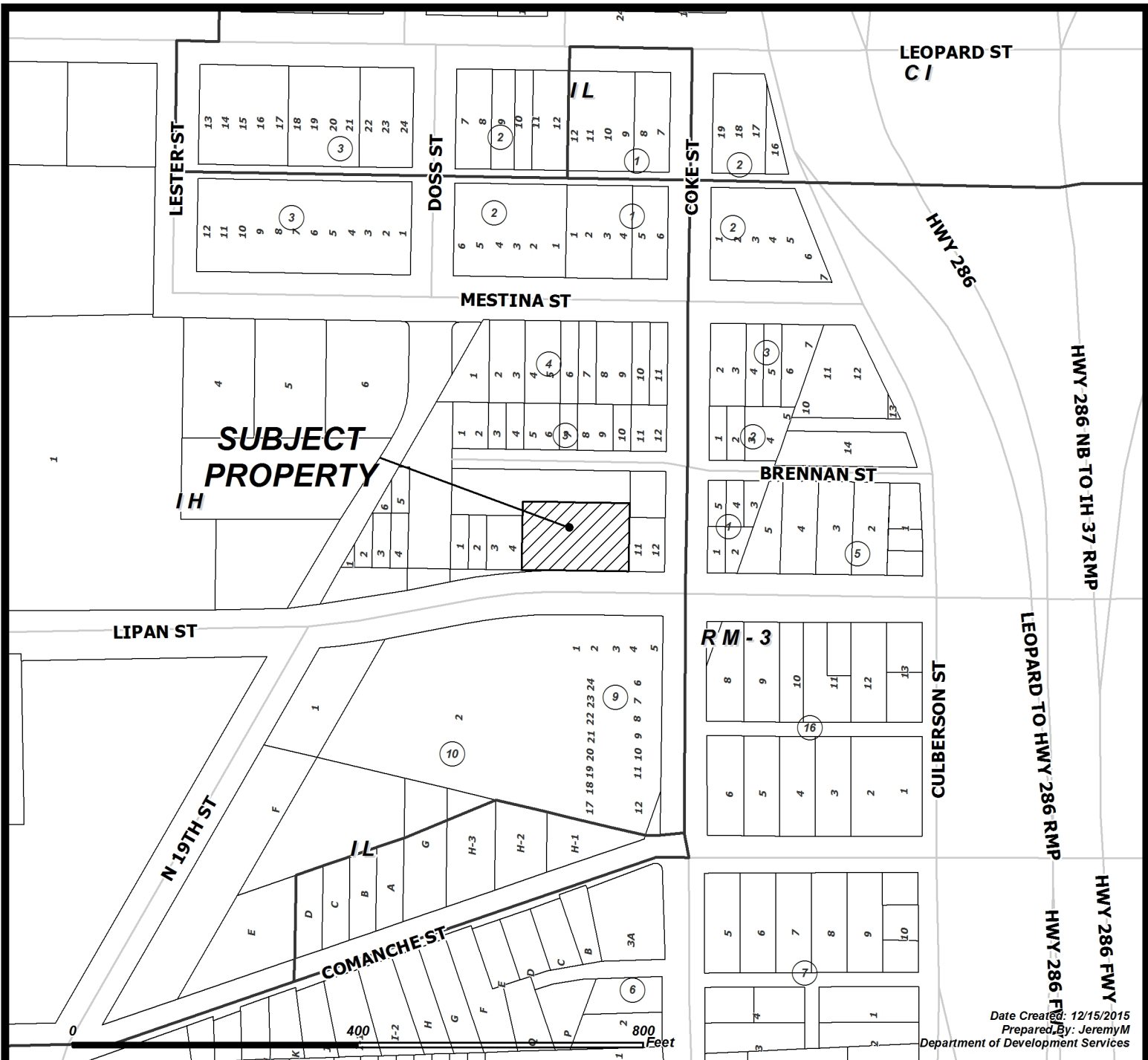

CASE: 0116-02

SUBJECT PROPERTY WITH ZONING

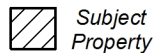

RM-1	Multifamily 1	IL	Light Industrial
RM-2	Multifamily 2	IH	Heavy Industrial
RM-3	Multifamily 3	PUD	Planned Unit Dev. Overlay
ON	Professional Office	RS-10	Single-Family 10
RM-AT	Multifamily AT	RS-6	Single-Family 6
CN-1	Neighborhood Commercial	RS-4.5	Single-Family 4.5
CN-2	Neighborhood Commercial	RS-TF	Two-Family
CR-1	Resort Commercial	RS-15	Single-Family 15
CR-2	Resort Commercial	RE	Residential Estate
CG-1	General Commercial	RS-TH	Townhouse
CG-2	General Commercial	SP	Special Permit
CI	Intensive Commercial	RV	Recreational Vehicle Park
CBD	Downtown Commercial	RMH	Manufactured Home
CR-3	Resort Commercial		
FR	Farm Rural		
H	Historic Overlay		
BP	Business Park		

