



Zoning Case #0217-01

Carlos and Rhonda Garcia

From: “FR” Farm Rural District

To: “RE” Residential Estate District

Planning Commission Presentation
February 9, 2017



Aerial Overview





Subject Property





Existing Land Use

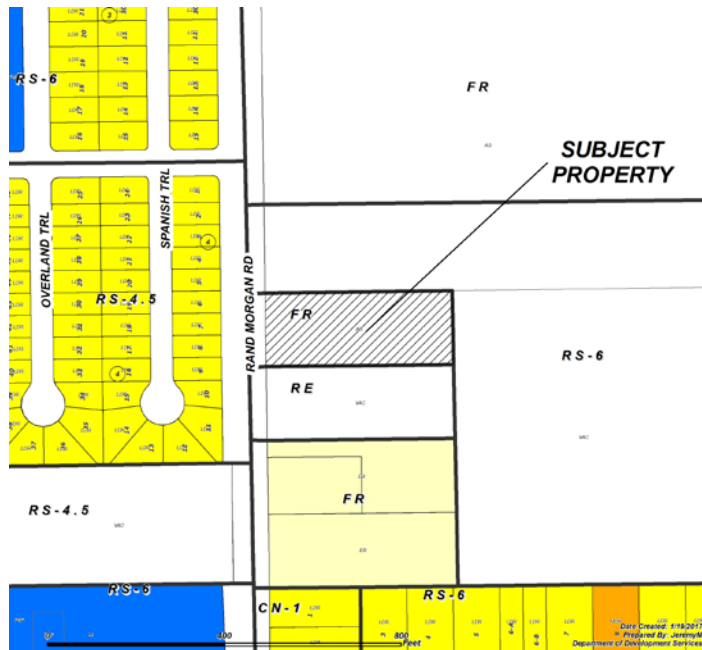

Vacant



Low Density
Residential



Medium Density
Residential



Multi-family
Residential



Estate
Residential



Public/Semi-Public

Future Land Use

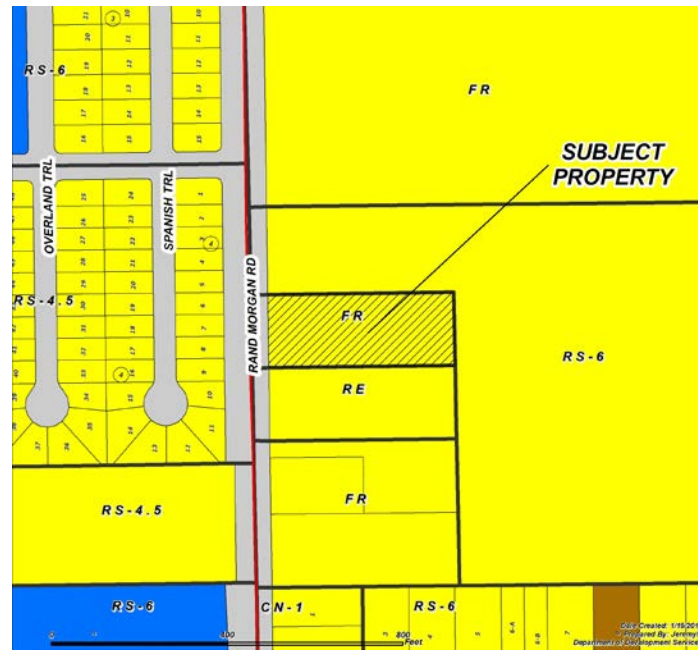



Subject Property, East on Rand Morgan Road (FM 2292)





Rand Morgan Road (FM 2292), South of Subject Property





Rand Morgan Road (FM 2292), West of Subject Property





Rand Morgan Road (FM 2292), North of Subject Property





Public Notification

13 Notices mailed inside 200' buffer
2 Notices mailed outside 200' buffer

Notification Area

Opposed: 0 (0.00%)



In Favor: 0

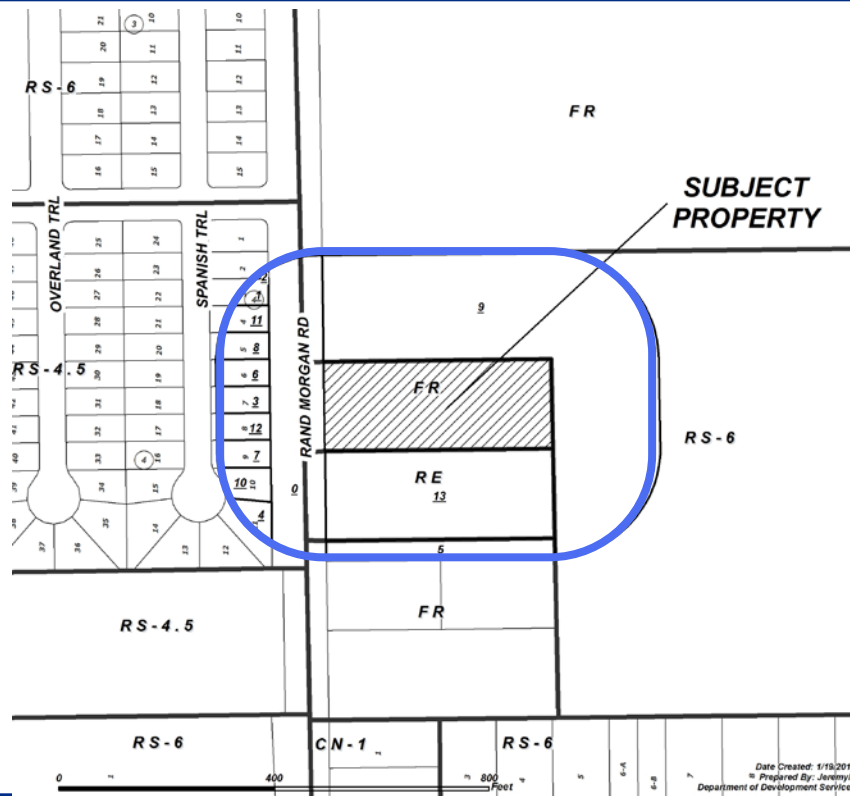



Staff Recommendation

**Approval of the
“RE” Residential Estate District.**