



Zoning Case #0317-01 Estate of W.R. Durrill

From: “IL” Light Industrial District

To: “CG-2” General Commercial District

Planning Commission Presentation
March 8, 2017



Aerial Overview





Subject Property





Existing Land Use

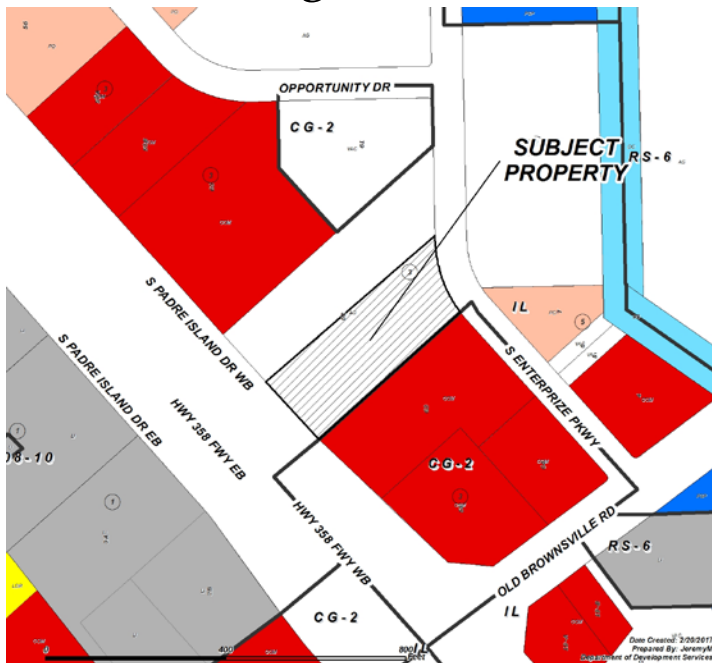

Vacant

Low Density Residential

Light Industrial

Commercial

Professional Office

Public/Semi-Public

Future Land Use

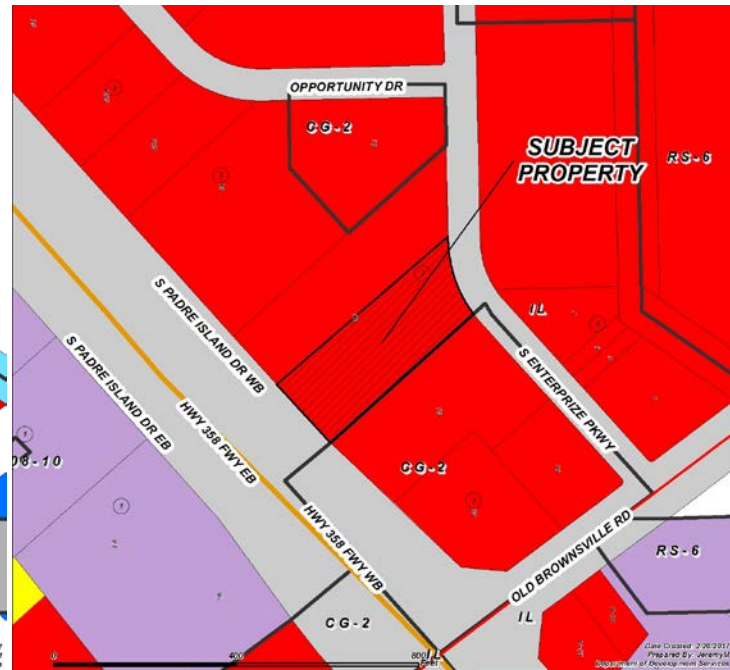



Subject Property, East on South Padre Island Drive (SH 358)





South Padre Island Drive (SH 358), South of Subject Property





South Padre Island Drive (SH 358), West of Subject Property





South Padre Island Drive (SH 358), North of Subject Property





South Enterprize Parkway, North of Subject Property





Public Notification

7 Notices mailed inside 200' buffer
5 Notices mailed outside 200' buffer

Notification Area

Opposed: 0 (0.00%)



In Favor: 0

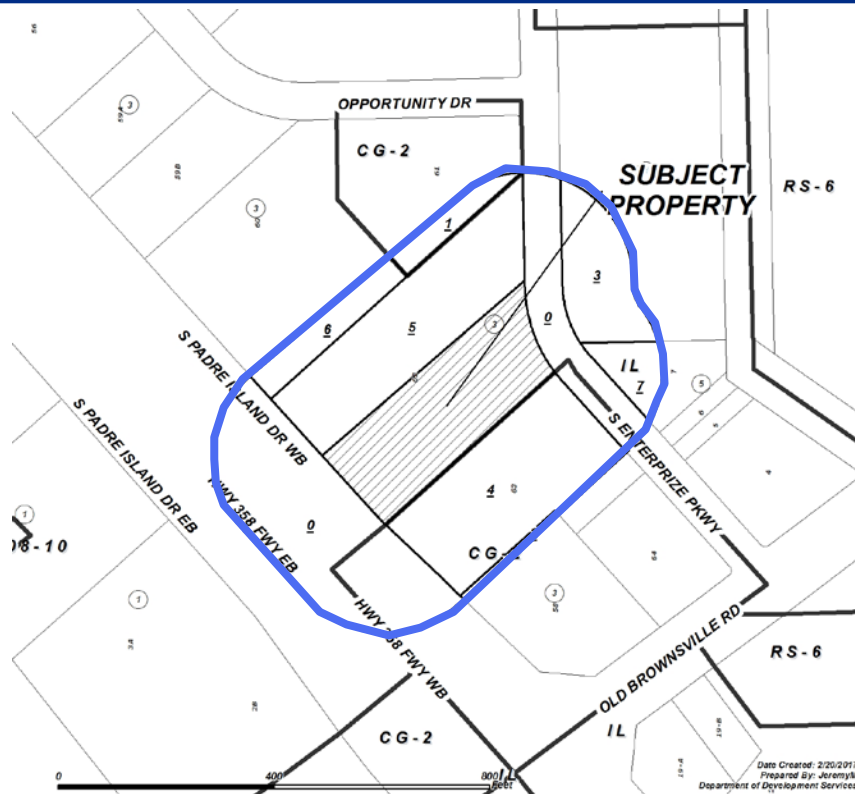



Staff Recommendation

**Approval of the
“CG-2” General Commercial District.**