

Ordinance amending the Unified Development Code (“UDC”), upon application by Magellan Terminal Holdings, LP. (“Owner”), by changing the UDC Zoning Map in reference to Webb Tract Port View 101.58 acres, from the “CG-1” General Commercial District to the “IH” Heavy Industrial District; amending the Comprehensive Plan to account for any deviations; and providing for a repealer clause and publication.

WHEREAS, the Planning Commission has forwarded to the City Council its final report and recommendation regarding the application of Magellan Terminal Holdings, LP. (“Owner”), for an amendment to the City of Corpus Christi’s Unified Development Code (“UDC”) and corresponding UDC Zoning Map;

WHEREAS, with proper notice to the public, a public hearing was held on Wednesday, May 17, 2017, during a meeting of the Planning Commission. The Planning Commission recommended approval of the change of zoning from the “CG-1” General Commercial District to the “IH” Heavy Industrial District, and on Tuesday, June 13, 2017, during a meeting of the City Council, during which all interested persons were allowed to appear and be heard; and

WHEREAS, the City Council has determined that this amendment would best serve the public health, necessity, convenience and general welfare of the City of Corpus Christi and its citizens.

BE IT ORDAINED BY THE CITY COUNCIL OF THE CITY OF CORPUS CHRISTI, TEXAS:

SECTION 1. Upon application made by Magellan Terminal Holdings, LP. (“Owner”), the Unified Development Code (“UDC”) of the City of Corpus Christi, Texas (“City”), is amended by changing the zoning on Webb Tract Port View 101.58 acres, located along the west side of Poth Lane, south of Tribble Lane, and north of Interstate 37 (the “Property”), from the “CG-1” General Commercial District to the “IH” Heavy Industrial District (Zoning Map No. 049045), as shown in Exhibit A, which is a map of the property, is attached to and incorporated in this ordinance by reference as if fully set out herein in its entirety.

SECTION 2. The official UDC Zoning Map of the City is amended to reflect changes made to the UDC by Section 1 of this ordinance.

SECTION 3. The UDC and corresponding UDC Zoning Map of the City, made effective July 1, 2011, and as amended from time to time, except as changed by this ordinance, both remain in full force and effect.

SECTION 4. To the extent this amendment to the UDC represents a deviation from the City’s Comprehensive Plan, the Comprehensive Plan is amended to conform to the UDC, as it is amended by this ordinance.

SECTION 5. All ordinances or parts of ordinances specifically pertaining to the zoning of the Property and that are in conflict with this ordinance are hereby expressly repealed.

SECTION 6. Publication shall be made in the City's official publication as required by the City's Charter.

That the foregoing ordinance was read for the first time and passed to its second reading on this the _____ day of _____, 2017, by the following vote:

Joe McComb	_____	Ben Molina	_____
Rudy Garza	_____	Lucy Rubio	_____
Paulette Guajardo	_____	Greg Smith	_____
Michael Hunter	_____	Carolyn Vaughn	_____
Council Member	_____		

That the foregoing ordinance was read for the second time and passed finally on this the _____ day of _____, 2017, by the following vote:

Joe McComb	_____	Ben Molina	_____
Rudy Garza	_____	Lucy Rubio	_____
Paulette Guajardo	_____	Greg Smith	_____
Michael Hunter	_____	Carolyn Vaughn	_____
Council Member	_____		

PASSED AND APPROVED on this the _____ day of _____, 2017.

ATTEST:

Rebecca Huerta
City Secretary

Joe McComb
Mayor

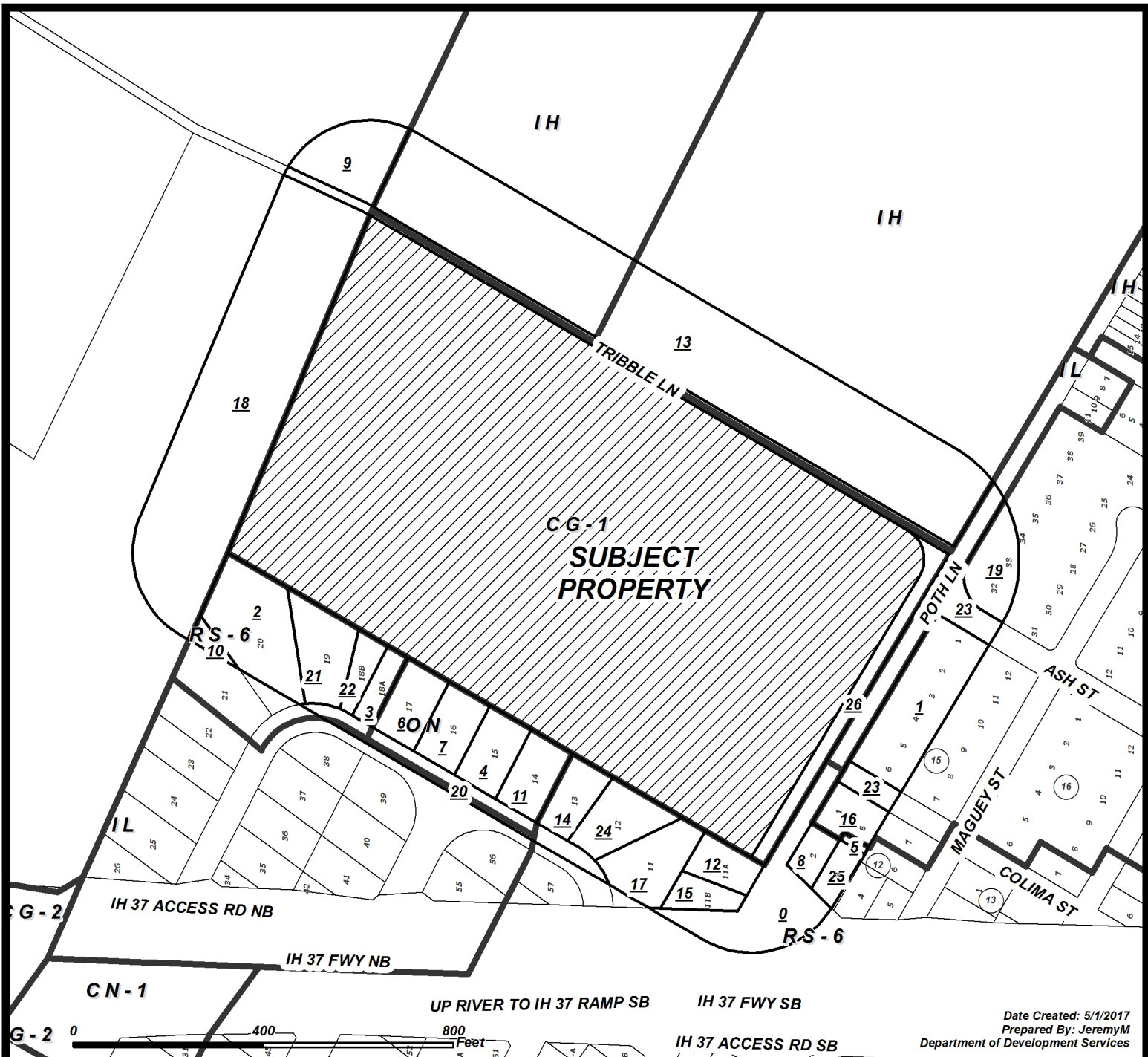

Date Created: 5/1/2017

Prepared By: Jeremy M

Department of Development Services

CASE: 0517-03 ZONING & NOTICE AREA

RM-1	Multifamily 1	IL	Light Industrial
RM-2	Multifamily 2	IH	Heavy Industrial
RM-3	Multifamily 3	PUD	Planned Unit Dev. Overlay
ON	Professional Office	RS-10	Single-Family 10
RM-AT	Multifamily AT	RS-6	Single-Family 6
CN-1	Neighborhood Commercial	RS-4.5	Single-Family 4.5
CN-2	Neighborhood Commercial	RS-TF	Two-Family
CR-1	Resort Commercial	RS-15	Single-Family 15
CR-2	Resort Commercial	RE	Residential Estate
CG-1	General Commercial	RS-TH	Townhouse
CG-2	General Commercial	SP	Special Permit
CI	Intensive Commercial	RV	Recreational Vehicle Park
CBD	Downtown Commercial	RMH	Manufactured Home
CR-3	Resort Commercial		
FR	Farm Rural		
H	Historic Overlay		
BP	Business Park		

Subject Property with 200' buffer

Owners in favor

Owners within 200' listed on attached ownership table

Owners in opposition

