

**Case No. 0118-01: Ordinance rezoning property at 12750 Hearn Road from "RS-6" to "IH" and amending the Comprehensive Plan.**

**WHEREAS**, the Planning Commission has forwarded to the City Council its final report and recommendation regarding the application of AEP Texas, Inc. ("Owner"), for an amendment to the City of Corpus Christi's Unified Development Code ("UDC") and corresponding UDC Zoning Map;

**WHEREAS**, with proper notice to the public, a public hearing was held on Wednesday, January 24, 2018, during a meeting of the Planning Commission. The Planning Commission recommended approval of the change of zoning from the "RS-6" Single-Family 6 District to the "IH" Heavy Industrial District and on Tuesday, February 27, 2018, during a meeting of the City Council, during which all interested persons were allowed to appear and be heard; and

**WHEREAS**, the City Council has determined that this amendment would best serve the public health, necessity, convenience and general welfare of the City of Corpus Christi and its citizens.

**BE IT ORDAINED BY THE CITY COUNCIL OF THE CITY OF CORPUS CHRISTI, TEXAS:**

**SECTION 1.** Upon application made by AEP Texas, Inc. ("Owner"), the Unified Development Code ("UDC") of the City of Corpus Christi, Texas ("City"), is amended by changing the zoning on a property described as Hearn Addition Annex, Lot 1, located on the north side of Hearn Road, west of Callicoatte Road, and east of Leopard Street (the "Property"), from the "RS-6" Single-Family 6 District to the "IH" Heavy Industrial District (Zoning Map No. 065050), as shown in Exhibit "A". Exhibit A, which is a map of the property attached to and incorporated in this ordinance by reference as if fully set out herein in their entirety.

**SECTION 2.** The official UDC Zoning Map of the City is amended to reflect changes made to the UDC by Section 1 of this ordinance.

**SECTION 3.** The UDC and corresponding UDC Zoning Map of the City, made effective July 1, 2011, and as amended from time to time, except as changed by this ordinance, both remain in full force and effect.

**SECTION 4.** To the extent this amendment to the UDC represents a deviation from the City's Comprehensive Plan, the Comprehensive Plan is amended to conform to the UDC, as it is amended by this ordinance.

**SECTION 5.** All ordinances or parts of ordinances specifically pertaining to the zoning of the Property and that are in conflict with this ordinance are hereby expressly repealed.

**SECTION 6.** Publication shall be made in the City's official publication as required by the City's Charter.

That the foregoing ordinance was read for the first time and passed to its second reading on this the \_\_\_\_\_ day of \_\_\_\_\_, 2018, by the following vote:

Joe McComb	_____	Ben Molina	_____
Rudy Garza	_____	Lucy Rubio	_____
Paulette Guajardo	_____	Greg Smith	_____
Michael Hunter	_____	Carolyn Vaughn	_____
Debbie Lindsey-Opel	_____		

That the foregoing ordinance was read for the second time and passed finally on this the \_\_\_\_\_ day of \_\_\_\_\_, 2018, by the following vote:

Joe McComb	_____	Ben Molina	_____
Rudy Garza	_____	Lucy Rubio	_____
Paulette Guajardo	_____	Greg Smith	_____
Michael Hunter	_____	Carolyn Vaughn	_____
Debbie Lindsey-Opel	_____		

PASSED AND APPROVED on this the \_\_\_\_\_ day of \_\_\_\_\_, 2018.

ATTEST:

\_\_\_\_\_  
Rebecca Huerta  
City Secretary

\_\_\_\_\_  
Joe McComb  
Mayor

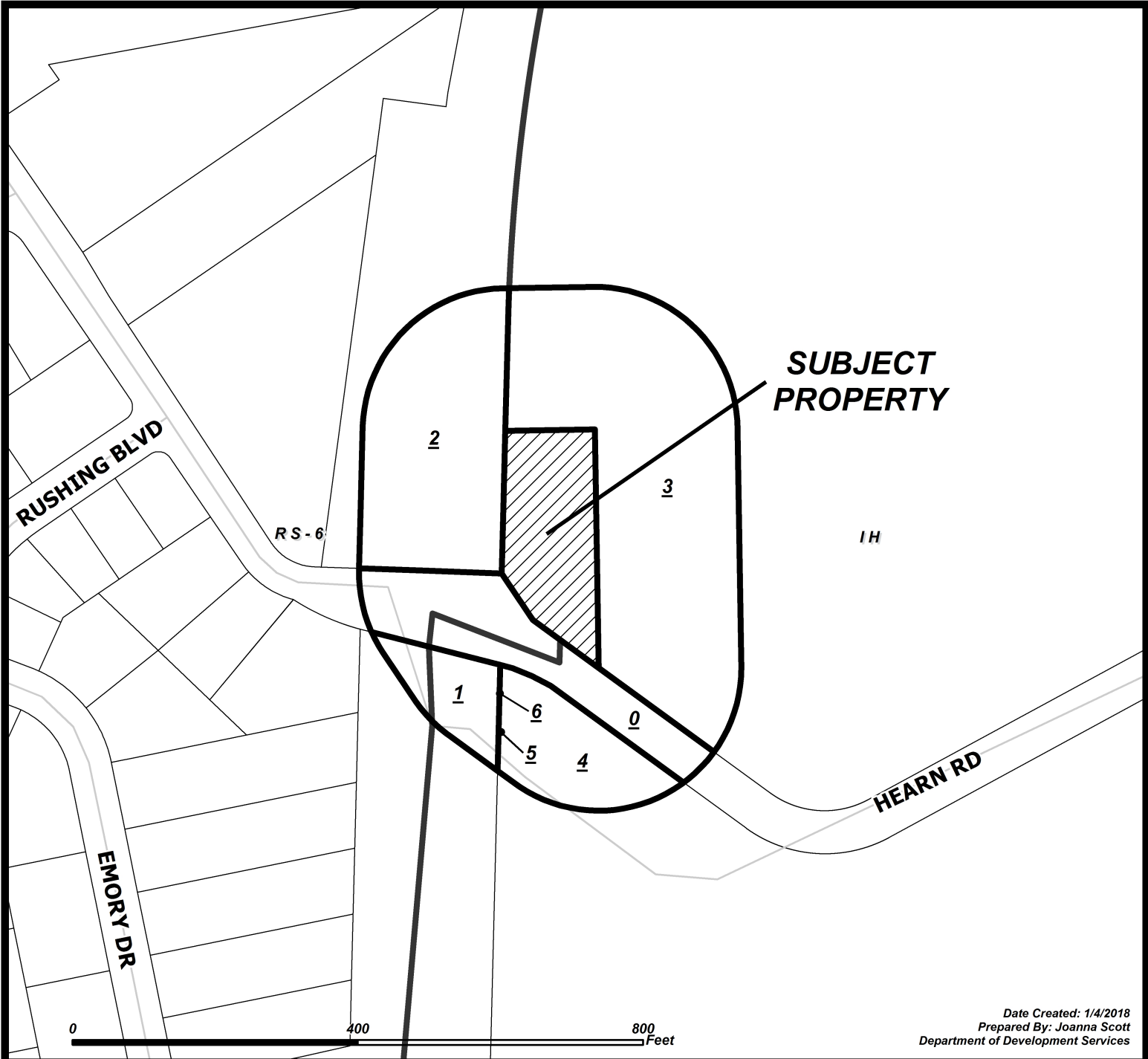

Date Created: 1/4/2018  
Prepared By: Joanna Scott  
Department of Development Services

## CASE: 0118-01 ZONING & NOTICE AREA

RM-1 Multifamily 1	IL Light Industrial
RM-2 Multifamily 2	IH Heavy Industrial
RM-3 Multifamily 3	PUD Planned Unit Dev. Overlay
ON Professional Office	RS-10 Single-Family 10
RM-AT Multifamily AT	RS-6 Single-Family 6
CN-1 Neighborhood Commercial	RS-4.5 Single-Family 4.5
CN-2 Neighborhood Commercial	RS-TF Two-Family
CR-1 Resort Commercial	RS-15 Single-Family 15
CR-2 Resort Commercial	RE Residential Estate
CG-1 General Commercial	RS-TH Townhouse
CG-2 General Commercial	SP Special Permit
CI Intensive Commercial	RV Recreational Vehicle Park
CBD Downtown Commercial	RMH Manufactured Home
CR-3 Resort Commercial	
FR Farm Rural	
H Historic Overlay	
BP Business Park	

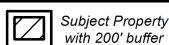

Subject Property  
with 200' buffer



Owners  
in favor

4

Owners within 200' listed on  
attached ownership table

X Owners  
in opposition

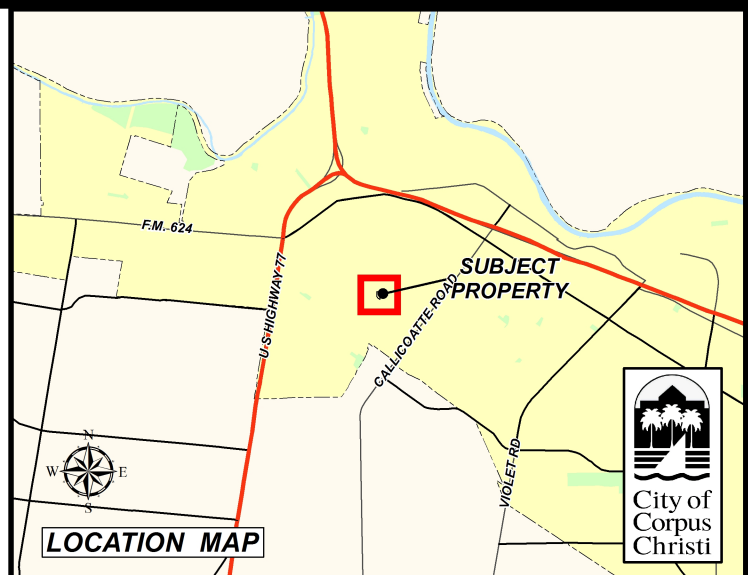

LOCATION MAP

