



Residential Street Rebuild Program (RSRP) Bond 2016 Rebuild Project Work Plan



Council Presentation
October 31, 2017



Bond 2016 - \$11.0M Residential Street Rebuild Project Presented to Council on February 28, 2017



Bond Ordinance language: "...for the purpose of making permanent public improvements or for other public purposes, to wit: **designing**, constructing, renovating, improving, constructing (sic), reconstructing, restructuring and extending streets and thoroughfares and related land and right-of-way (including pedestrian and bike traffic lanes), sidewalks, streetscapes, collectors, **drainage**, landscape, signage, lighting, traffic signals (including networking hardware and software), acquiring lands and rights-of-way necessary thereto or incidental therewith (but **specifically excluding related City utility costs**, which are the responsibility of the City's utility system),..."

Bond 2016 Project	\$ 11,000,000
Design, Mgmnt, Inspection, Administration, etc. (20%)	(\$ 2,200,000)
Construction	\$ 8,800,000



Apportion Funds By District

Presented to Council on February 28, 2017



	Square Yards						
District	Total Network	Residential/ Local	Res./Local PCI ≤ 55 "Current Need"	"Need" in Linear Miles	% of Total Need	SYs Worked†	Funding
1	5,191,722	2,803,734	1,471,697	105	23%	25,858	\$2,068,639
2	3,675,618	2,279,918	1,481,895	105	24%	26,037	\$2,082,973
3	3,262,808	2,009,174	1,099,588	78	18%	19,320	\$1,545,596
4	4,528,093	2,761,683	1,273,109	90	20%	22,369	\$1,789,500
5	3,696,021	2,308,838	934,318	66	15%	16,416	\$1,313,291
Total	20,354,262	12,163,348	6,260,607	445	100%	110,000*	\$8,800,000

†Based on \$80 / SY.

*Approximately 7.82 linear miles.



Representation of Work Quantity

Presented to Council on February 28, 2017



TYPICAL RESIDENTIAL STREET BLOCK SECTION

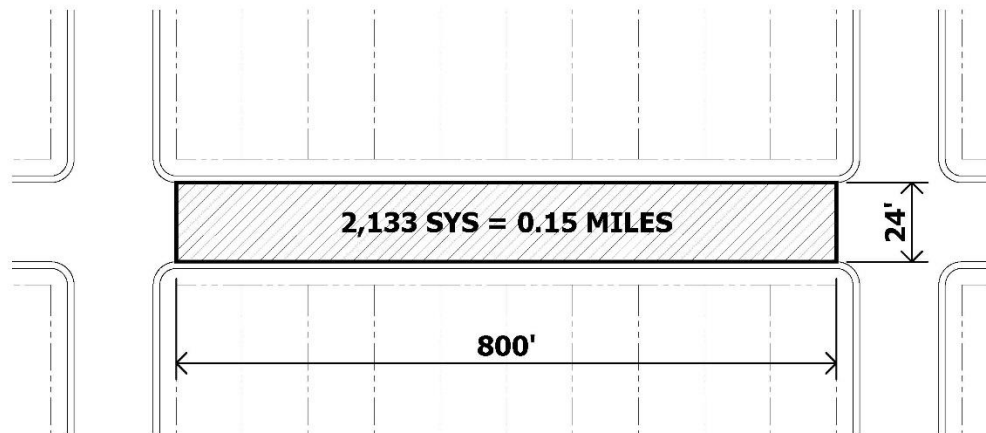

PAVEMENT QUANTITY

$(800 \times 24) \div 9 = \text{SQUARE YARDS (SYS)}$
2,133 = SYS
2,133 = 0.15 MILES

TYPICAL RESIDENTIAL BLOCK ≈ 0.15 MILES

110,000 SYS ≈ 7.82 MILES
 ≈ 52 TYPICAL RESIDENTIAL BLOCKS



Street Selection Steps

Presented to Council on February 28, 2017



➤ Mar. 21, 2017 – RSRP Guiding Principles approved (Resolution 031088)

Staff

- Select First on PCI score
- Identify Streets Removed From SPMP
- Distribute Based on District Need

A/E

- Perform Extensive Field Work
- Apply *Prioritization Criteria*
- Coordinate with Utilities
- Score Candidate Streets against *Matrix*
- Produce Final List for 2018 Work Plan



Residential Street Rebuild Program (RSRP) Work Plan Distribution



Target (% of Need)

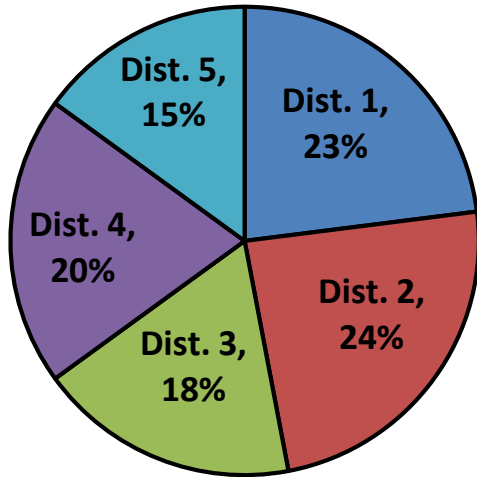

Work Plan

