

BEING A REPLAT OF THE N.W. 80' OF LOTS 7 & 8
AND ALL OF LOTS 45 & 46, BLOCK A, DON PATRICIO
AS RECORDED IN VOLUME 8 PAGE 30 (M.R.N.C.T.),
CORPUS CHRISTI, NUECES COUNTY, TEXAS

1. YARD REQUIREMENTS AS DEPICTED ARE A REQUIREMENT OF THE UNIFIED DEVELOPMENT CODE AND SUBJECT TO CHANGE, AS THE ZONING MAY CHANGE.

- STATE OF TEXAS
COUNTY OF NUECES

THIS THE _____ OF _____ 2018,

ISMAEL PENA
OWNER

STATE OF TEXAS
COUNTY OF NUECES

GIVEN UNDER MY HAND AND SEAL OF OFFICE, THIS THE _____ DAY OF _____ 2018.

NOTARY PUBLIC IN AND FOR NUECES CO., TEXAS

STATE OF TEXAS
COUNTY OF NUECES

THIS THE _____ OF _____ 2018

SEAL.

RONALD A. VOSS
REGISTERED PROFESSIONAL LAND SURVEYOR No. 2293

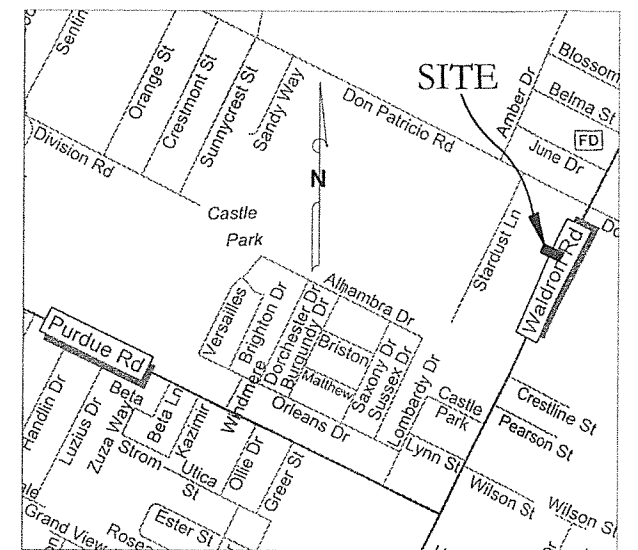

STATE OF TEXAS
COUNTY OF NUECES

THIS THE _____ DAY OF _____ 2018,

NINA NIXON-MENDEZ, FAICP, SECRETARY

ERIC VILLARREAL, P.E., CHAIRMAN

STATE OF TEXAS
COUNTY OF NUECES

THIS THE _____ DAY OF _____ 2018.

WILLIAM J. GREEN, P.E.
DEVELOPMENT SERVICES ENGINEER

STATE OF TEXAS
COUNTY OF NUECES

I, KARA SANDS, CLERK OF THE COUNTY COURT, IN AND FOR NUECES COUNTY TEXAS, HEREBY CERTIFY THAT THE FOREGOING INSTRUMENT DATED THE ____ DAY OF _____, 2018, WITH ITS CERTIFICATE OF AUTHENTICATION, WAS FILED FOR RECORD IN MY OFFICE THIS ____ DAY OF _____, 2018 AT ____ O'CLOCK ____ M AND DULY RECORDED IN VOLUME ____, PAGE ____ (M.R.N.C.T.)

WITNESS MY HAND AND SEAL OF OFFICE IN CORPUS CHRISTI, TEXAS, THIS THE ____ DAY OF _____ 2018.

KARA SANDS, COUNTY CLERK

DEPUTY TO THE COUNTY CLERK

ENGINEERING AND LAND SURVEYING
6838 GREENWOOD DRIVE, CORPUS CHRISTI, TEXAS 78415
PHONE: (361)854-6202 FAX: (361)853-4696

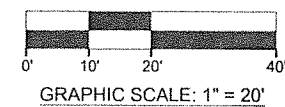

DATE:	REVISED:	OFFICE:	JOB #:
10/15/2018		RV & PP	18-3516
FIRM NO. F-166			