



The Salvation Army Center of Hope Family Services Center Request for Support



Type B Corporation
Board Presentation
December 9th, 2019



The Salvation Army is requesting \$500,000 in Type B Funds to be applied toward a new \$6.3 million facility that will provide transitional housing to individuals, families, and veterans



Type B Corporation
Board Presentation
December 9th, 2019



The Salvation Army Center of Hope



PERSPECTIVE - MAIN ENTRY

TR TURNER | RAMIREZ
ARCHITECTS



The Salvation Army Center of Hope



FLOOR PLAN

SCALE: 3/32"=1'-0"

TR TURNER | RAMIREZ
ARCHITECTS



The Salvation Army Center of Hope

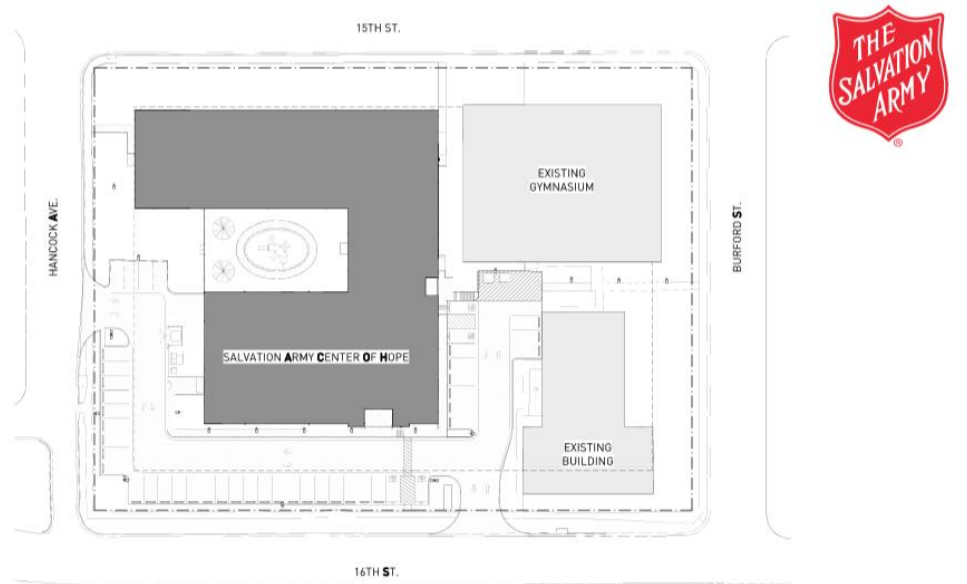

SITE PLAN

SCALE: 1" = 20'-0"

TR TURNER | RAMIREZ
ARCHITECTS



The Salvation Army Center of Hope





Project Budget



Project Budget 2019 Phase 1

Architect Fees	\$556,325
Construction	\$5,010,000
Equipment & Furnishings	\$176,773
Other Professional Fees	\$96,067
Commissioning Fee	\$12,500
Contingency	\$582,075
Interim Financing	\$179,489
Total Project Costs	\$6,613,229

Construction Budget Breakdown

	Construction Budget	Type B Fund
Construction	\$4,230,000.00	\$250,000.00
Demolition	\$110,000.00	
Paving	\$210,000.00	\$150,000.00
Landscaping	\$45,000.00	
Sitework	\$415,000.00	\$100,000.00
	\$5,010,000.00	\$500,000.00





The Salvation Army Center of Hope



Salvation Army's Programs

- Coordinated Entry
- Family Re-Unification
- Emergency Shelter
- Rapid ReHousing
- Transitional Housing
- Permanent Supportive Housing
- Street Outreach
- TAMUCC Clinic
- Food Services
- Life Skills
- After School Tutoring



The Salvation Army Center of Hope



Current Facility: Josephine Street

- 16,000 sq. ft facilities, 3 separate buildings
- 120 bed capacity
- 20 Family Rooms
- 10 Veteran's Bunks
- 5 Veteran's Rooms
- 40 Single Emergency Shelter Beds
- Dining Hall
- Computer Lab
- Playground
- Veteran's Lounge
- Social Services and Administrative Offices

New Facility: Center of Hope

- 30,000 sq. ft. facility
- 192 bed capacity
- 30 Family Rooms
- 12 Veteran's Bunks
- 3 Veteran's Rooms
- 60 Single Emergency Shelter Beds
- Dining Hall
- Nurses Clinic
- Computer Lab
- Playground and library
- Veteran's and Family Lounge
- Social Services and Administrative Offices