

- NOTES
1. THE RECEIVING WATER FOR THE STORM WATER RUNOFF FROM THIS PROPERTY IS THE OSO CREEK. THE TCEQ HAS NOT CLASSIFIED THE AQUATIC LIFE USE FOR THE OSO CREEK, BUT IT IS RECOGNIZED AS AN ENVIRONMENTALLY SENSITIVE AREA. THE OSO CREEK FLOWS DIRECTLY INTO THE OSO BAY. THE TCEQ HAS CLASSIFIED THE AQUATIC LIFE USE FOR THE OSO BAY AS "EXCEPTIONAL" AND "OYSTER WATERS" AND CATEGORIZED THE RECEIVING WATER AS "CONTACT RECREATION" USE.
  2. THE BASIS OF BEARINGS IS THE STATE OF TEXAS LAMBERT GRID, SOUTH ZONE, NAD 1983.
  3. THE SUBJECT SITE IS IN ZONE "X" ACCORDING TO FEMA MAP 48355C0315G (10/23/15).
  4. THERE ARE NO KNOWN NATURAL WATER BODIES, JURISDICTIONAL WETLANDS, ENDANGERED SPECIES HABITAT, STATE SUBMERGED LANDS OR CRITICAL DUNES ON THE SITE.
  5. THE TOTAL PLATTED AREA CONTAINS 5.749 ACRES OF LAND (NO STREET DEDICATIONS).
  6. THE YARD REQUIREMENT IS SUBJECT TO CHANGE AS THE ZONING MAY CHANGE.
  7. SET 5/8" IRON RODS AT ALL LOT CORNERS UNLESS SHOWN OTHERWISE. ALL SET IRON RODS CONTAIN PLASTIC CAPS LABELED BASS AND WELSH ENGINEERING.
  8. ALL DRIVEWAYS SHALL CONFORM TO ACCESS MANAGEMENT STANDARDS OUTLINED IN ARTICLE 7 OF THE UDC.

STATE OF TEXAS           §  
COUNTY OF NUECES       §

WE, TRANSPORT ENTERPRISES, LTD., HEREBY CERTIFY THAT WE ARE THE OWNERS OF THE LAND EMBRACED WITHIN THE BOUNDARIES OF THE FOREGOING PLAT AND THAT THIS PLAT WAS MADE FOR THE PURPOSES OF DESCRIPTION AND DEDICATION.

THIS THE \_\_\_\_ DAY OF \_\_\_\_\_, 20\_\_\_\_,

TRANSPORT ENTERPRISES, LTD

BY: TRANSPORT INDUSTRIAL PROPERTIES, L.L.C.,  
GENERAL PARTNER

BY: \_\_\_\_\_  
MARK D. STOCKSETH, PRESIDENT

STATE OF TEXAS           §  
COUNTY OF NUECES       §

THIS INSTRUMENT WAS ACKNOWLEDGED BEFORE ME BY MARK D. STOCKSETH AS PRESIDENT OF OF TRANSPORT INDUSTRIAL PROPERTIES, L.L.C.

THIS THE \_\_\_\_ DAY OF \_\_\_\_\_, 20\_\_\_\_,

\_\_\_\_\_  
NOTARY PUBLIC IN AND FOR  
THE STATE OF TEXAS

STATE OF TEXAS           §  
COUNTY OF NUECES       §

I, NIXON M. WELSH, REGISTERED PROFESSIONAL LAND SURVEYOR OF BASS & WELSH ENGINEERING, HEREBY CERTIFY THAT THE FOREGOING PLAT WAS PREPARED FROM A SURVEY MADE ON THE GROUND UNDER MY DIRECTION.

THIS THE \_\_\_\_ DAY OF \_\_\_\_\_, 20\_\_\_\_,

\_\_\_\_\_  
NIXON M. WELSH, R.P.L.S.

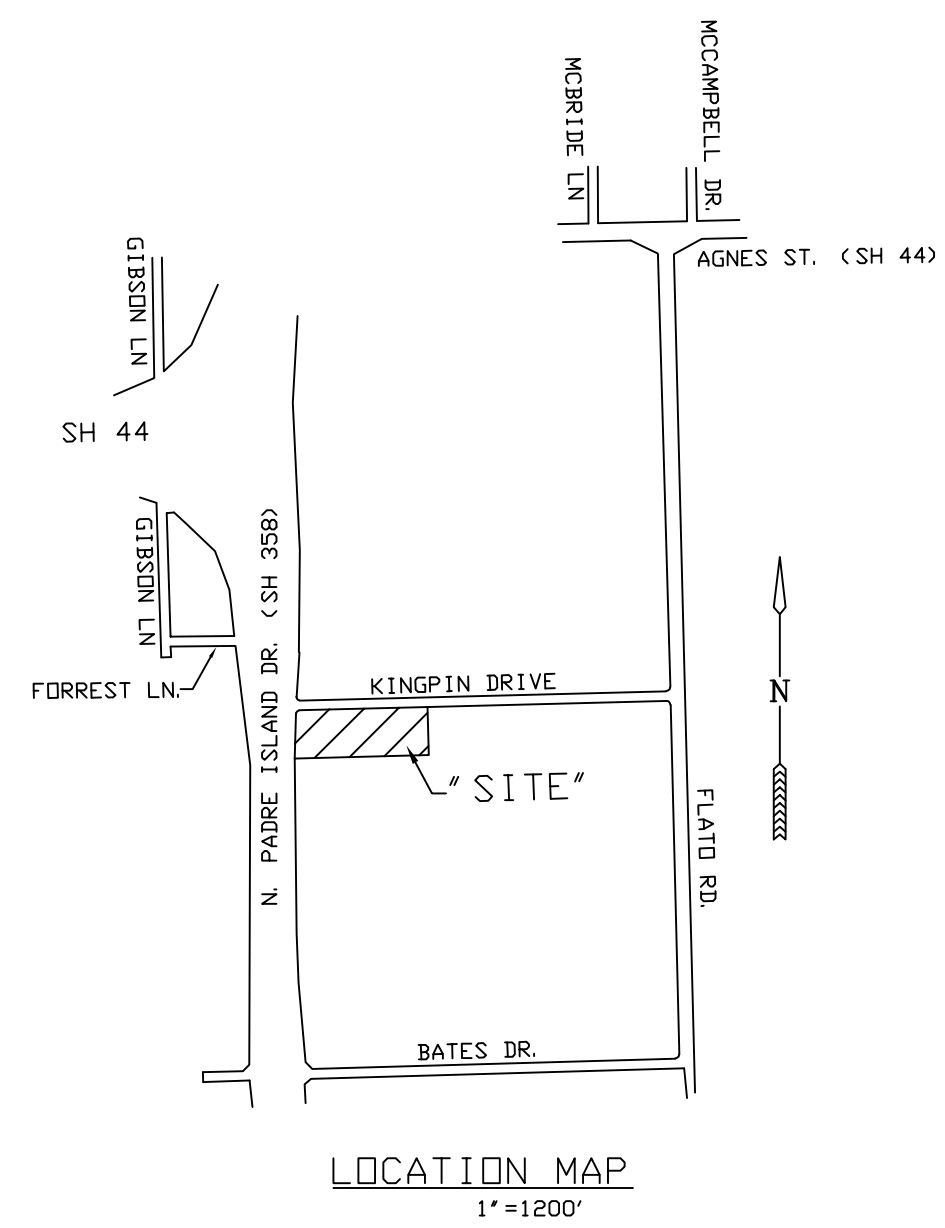

STATE OF TEXAS           §  
COUNTY OF NUECES       §

THE FINAL PLAT OF THE HEREIN DESCRIBED PROPERTY WAS APPROVED BY THE DEPARTMENT OF DEVELOPMENT SERVICES OF THE CITY OF CORPUS CHRISTI, TEXAS

\_\_\_\_\_  
JALAL SALEH, P.E.  
DEVELOPMENT SERVICES ENGINEER

\_\_\_\_\_  
DATE

STATE OF TEXAS           §  
COUNTY OF NUECES       §

THE FINAL PLAT OF THE HEREIN DESCRIBED PROPERTY WAS APPROVED ON BEHALF OF THE CITY OF CORPUS CHRISTI, TEXAS, BY THE PLANNING COMMISSION.

THIS THE \_\_\_\_ DAY OF \_\_\_\_\_, 20\_\_\_\_,

\_\_\_\_\_  
JEREMY BAUGH  
CHAIRMAN

\_\_\_\_\_  
AL RAYMOND III, AIA  
SECRETARY

STATE OF TEXAS           §  
COUNTY OF NUECES       §

I, KARA SANDS, CLERK OF THE COUNTY COURT IN AND FOR SAID COUNTY, DO HEREBY CERTIFY THAT THE FOREGOING INSTRUMENT DATED THE \_\_\_\_ DAY OF \_\_\_\_\_, 20\_\_\_\_ WITH ITS CERTIFICATE OF AUTHENTICATION, WAS FILED FOR RECORD IN MY OFFICE THE \_\_\_\_ DAY OF \_\_\_\_\_, 20\_\_\_\_ AT \_\_\_\_ O'CLOCK \_\_\_\_\_.M., AND DULY RECORDED THE \_\_\_\_ DAY OF \_\_\_\_\_, 20\_\_\_\_ AT \_\_\_\_ O'CLOCK \_\_\_\_\_.M. IN THE MAP RECORDS OF SAID COUNTY IN VOLUME \_\_\_\_, PAGE \_\_\_\_, INSTRUMENT NUMBER \_\_\_\_\_. WITNESS MY HAND AND SEAL OF THE COUNTY COURT IN AND FOR SAID COUNTY AT OFFICE IN CORPUS CHRISTI, NUECES COUNTY, TEXAS, THE DAY AND YEAR LAST WRITTEN.

BY: \_\_\_\_\_

DEPUTY

\_\_\_\_\_  
KARA SANDS, COUNTY CLERK  
NUECES COUNTY, TEXAS

PLAT OF  
ROBLEX INDUSTRIAL SUBDIVISION UNIT 3,  
BLOCK 2, LOTS 1 & 2  
A 5.749 ACRE TRACT OF LAND, MORE OR LESS, A PORTION OF J. C. RUSSELL FARM BLOCKS, BLOCK 5, LOT 1, A MAP OF WHICH IS RECORDED IN VOLUME 28, PAGES 58 & 59, MAP RECORDS, NUECES COUNTY, TX  
CORPUS CHRISTI, NUECES CO., TX

BASS & WELSH ENGINEERING  
TX SURVEY REG. NO. 100027-00, TX ENGINEERING REG.  
NO. F-52, 3054 S. ALAMEDA STREET  
CORPUS CHRISTI, TEXAS 78404

DATE PLOTTED: 12/14/20  
FILE: PLAT  
JOB NO. 20042  
SCALE: 1"=100'  
PLOT SCALE: SAME  
SHEET 1 OF 1