

# Capital Improvement Plan

## City of Corpus Christi, Texas

2020 *thru* 2024

**Project #** 21086A  
**Project Name** Police training academy design

**Type** Improvement/Additions  
**Useful Life** 40 years  
**Category** Building Addition

**Department** Police Department  
**Contact** Police Chief  
**Priority** 7 --Future Consideration

**Status** Active

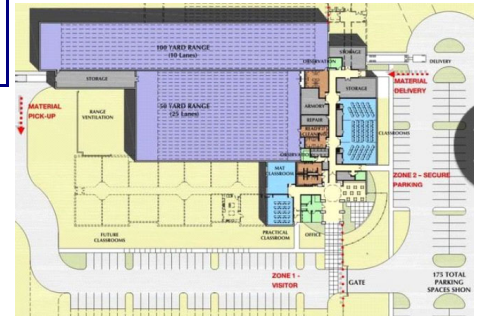

### Description

The current Police academy building is over 30 years old and is obsolete in both space and needed training amenities. This project is for design only and will be the first steps in the project to design and construct a new Police Training Academy. The new facility is estimated to be 24,000 to 27,000 sq feet and will include all the needed space such as large training classrooms, resource room, library, physical training spaces and running track as well as administrative offices and adequate parking. The location objective is Del Mar College South Campus, this partnership will offer costs savings and can be used as a Regional Police Academy. The diagram attached is a rough draft of the new design the CCPD is considering.

### Justification

The current police academy building is over 30 years old and has no room for expansion. Current cadet academies are limited to 30 cadets due to lack of space and parking. The current facility is 8,160 sq feet and is used for classroom training only. An old warehouse is used as the physical fitness training area. CCPD must lease needed parking space for the current academy and must rent portable restrooms and hand wash stations. These costs are currently included in the police's operating budget. The replacement of the old police training academy is evident and will serve the growing needs of Corpus Christi Police Department as the enrollment in the academy has increased over 60% in the last 15 years. Additional cost savings will be seen as the location at Del Mar College South Campus allows the new academy to be used as Regional Police Academy with usage revenue from other entities.

Expenditures	2020	2021	2022	2023	2024	Total
Design		1,100,000				1,100,000
Contingency		130,000				130,000
Engineering Svc		12,000				12,000
Admin Reimbursement		8,000				8,000
<b>Total</b>		<b>1,250,000</b>				<b>1,250,000</b>

Funding Sources	2020	2021	2022	2023	2024	Total
G.O.Bond 2020		1,250,000				1,250,000
<b>Total</b>		<b>1,250,000</b>				<b>1,250,000</b>

### Budget Impact/Other

There is no projected operational impact with this project at this time. Once the design and construction phases have been completed a reassessment will made of on-going and maintenance costs; as well as estimated revenue from regional usage fees..