

PLAT OF: DRILLEN SUBDIVISION

BEING A PLAT OF A 9.59 ACRE TRACT OF LAND DEEDED BUTCH DRILLEN AND MARGARET R. DRILLEN, IN
DOCUMENT FILE No. 92400 WARRANTY DEED RECORDS NUECES COUNTY, TEXAS.

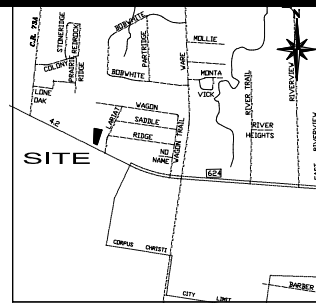

STATE OF TEXAS
COUNTY OF NUECES

We, BUTCH DRILLEN & MARGARET R. DRILLEN, hereby certify that we own the property embraced within the boundaries of the foregoing plat; that we have surveyed and subdivided as shown; that easements as shown are dedicated to the public use for the installation, operation and use of public utilities; and that this map was made for the purpose of description and dedication.

This the _____ day of _____ 2021.

BUTCH DRILLEN - CO-OWNER

MARGARET R. DRILLEN - CO-OWNER

STATE OF TEXAS
COUNTY OF NUECES

This instrument was acknowledged before me
by BUTCH DRILLEN AND MARGARET R. DRILLEN

This the _____ day of _____ 2021.

Notary Public, in and for the State of Texas

STATE OF TEXAS
COUNTY OF NUECES

Approved by the Corpus Christi-Nueces County Health Department, this the _____ day of _____, 2021. Any Private Water Supply and/or sewage shall be approved by the Corpus Christi-Nueces County Health Department prior to installation.

Public Health Engineer

STATE OF TEXAS
COUNTY OF NUECES

I, JARREL L. MOORE, A REGISTERED PROFESSIONAL LAND SURVEYOR HEREBY CERTIFY THAT THE FOREGOING PLAT WAS PREPARED FROM A SURVEY MADE ON THE GROUND UNDER MY DIRECTION AND IS TRUE AND CORRECT; THAT I HAVE BEEN ENGAGED UNDER CONTRACT TO SET ALL LOT AND BLOCK CORNERS AND COMPLETE SUCH OPERATIONS WITHOUT DELAY.

THIS THE XXTH DAY OF XXXXXXXX 2021.

JARREL L. MOORE
REGISTERED PROFESSIONAL LAND SURVEYOR
LICENSE NO. 4854

TEXAS GEO TECH
LAND SURVEYING, INC.

5525 South Staples St., Suite B-2
Corpus Christi, TX 78411
P: (361)993-0808 F: (361)993-2955
TGT Job No: 170202

GENERAL NOTES:

- 1) THE TOTAL PLATTED AREA CONTAINS 9.59 ACRES OF LAND INCLUDING STREET DEDICATION.
- 2) A 5/8" DIAMETER STEEL REBAR WAS FOUND AT EVERY CORNER, EXCEPT OTHERWISE SPECIFIED.
- 3) PER FLOOD INSURANCE RATE MAP, MAP INDEX, COMMUNITY-PANEL NUMBER 485464 0256 C, MAP REVISED MARCH 18, 1985, THE SUBJECT PROPERTY IS LOCATED IN ZONE C, DEFINED AS AREA OF MINIMAL FLOODING. THIS FLOOD STATEMENT SHALL NOT CREATE LIABILITY ON THE PART OF THE SURVEYOR.
- 4) ALL BEARINGS AND DISTANCES REFER TO THE TEXAS STATE PLANE COORDINATE SYSTEM OF 1983, TEXAS SOUTH ZONE.
- 5) THE RECEIVING WATER FOR THE STORM WATER RUNOFF FROM THIS PROPERTY IS THE NUECES RIVER UPSTREAM OF THE CALLEEN SALTWATER INTRUSION DRY LOCATED 1.1 MILES FROM NUECES BAY. THE TCEQ HAS CLASSIFIED THE AQUATIC LIFE USE FOR THIS SEGMENT OF THE NUECES RIVER AS "HIGH". TCEQ ALSO CATEGORIZED THE NUECES RIVER AS "CONTACT RECREATION" USE. ADDITIONAL WATER QUALITY PROTECTION MEASURES MUST BE OBSERVED FOR THIS RECEIVING WATER DUE TO THE TCEQ DESIGNATION AS A "PUBLIC WATER SUPPLY."
- 6) THE YARD REQUIREMENT, AS DEPICTED, IS A REQUIREMENT OF THE UNIFIED DEVELOPMENT CODE AND IS SUBJECT TO CHANGE AS THE ZONING MAY CHANGE.
- 7) THE TWO LOTS WILL SHARE ACCESS TO THE NORTHWEST BOULEVARD.
- 8) ONLY ONE SINGLE FAMILY DWELLING PER LOT.
- 9) SUBDIVIDER SHALL PROVIDE WATER AND SEPTIC TO EACH LOT.
- 10) PUBLIC WATER SHALL BE PROVIDED BY RIVER ACRES WATER SUPPLY.
- 11) SEPTIC SYSTEM SHALL BE APPROVED BY CITY/COUNTY HEALTH DEPARTMENT.
- 12) LOTS SHALL NOT BE FURTHER SUBDIVIDED.
- 13) MINIMUM FINISHED FLOOR ELEVATION SHALL BE 12" OR HIGHER ABOVE F.M. 624.

STATE OF TEXAS
COUNTY OF NUECES

THIS FINAL PLAT OF THE HEREIN DESCRIBED PROPERTY WAS APPROVED ON BEHALF OF THE CITY OF CORPUS CHRISTI, TEXAS PLANNING COMMISSION.

THIS THE _____ DAY OF _____ 2021.

JEREMY BAUGH
CHAIRMAN

AL RAYMOND III AIA
DIRECTOR

STATE OF TEXAS
COUNTY OF NUECES

THIS FINAL PLAT OF THE HEREIN DESCRIBED PROPERTY WAS APPROVED BY THE DEVELOPMENT SERVICES ENGINEER OF THE CITY OF CORPUS CHRISTI, TEXAS.

THIS THE _____ DAY OF _____ 2021.

BRETT FLINT, P.E.
DEVELOPMENT SERVICES ENGINEER

STATE OF TEXAS
COUNTY OF NUECES

I, KARA SANDS, CLERK OF THE COUNTY COURT IN AND FOR NUECES COUNTY, TEXAS, DO HEREBY CERTIFY THAT THE FOREGOING INSTRUMENT DATED THE _____ DAY OF _____, 2021, WITH ITS CERTIFICATE OF AUTHENTICATION WAS FILED FOR RECORD IN MY OFFICE THE _____ DAY OF _____, 2021, AT _____ O'CLOCK _____ M. AND DULY RECORDED THE _____ DAY OF _____, 2021, AT _____ O'CLOCK _____ M. IN VOLUME _____, PAGE _____, MAP RECORDS NUECES COUNTY, TEXAS.

KARA SANDS, COUNTY CLERK
NUECES COUNTY, TEXAS

AT _____ O'CLOCK _____ M.

_____, 2021

BY: _____ DEPUTY

